



## PRODUCT SPECIFICATION

### KAREENA C/C PAN, CISTERN & SEAT

ILLUSTRATION: KAREENA C/C PAN & CISTERN



CODE: C/C WC PAN - POT405SI  
C/C CISTERN - POT401SI  
SOFT CLOSE SEAT - POT402SI

COLOUR: WHITE

WEIGHT:	WC PAN	CISTERN	SEAT
NET:	35.00 KG	14 KG	1.4 KG
GROSS:	36.5 KG	15 KG	1.6 KG

STANDARDS: BS EN 997 WCs

BS EN 14055:2010 FLUSHING CISTERNS

BS 3402



NOTES:

VITREOUS CHINA

WATER SAVING 6/4 LITRE FLUSH

SOFT CLOSE SEAT WITH QUICK RELEASE TOP FIX HINGE

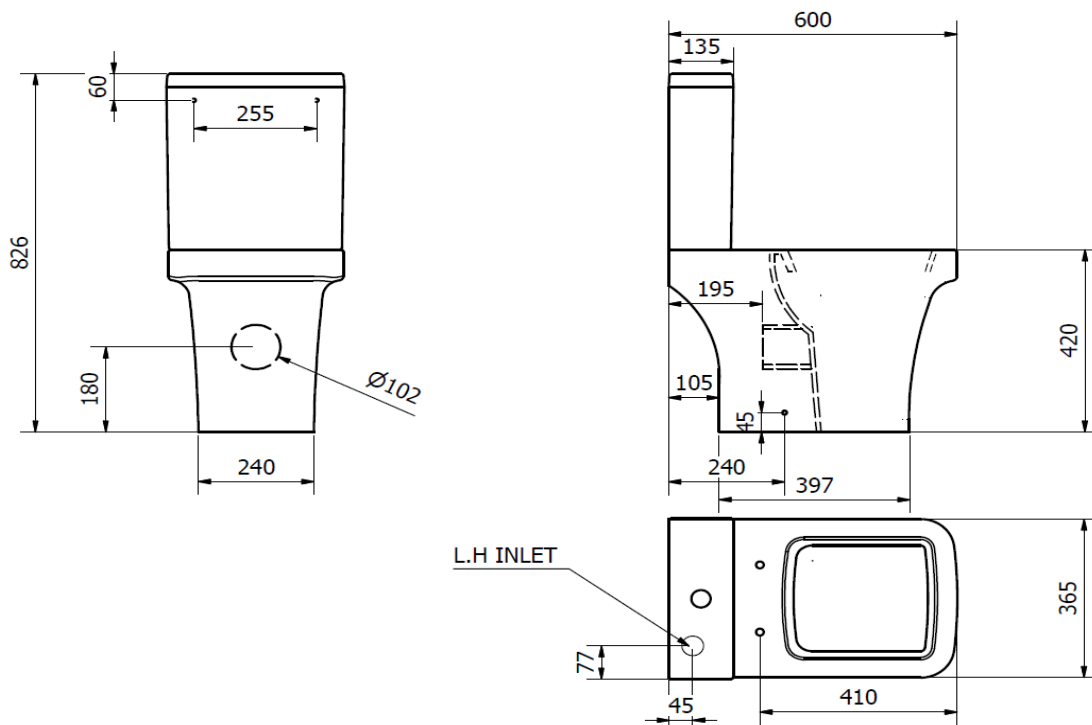

BOX SIZES :- WC PAN = 400 X 450 X 600 mm / CISTERN = 160 X 400 X 450 mm