



# Yorkshire

## Street elbow, female copper x male copper for insertion into fitting

YP12S Elbow



Size	Pattern No.	Pack 1 Qty	Pack 2 Qty	Code	Barcode	Price (£) ex VAT
10mm	YP12S	10	350	08316	5022050083166	£10.07
15mm	YPS12S	10	200	08318	5022050083180	£2.55
22mm	YP12S	25	200	08320	5022050083203	£7.64
28mm	YP12S	10	40	08322	5022050083227	£22.31
35mm	YP12S	1	30	08324	5022050083241	£51.92
42mm	YP12S	1	16	08325	5022050083258	£73.07

YP12S Elbow

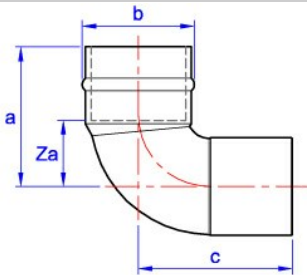

Code	a	b	c	Za
08316	23	13	44	12
08318	29	19	35	14
08320	43	27	45	22
08322	40	32	44	19
08324	50	40	52	23
08325	58	49	65	26

*Pegler Yorkshire reserve the right to change specifications*

### Pegler Yorkshire 25 Year Guarantee - Terms and Conditions

Products are subject to a 25 year guarantee that is between Pegler Yorkshire and the final purchaser of the product.

The guarantee is subject to proof of purchase being supplied.

This guarantee does not affect any statutory rights the consumer may have in law.

The guarantee covers manufacturing or material defects when installed in accordance with our instructions on specified tube materials and applications, and does not cover parts subject to normal wear and tear.

This product range has been designed for the use of homeowners, domestic and commercial applications and therefore the Guarantee is subject to the product being properly selected for their intended service conditions.

The guarantee is not applicable where the product is fitted contrary to the conditions in the fitting instructions.

This is reinforced where valves are covered by the European Pressure Equipment Directive (PED97/23/EC) where Installation, Operating and Maintenance Instructions are supplied with each product and/or carton.

Provided it is installed correctly and receives adequate preventative maintenance it should give years of trouble-free service.

Abusive behaviour and accidental damage to the product are not covered by this guarantee.

The extent of this liability is limited to the cost of the replacement of the defective item and not to installation or consequential damages.

Size	-40°C (Min)	30°C	65°C	110°C (Max)
6mm to 54mm	16 bar	16 bar	10 bar	6 bar
67mm	10 bar	10 bar	6 bar	4 bar

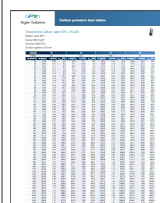

### Pressure Loss Tables: Copper Water

### Pressure Loss Tables: Copper Compressed Air

### Pressure Loss Tables: Copper Gas

#### **Care**

No regular aesthetic care is required for this product

#### **Maintenance**

No regular maintenance is required for this product.

For any further help please contact the Service Support Team on: 0800 1560050.

#### 59 Nipple (Groove x Thread)



# Solder ring solutions

## Yorkshire general range installation instructions

The following instructions illustrate just how easy it is to make a Yorkshire integral solder ring joint. The fittings use the principle of capillary action to allow solder to fill the gap between fitting and tube to form a completely reliable joint. These instructions cover Yorkshire general range fittings. Details of how to joint General High Duty fittings can be found on page 3.

### Installation tips

Best results are obtained when joints are heated as soon as possible after assembly. After heating and subsequent cooling, flush the system – preferably with hot water. Ensure adequate ventilation during heating. Any joints not heated during the working day should be dismantled, cleaned and refluxed prior to reassembly.

### Preliminaries

Select the correct size of tube and fitting for the job. Ensure that both are clean, in good condition and free from damage and imperfections. If the tube is oval or damaged use a re-rounding tool.

### Preparation

**1.** Cut the tube square using a rotary tube cutter wherever possible. If a hacksaw is used to cut the tube, a fine toothed blade should be used.

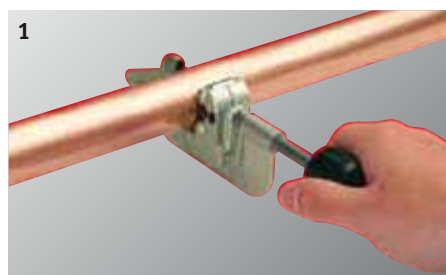

**2.** Remove any burr from the inside and outside of the tube ends using a fine toothed file or a S120 de-burring tool from the XPress accessories range.



**3.** Clean the inside of the fitting socket and the outside of the tube with a Yorkshire cleaning pad, fine sandpaper or steel wool.



### Joining

**1.** Using a suitable brush, apply adequate – but not excessive – flux to both the outside surface of the tube and the inside surface of the fitting socket. Do not use your finger.

The reliability of soldered joints is greatly influenced by the type of flux used. Yorkshire flux and Traditional Craftsman's flux are specially formulated for jointing copper tubes with Yorkshire integral solder ring fittings. All fluxes are, to some extent, corrosive, but special care should be taken with so-called self cleaning fluxes. Yorkshire flux is not suitable for gas applications.



**2.** Insert the tube into the fitting until it reaches the tube stop, then wipe off any excess flux. Heat the assembled joint until a complete ring of solder appears at the mouth of the fitting.

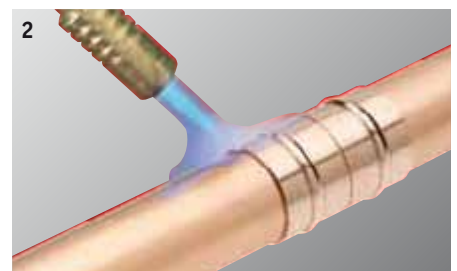

**3.** Allow the joint to cool without disturbance. Clean the joint generally, wiping off any external flux residues. This will prevent unsightly stains or (in extreme cases) corrosion of pipework. Flush out the pipework.

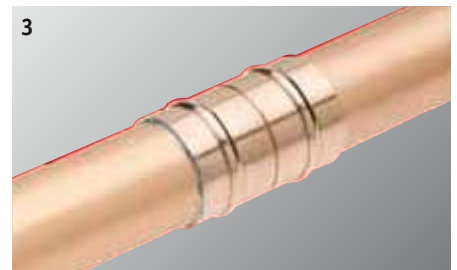

### Threaded connectors

A good quality jointing washer should be used when installing fittings with parallel connector threads. Male threaded connectors for jointing pipework to boilers, pumps or backplate elbows have taper male BSP threads and may require the use of jointing materials. A small quantity of inert jointing compound or PTFE tape should be applied to the male thread before installing the fittings.

Female threaded connectors have internal threads to BS EN ISO 228:2003 and should be used for general connections from male threaded fittings to copper pipework.

Jointing compounds should comply with BS 6956 Part 5 and be WRAS listed. PTFE tape for water and general applications should comply with BS 7786 and satisfy

# Solder ring solutions

## Chrome plated installation instructions

the requirements of BS 6920 Part 1. For gas applications, PTFE tape should comply with BS EN 751-3:1997 (formerly BS 6974).

### Stopvalves

During the soldering operation, stopvalves should be half open and a damp cloth wrapped around the headwork. The headwork of stopvalves are bonded and sealed to provide maximum reliability.

### Slip couplings and tees

If it is necessary to break into existing pipes for repairs or to fit new branches, slip couplings or tees which have no tube stops make the job easier and avoid disturbing the rest of the system.

### Adapting imperial to metric with Yorkshire

Occasionally a Yorkshire integral solder ring fitting may need to be connected to an older installation where imperial sized copper tube has been used. If this is the case, simply use a Yorkshire imperial to metric coupling adaptor, one end of which fits on to imperial pipe, and the other on to metric pipe. Adaptors are available in several combinations.

### Unmade ends

If an end of a Yorkshire general range fitting is to remain unmade, a short length of correctly sized, uncleaned tube should be inserted into the end(s) to be left unjointed. This section should be kept cool by wrapping a wet rag around it whilst heating the remaining ends.

### Taking apart and remaking Yorkshire joints

The re-use of Yorkshire integral solder ring fittings is generally not recommended, as the joints are difficult to disconnect owing to the intermetallic bonding between the solder and the copper of the fitting and tube. However, in some situations, joints can be remade by fluxing the tinned portion of the tube and reinserting this into the fitting. The joint can then be heated and lead-free solder end-fed. If a new tube is to be used, clean and flux the tube before assembly. End feed lead-free solder at the mouth of the socket after reheating.

### Using Yorkshire general range fittings with chrome plated copper tube

Solder will not bond to chrome plate, meaning the plating needs to be removed from copper tube before a joint is made. The same preliminaries and preparation guidelines apply.

1. For the distance the tube goes into the fitting, remove the chrome plating using a coarse emery cloth, followed by fine sandpaper or Yorkshire cleaning pad.



2. After applying flux, heat the joint in the usual manner.

3. Remove any discolouration of the chromium by washing the fitting with soap and warm water immediately after the joint has cooled.

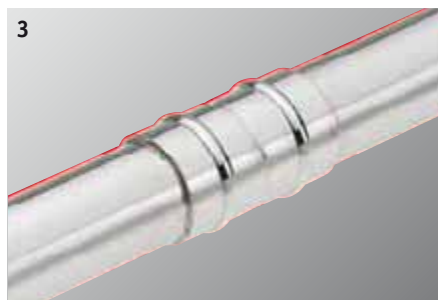

### Local water authority

It's wise to take the advice of the Local Water Authority into account when it comes to pipework accessibility.

### Union fittings

Yorkshire union fittings have metal-to-metal cone joints. To avoid leaks, care should be taken to protect the jointing faces from damage. Use a WRAS listed jointing compound or apply a sufficient amount of PTFE tape to obtain completely satisfactory results. Tighten the joint with a spanner.

### System testing

We recommend all systems are thoroughly tested upon completion. In hydraulic based installations the system may be tested to 1.5 times the working pressure of the system (see tables on page 48 for data). If higher test pressures are required advice should be sought from Pegler Yorkshire.

On completion, compressed air pipeline systems must be properly tested. The system designer and installation contractor must ensure safe methods are selected for system testing which will comply with all current Health and Safety regulations.

This may include testing compressed air lines with fluids or compressed air at a limited pressure, or a combination. In any event we do not recommend the maximum working pressure of the product be exceeded during this procedure.

N.B. The maximum temperature and pressure range in any system is dictated by the component with the lowest performance rating.

# Solder ring solutions

## General High Duty installation instructions

### Making a Yorkshire General High Duty joint

The same preliminaries apply as for Yorkshire general range fittings.

### Preparation

The preparation of Yorkshire General High Duty fittings differs only slightly to those for Yorkshire general range fittings. Details of these differences are as follows:

1. A hacksaw should be used to cut the tube – a rotary cutter must not be used for this application as it can reduce the diameter of the tube ends.
2. An alumina based paper or cloth can also be used to clean the fitting socket as an alternative to a Yorkshire cleaning pad or fine sandpaper. Steel wool should not be used.
3. General High Duty fittings require the use of the correct flux. We recommend Degussa "H" ready mixed paste, although satisfactory joints can be made using other suitable silver brazing alloy fluxes.

Silver brazing alloy fluxes must be used with care and always in a well ventilated area.

If powder flux is used, this should be mixed with clean water and blended into a creamy paste. Mix the required amount of flux and keep the powder in the container dry, replacing the lid immediately after use. Any excess mixed flux should be discarded.

### Jointing

1. Using a suitable brush, apply adequate – but not excessive – flux to both the outside surface of the tube to a length slightly greater than the socket depth and the inside surface of the fitting socket. Do not use your finger.



2. Insert the tube into the fitting until it reaches the tube stop, using a twisting action to ensure the spread of flux. Ensure the tubes are correctly lined up and adequately supported – otherwise distortion or cracking may occur when at brazing temperature.

3. Heat the socket and tube gently using an oxy/gas, oxy/acetylene or oxy/propane torch to approximately 700°C – a visible red heat in poor daylight. Use a large, soft, neutral or slightly reducing flame, keep the torch moving, and continue heating until a complete ring of solder appears around the socket mouth - this is proof of a sound joint. Continue to heat generally for a few seconds. Repeat this method for each joint in turn.

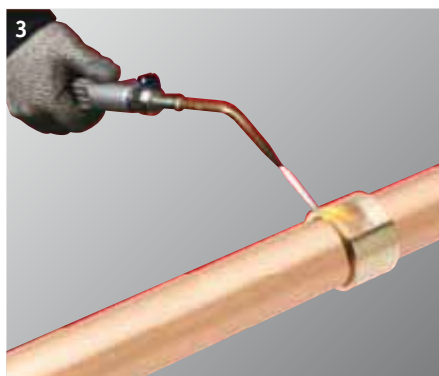

If the complete ring of solder does not appear on heating, apply additional flux to the mouth of the socket and end feed the joint with our N165 (Copper coloured) or N166 (Brass coloured) cadmium-free silver brazing alloy, or an equivalent to the compositional requirements of BS EN 1044 AG103 (formerly BS 1845 AG14).

4. Allow the joint to cool without disturbance. Clean the joint generally, wiping off any external flux residues. Flush out the pipework.

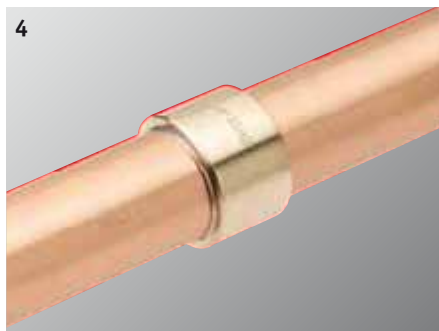

### Permanence of GHD joints

Joints made with Yorkshire General High Duty fittings should be regarded as permanent. If the system has to be broken into, fittings such as the 11GHD union coupling should be installed at appropriate points. An alternative is the use of bi-metal Endbrazed flanges, in sizes 42mm and 54mm, which will require the end-feeding of solder.

### Disconnecting GHD fittings

The use of disconnecting fittings allows sections of the installation to be completed on the workbench, avoiding the need to make joints in difficult places. This prefabrication technique is particularly recommended in sizes from 22mm to 54mm.

### GHD union fittings

Union type fittings such as 11GHD, 65GHD and 69GHD have round nose-to-seal joints.

### Imperial to metric

Where the layout permits, the most economical way of adapting from imperial to metric is to use the 9GHD.

# Kitemark™ Certificate

This is to certify that:

Pegler Yorkshire Group Limited  
Belmont Works  
St. Catherines Avenue  
Doncaster  
DN4 8DF  
United Kingdom

Holds Certificate Number:

KM 15121

In respect of:

**BS EN 1254 / BS 864 Part 2**  
**Copper and copper alloys - Plumbing fittings**

This issues the right and licence to use the Kitemark in accordance with the Kitemark Terms and Conditions governing the use of the Kitemark, as may be updated from time to time by BSI Assurance UK Ltd (the "Conditions"). All defined terms in this Certificate shall have the same meaning as in the Conditions.

The use of the Kitemark is authorized in respect of the Product(s) detailed on this Certificate provided at or from the above address.

For and on behalf of BSI:

Gary Fenton, Global Product Certification Director

First Issued: 1945-10-02

Latest Issue: 2017-09-11



# Kitemark™ Certificate

No. KM 15121

## BS EN 1254 COPPER AND COPPER ALLOYS – COPPER FITTINGS

**BS EN 1254-1:1998 – Capillary ends.**

**BS EN 1254-4:1998 – Other ends.**

**Note. With the exception of marking, the products listed are also deemed to conform with the requirement of the obsolescent British Standard BS 864 Part 2.**

Reference Number	Description	Size	Production site	
			France	Budapest
YP1 IM	Adaptor Coupling	1/2" x 15, to 1.1/2" x 42		•
YP1	Straight Coupling	6 to 28	•	
		35 to 67		•
YP1R	Reducing Coupling	8 x 6 to 15 x 10	•	
		42 x 28 to 54 x 28		•
YP1s	Straight Coupling, Slip Pattern	15, 22, 28	•	
YP1FD	Flanged Connector	28	•	
		35 to 67		•
YP2	Straight Female Connector	8 x 1/4" to 28 x 1"	•	
		35 x 1 1/4" to 54 x 2"		•
YP2LC	Female Reducing Connector	12 x 1/4" to 22 x 1/2"	•	
YP2LI	Female Reducing Connector	12 x 1/2" to 22 x 1"	•	
YP3	Straight Male Connector	6 x 1/8" to 28 x 1"	•	
		35 x 1 1/4" to 67 x 2.1/2"		•
YP3 LC	Reducing Male Connector	10 x 1/4" to 28 x 3/4"	•	
YP3LI	Reducing Male Connector	6 x 1/4" to 22 x 1"	•	
YP4	Connector	15 to 28	•	
TE4	Brass Tube End	15 to 28	•	

First Issued: 1945-10-02

Latest Issue: 2017-09-11

Page: 2 of 52

This certificate has been issued by and remains the property of BSI Assurance UK Ltd, Kitemark Court, Davy Avenue, Knowlhill, Milton Keynes MK5 8PP, United Kingdom and should be returned immediately upon request.  
To check its validity telephone +44 (0) 345 080 9000. An electronic certificate can be authenticated [online](#).

BSI Assurance UK Limited, registered in England under number 7805321 at 389 Chiswick High Road, London W4 4AL, UK.  
A member of BSI Group of Companies.

# Kitemark™ Certificate

No. KM 15121

Reference Number	Description	Size	Production site	
			France	Budapest
YP4 U	Union Connector Cane Joint	15 & 22	•	
YP5	Tank Connector	15 x 1/2" to 28 x 1"	•	
		35 x 1 1/4" to 54 x 2"		•
YP5DN	Tank Connector	15 x 3/4" to 28 x 1.1/4"	•	
YP5FC	Tank Connector	15 x 1/2" to 28 x 1"	•	
YP6	Reducer	8 x 6 to 28 x 22	•	
		35 x 15 to 67 x 35		•
YP6IM	Adaptor	15 x 1/2", 22 x 3/4", 28 x 1"	•	
YP7	Female Adaptor	15 x 1/2" to 28 x 1"	•	
		35 x 1 1/4" to 54 x 2"		•
YP8	Male Adaptor	15 x 1/2" to 28 x 1"	•	
		35 x 1 1/4" to 54 x 2"		•
YP9	Adaptor	1/2" x 15 to 1" x 28	•	
		1 1/4" x 35 to 2" x 54		•
YP99	Adaptor Metric to Imperial	15 x 1/2" to 28 x 1"	•	
		35 x 1 1/4" to 42 x 1.1/2"		•
YP11	Union Coupling	8 to 28	•	
		35 to 67		•
YP11s	Street Union Coupling	15 & 22	•	
YP12	Elbow	6 to 28	•	
		35 to 67		•
YP12R	Reducing Elbow	22 x 15 & 28 x 22	•	
YP12s	Street Elbow	8 to 28	•	
		35 to 42		•

First Issued: 1945-10-02

Latest Issue: 2017-09-11

Page: 3 of 52

This certificate has been issued by and remains the property of BSI Assurance UK Ltd, Kitemark Court, Davy Avenue, Knowlhill, Milton Keynes MK5 8PP, United Kingdom and should be returned immediately upon request.  
To check its validity telephone +44 (0) 345 080 9000. An electronic certificate can be authenticated [online](#).

BSI Assurance UK Limited, registered in England under number 7805321 at 389 Chiswick High Road, London W4 4AL, UK.  
A member of BSI Group of Companies.



# Kitemark™ Certificate

No. KM 15121

Reference Number	Description	Size	Production site	
			France	Budapest
YP13	Male Elbow	8 x 1/4" to 28 x 1"	•	
		35 x 1 1/4" to 54 x 2"		•
YP13LC	Reducing Male Elbow	12 x 1/4" to 15 x 3/8"	•	
YP14	Female Elbow	12 x 3/8" to 28 x 3/4"	•	
		35 x 1 1/4"		•
YP14LC	Reducing Female Elbow	15 x 1/4" to 22 x 1/2"	•	
YP14LI	Reducing Female Elbow	12 x 1/2"		•
YP15	Backplate Elbow	15 x 1/2" & 22 x 3/4"	•	
YP15LN	Backplate Elbow	15 x 1/2"	•	
YP17	Flanged Bend	15 x 1/2", 15 x 3/4", 22 x 3/4"	•	
YP17FC	Overflow Bend	15 x 1/2" & 22 x 3/4"	•	
YP18	Slow Bend	15 to 28	•	
YP20	Return Bend	15 to 28	•	
YP21	Obtuse Elbow 45°	15 to 28	•	
		35 to 67		•
YP22	Partial Crossover	15 & 22	•	
YP23	Full Crossover	15 & 22	•	
YP24	Tee	6 to 28	•	
		35 to 67		•
YP24s	Equal Tee Slip Pattern	15, 22	•	
YP24IM	Adaptor Tee	1/2" x 1/2" x 15m 3/4" x 3/4" x 22	•	

First Issued: 1945-10-02

Latest Issue: 2017-09-11

Page: 4 of 52

This certificate has been issued by and remains the property of BSI Assurance UK Ltd, Kitemark Court, Davy Avenue, Knowlhill, Milton Keynes MK5 8PP, United Kingdom and should be returned immediately upon request.  
To check its validity telephone +44 (0) 345 080 9000. An electronic certificate can be authenticated [online](#).

BSI Assurance UK Limited, registered in England under number 7805321 at 389 Chiswick High Road, London W4 4AL, UK.  
A member of BSI Group of Companies.

# Kitemark™ Certificate

No. KM 15121

Reference Number	Description	Size	Production site	
			France	Budapest
YP25	Reducing Tee	15 x 15 x 15 to 28 x 28 x 22	•	
		35 x 35 x 15 to 67 x 67 x 28		•
YP26	Reducing Tee	22 x 15 x 22 to 28 x 22 x 28	•	
		35 x 15 x 35 to 54 x 42 x 54		•
YP27	Reducing Tee	15 x 12 x 12 to 28 x 22 x 22	•	
		35 x 22 x 22 to 54 x 42 x 42		•
YP28	Reducing Tee	8 x 8 x 15 to 22 x 22 x 28	•	
		22 x 22 x 35 to 42 x 42 x 54		•
YP29	Tee	15 x 1/2" x 15 to 28 x 1" x 28	•	
YP29R	Reducing Tee	22 x 1/2" x 22 to 35 x 1/2" x 35		•
YP30	Tee	15 x 15 x 1/2" to 28 x 28 x 1"	•	
YP30R	Reducing Tee	15 x 15 x 1/4" to 28 x 28 x 3/4"	•	
		35 x 35 x 1/2" to 42 x 42 x 1/2"		•
YP30 BP	Backplate Tee	15 x 15 x 1/2"	•	
YP33	Heater Tee	1/2" x 1/2" x 15	•	
YP34	Heater Tee	1/2" x 1/2" x 15	•	
YP36	Corner Tee	15 & 22	•	
YP37	Sweep Tee	15 to 28	•	
		35 to 67		•
YP37R	Sweep Tee	22 x 22 x 15 to 28 x 28 x 22	•	
		35 x 35 x 15 to 35 x 35 x 22		•
YP40	Offset Tee	15 x 15 x 15 to 22 x 22 x 15	•	
YP43	Double Sweep Tee	15 to 28	•	
YP50	Cross	15 to 28	•	

First Issued: 1945-10-02

Latest Issue: 2017-09-11

Page: 5 of 52

This certificate has been issued by and remains the property of BSI Assurance UK Ltd, Kitemark Court, Davy Avenue, Knowlhill, Milton Keynes MK5 8PP, United Kingdom and should be returned immediately upon request.  
To check its validity telephone +44 (0) 345 080 9000. An electronic certificate can be authenticated [online](#).

BSI Assurance UK Limited, registered in England under number 7805321 at 389 Chiswick High Road, London W4 4AL, UK.  
A member of BSI Group of Companies.

# Kitemark™ Certificate

No. KM 15121

Reference Number	Description	Size	Production site	
			France	Budapest
YP60	Stop End	15 to 28	•	
YP61	Stop End	8 to 28	•	
		35 to 54		•
YP62	Straight Tap Connector	15 x 3/8" to 22 x 3/4"	•	
YP62M	Straight Meter Union Connector	22 x 3/4" to 22 x 1"	•	
YP63	Bent Tap Connector	15 x 3/8" to 22 x 3/4"	•	
YP63M	Bent Meter Union Connector	22 x 3/4" to 22 x 1"	•	
YP63LS	Bent Tap Connector - Long Shank	15 x 1/2"	•	
YP64	Bent Union Adaptor	12 x 1/2" to 28 x 3/4"	•	
		35 x 1 1/4" to 54 x 2"		•
YP64 C/L	Bent Union Adaptor	15 x 3/4" to 28 x 1 1/4"	•	
YP65	Bent Male Union Connector	12 x 3/8" to 28 x 1"	•	
		35 x 1 1/4" to 54 x 2"		•
YP65 DP	Bent Male Union Connector	22 x 3/4"	•	
YP65F	Bent Female Union Connector	12 x 3/8" to 28 x 1"	•	
		35 x 1 1/4" to 54 x 2"		•
YP65 P	Bent Male Union Connector	15 x 1/2" to 28 x 1"	•	
YP65R	Bent Male Union Connector	22 x 1"	•	
YP68	Straight Union Adaptor	8 x 3/4" to 28 x 3/4"	•	
		35 x 1 1/4" to 54 x 2"		•
YP68 C/L	Straight Union Adaptor	15 x 3/4" to 28 x 1.1/4"	•	
YP69	Straight Male Union Connector	8 x 3/4" to 28 x 3/4"	•	
		35 x 1 1/4" to 54 x 2"		•

First Issued: 1945-10-02

Latest Issue: 2017-09-11

Page: 6 of 52

This certificate has been issued by and remains the property of BSI Assurance UK Ltd, Kitemark Court, Davy Avenue, Knowlhill, Milton Keynes MK5 8PP, United Kingdom and should be returned immediately upon request.  
To check its validity telephone +44 (0) 345 080 9000. An electronic certificate can be authenticated [online](#).

BSI Assurance UK Limited, registered in England under number 7805321 at 389 Chiswick High Road, London W4 4AL, UK.  
A member of BSI Group of Companies.

# Kitemark™ Certificate

No. KM 15121

Reference Number	Description	Size	Production site	
			France	Budapest
YP69 DP	Straight Male Union Connector	22 x 3/4"	•	
YP69F	Straight Female Union Connector	15 x 1/2" to 28 x 1"	•	
		35 x 1 1/4" to 54 x 2"		•
YP69P	Straight Male Union Connector	15 x 1/2" to 28 x 1"	•	
		35 x 1 1/4" to 54 x 2"		•
YP69R	Straight Male Union Connector	22 x 1"	•	
YP112	Stop End Floor Plate	15 to 28	•	
YP112A	Floor Plate	15	•	
W1IM	Adaptor Coupling	1/2" x 15, 3/4" x 22, 1" x 28		•
W1	Straight Coupling	6 to 28	•	
		35 to 67		•
W1R	Reducing Coupling	8 x 6 to 28 x 22	•	
		35 x 18 to 54 x 42		•
W2	Straight Female Connector	10 x 3/8", to 28 x 3/4"	•	
		35 x 1" to 54 x 2"		•
W3	Straight Male Connector	10 x 3/8" to 28 x 3/4"	•	
		35 x 1 1/4" to 54 x 2"		•
YP3LI	Reducing Male Connector	6 x 1/4" to 22 x 1"	•	
W6	Reducer	8 x 6 to 28 x 22	•	
		35 x 18 to 54 x 42		•
W12	Elbow	6 to 28	•	
		35 to 67		•

First Issued: 1945-10-02

Latest Issue: 2017-09-11

Page: 7 of 52

This certificate has been issued by and remains the property of BSI Assurance UK Ltd, Kitemark Court, Davy Avenue, Knowlhill, Milton Keynes MK5 8PP, United Kingdom and should be returned immediately upon request.  
To check its validity telephone +44 (0) 345 080 9000. An electronic certificate can be authenticated [online](#).

BSI Assurance UK Limited, registered in England under number 7805321 at 389 Chiswick High Road, London W4 4AL, UK.  
A member of BSI Group of Companies.

# Kitemark™ Certificate

No. KM 15121

Reference Number	Description	Size	Production site	
			France	Budapest
W12s	Street Elbow	8 to 28	•	
		35 to 42		•
W13	Male Elbow	15 x 1/2" to 28 x 1"	•	
		35 x 1 1/4" to 54 x 2"		•
W14	Female Elbow	15 x 1/2" to 28 x 1"	•	
		35 x 1" to 54 x 2"		•
W15	Backplate Elbow	15 x 1/2" & 22 x 3/4"	•	
W21	Obtuse Elbow 45°	15 to 28	•	
		35 to 54		•
W24	Tee	6 to 28	•	
		35 to 54		•
W25	Reducing Tee	10 x 10 x 6 to 28 x 28 x 22	•	
		15 x 15 x 8 to 54 x 54 x 42		•
W26	Reducing Tee	15 x 12 x 15 to 28 x 22 x 28	•	
		28 x 15 x 28 to 54 x 42 x 54		•
W27	Reducing Tee	22 x 15 x 15 to 28 x 22 x 22	•	
		28 x 15 x 15 to 54 x 42 x 42		•
W28	Reducing Tee	8 x 8 x 15 to 22 x 22 x 28	•	
		22 x 22 x 38 to 35 x 35 x 42		•
W61	Stop End	8 to 28	•	
		35 to 54		•
W62	Straight Tap Connector	15 x 3/8" to 22 x 3/4"	•	
W63	Bent Tap Connector	15 x 3/8" to 22 x 3/4"	•	

First Issued: 1945-10-02

Latest Issue: 2017-09-11

Page: 8 of 52

This certificate has been issued by and remains the property of BSI Assurance UK Ltd, Kitemark Court, Davy Avenue, Knowlhill, Milton Keynes MK5 8PP, United Kingdom and should be returned immediately upon request.  
To check its validity telephone +44 (0) 345 080 9000. An electronic certificate can be authenticated [online](#).

BSI Assurance UK Limited, registered in England under number 7805321 at 389 Chiswick High Road, London W4 4AL, UK.  
A member of BSI Group of Companies.

# Kitemark™ Certificate

No. KM 15121

Reference Number	Description	Size	Production site	
			France	Budapest
W68	Straight Union Adaptor	8 x 3/4" to 28 x 3/4"	•	
		35 x 1 1/4" to 54 x 2"		•
N1 IM	Adaptor Coupling	1/2" x 15, 3/4" x 22, 1" x 28	•	
N1 AV	Air Release Coupling	15, 22, 28	•	
N1	Straight Coupling	6 to 28	•	
		35 to 54		•
N1R	Reducing Coupling	8 x 6 to 28 x 22	•	•
		35 x 18 to 54 x 42		•
N1s	Straight Coupling, Slip Pattern	15 to 28	•	
		35 to 54		•
ND2	Straight Female Connector	15 x 1/2" to 22 x 3/4"	•	
N2	Straight Female Connector	10 x 3/8", to 28 x 3/4"	•	
		35 x 1" to 54 x 2"		•
N3	Straight Male Connector	10 x 3/8" to 28 x 3/4"	•	
		35 x 1 1/4" to 54 x 2"		•
N3 LC	Reducing Male Connector	15 x 1/4"	•	
N4	Connector	15 & 22	•	
N4 U	Union Connector Cane Joint	15 & 22	•	
N5	Tank Connector	15 x 1/2" to 28 x 1"	•	
N6	Reducer	8 x 6 to 28 x 22	•	
		35 x 18 to 54 x 42		•
N7	Female Adaptor	15 x 1/2 to 28 x 1",	•	
		35 x 1" to 54 x 2"		•

First Issued: 1945-10-02

Latest Issue: 2017-09-11

Page: 9 of 52

This certificate has been issued by and remains the property of BSI Assurance UK Ltd, Kitemark Court, Davy Avenue, Knowlhill, Milton Keynes MK5 8PP, United Kingdom and should be returned immediately upon request.  
To check its validity telephone +44 (0) 345 080 9000. An electronic certificate can be authenticated [online](#).

BSI Assurance UK Limited, registered in England under number 7805321 at 389 Chiswick High Road, London W4 4AL, UK.  
A member of BSI Group of Companies.

# Kitemark™ Certificate

No. KM 15121

Reference Number	Description	Size	Production site	
			France	Budapest
N8	Male Adaptor	15 x 1/2" to 28 x 1"	•	
		35 x 1 1/4" to 54 x 2"		•
N11	Union Coupling	15 to 28	•	
		35 to 54		•
N12	Elbow	10 to 28	•	
		35 to 76		•
N12R	Reducing Elbow	22 x 15	•	
N12s	Street Elbow	15 to 28	•	
		35 to 54		•
N13	Male Elbow	15 x 1/2" to 28 x 1"	•	
		35 x 1 1/4" to 54 x 2"		•
N13 LC	Reducing Male Elbow	15 x 1/4"	•	
N14	Female Elbow	15 x 1/2" to 28 x 1"	•	
		35 x 1" to 54 x 2"		•
N15	Backplate Elbow	15 x 1/2" & 22 x 3/4"	•	
N17 FC	Overflow Elbow	22 x 3/4"	•	
N18	Bend	10 to 28	•	
		35 to 54		•
N18s	Slow Street Elbow	15 to 28	•	
		35 to 54		•

First Issued: 1945-10-02

Latest Issue: 2017-09-11

Page: 10 of 52

This certificate has been issued by and remains the property of BSI Assurance UK Ltd, Kitemark Court, Davy Avenue, Knowlhill, Milton Keynes MK5 8PP, United Kingdom and should be returned immediately upon request.  
To check its validity telephone +44 (0) 345 080 9000. An electronic certificate can be authenticated [online](#).

BSI Assurance UK Limited, registered in England under number 7805321 at 389 Chiswick High Road, London W4 4AL, UK.  
A member of BSI Group of Companies.

# Kitemark™ Certificate

No. KM 15121

Reference Number	Description	Size	Production site	
			France	Budapest
N20	Return Bend	15 to 28	•	
N21	Obtuse Elbow 45°	15 to 28	•	
		35 to 54		•
N21s	Obtuse Street Elbow	15 to 28	•	
		35 to 54		•
N22	Partial Crossover	15 & 22	•	•
N23	Full Crossover	15 & 22	•	•
N24	Tee	6 to 28	•	•
		35 to 54		•
N25	Reducing Tee	10 x 10 x 6 to 28 x 28 x 22	•	
		15 x 15 x 8 to 54 x 54 x 42		•
N26	Reducing Tee	15 x 12 x 15 to 28 x 22 x 28	•	
		28 x 15 x 28 to 54 x 42 x 54		•
N27	Reducing Tee	22 x 15 x 15 to 28 x 22 x 22	•	
		28 x 15 x 15 to 54 x 42 x 42		•
N28	Reducing Tee	15 x 15 x 22 to 22 x 22 x 28	•	
		22 x 22 x 38 to 35 x 35 x 42		•
N29	Tee	15 x 1/2" x 15, 22 x 3/4" x 22	•	
N29R	Reducing Tee	22 x 1/2" x 22 & 28 x 1/2" x 28	•	

First Issued: 1945-10-02

Latest Issue: 2017-09-11

Page: 11 of 52

This certificate has been issued by and remains the property of BSI Assurance UK Ltd, Kitemark Court, Davy Avenue, Knowlhill, Milton Keynes MK5 8PP, United Kingdom and should be returned immediately upon request.  
To check its validity telephone +44 (0) 345 080 9000. An electronic certificate can be authenticated [online](#).

BSI Assurance UK Limited, registered in England under number 7805321 at 389 Chiswick High Road, London W4 4AL, UK.  
A member of BSI Group of Companies.



# Kitemark™ Certificate

No. KM 15121

Reference Number	Description	Size	Production site	
			France	Budapest
N30	Tee	15 x 15 x 1/2", 22 x 22 x 3/4" & 28 x 28 x 1"	•	
N30R	Reducing Tee	22 x 22 x 1/2", 28 x 28 x 1/2" & 28 x 28 x 3/4"	•	
N37	Sweep Tee	15 & 22	•	
N61	Stop End	8 to 28	•	
		35 to 54		•
N61 AV	Air Release Stop End	15 to 28	•	
N62	Straight Tap Connector	12 x 1/2" to 22 x 3/4"	•	
N63	Bent Tap Connector	15 x 1/2" 15 x 3/4" & 22 x 3/4"	•	
N63L	Bent Tap Connector - Long	15 x 1/2"	•	
N64	Bent Union Adaptor	15 x 3/4" to 28 x 1.1/4"	•	
N65	Bent Male Union Connector	15 x 1/2" to 28 x 1"	•	
		35 x 1 1/4" to 54 x 2"		•
N65F	Bent Female Union Connector	15 x 1/2" to 28 x 1"	•	
N68	Straight Union Adaptor	15 x 3/4" to 28 x 1.1/4"	•	
N68 C/L	Straight Union Adaptor	15 x 3/4"	•	
N69	Straight Male Union Connector	15 x 1/2" to 28 x 1"	•	
		35 x 1 1/4" to 54 x 2"		•
N69F	Straight Female Union Connector	15 x 1/2" to 28 x 1"	•	

First Issued: 1945-10-02

Latest Issue: 2017-09-11

Page: 12 of 52

This certificate has been issued by and remains the property of BSI Assurance UK Ltd, Kitemark Court, Davy Avenue, Knowlhill, Milton Keynes MK5 8PP, United Kingdom and should be returned immediately upon request.  
To check its validity telephone +44 (0) 345 080 9000. An electronic certificate can be authenticated [online](#).

BSI Assurance UK Limited, registered in England under number 7805321 at 389 Chiswick High Road, London W4 4AL, UK.  
A member of BSI Group of Companies.

# Kitemark™ Certificate

No. KM 15121

Reference Number	Description	Size	Production site	
			France	Budapest
CB1 IM	Adaptor Coupling	1/2" x 15, 3/4" x 22, 1" x 28	•	
CB9	Adaptor	1/2" x 15 & 3/4" x 22	•	
CB1	Straight Coupling	6 to 28	•	
		35 to 54		•
CB1R	Reducing Coupling	8 x 6 to 28 x 22	•	•
		35 x 18 to 54 x 42		•
CB1s	Straight Coupling, Slip Pattern	15 to 28	•	
		35 to 54		•
CB2	Straight Female Connector	10 x 3/8", to 28 x 3/4"	•	
		35 x 1" to 54 x 2"		•
CB3	Straight Male Connector	10 x 3/8" to 28 x 3/4"	•	
		35 x 1 1/4" to 54 x 2"		•
CB6	Reducer	8 x 6 to 54 x 42		•
		8 x 6 to 28 x 22	•	
CB9	Adaptor	1/2" x 15 to 3/4" x 22	•	
CB12	Elbow	10 to 28	•	
		35 to 76		•
CB12s	Street Elbow	15 to 28	•	
		35 to 54		•
CB15	Backplate Elbow	15 x 1/2" & 22 x 3/4"	•	
CB21	Obtuse Elbow 45°	15 to 28	•	
		35 to 54		•

First Issued: 1945-10-02

Latest Issue: 2017-09-11

Page: 13 of 52

This certificate has been issued by and remains the property of BSI Assurance UK Ltd, Kitemark Court, Davy Avenue, Knowlhill, Milton Keynes MK5 8PP, United Kingdom and should be returned immediately upon request.  
To check its validity telephone +44 (0) 345 080 9000. An electronic certificate can be authenticated [online](#).

BSI Assurance UK Limited, registered in England under number 7805321 at 389 Chiswick High Road, London W4 4AL, UK.  
A member of BSI Group of Companies.

# Kitemark™ Certificate

No. KM 15121

Reference Number	Description	Size	Production site	
			France	Budapest
CB21s	Obtuse Street Elbow	15 to 28	•	
		35 to 54		•
CB24	Tee	15 & 22	•	•
		15 & 22	•	•
CB25	Reducing Tee	6 to 28	•	•
		35 to 54		•
CB26	Reducing Tee	10 x 10 x 6 to 28 x 28 x 22	•	
		15 x 15 x 8 to 54 x 54 x 42		•
CB27	Reducing Tee	15 x 12 x 15 to 28 x 22 x 28	•	
		28 x 15 x 28 to 54 x 42 x 54		•
CB28	Reducing Tee	15 x 15 x 22 to 22 x 22 x 28	•	
		22 x 22 x 38 to 35 x 35 x 42		•
CB30	Tee	15 x 15 x 1/2", 22 x 22 x 3/4" & 28 x 28 x 1"	•	
CB30R	Reducing Tee	22 x 22 x 1/2", 28 x 28 x 1/2" & 28 x 28 x 3/4"	•	
CB61	Stop End	8 to 28	•	
		35 to 54		•
CB62	Straight Tap Connector	12 x 1/2" to 22 x 3/4"	•	
CB63	Bent Tap Connector	15 x 1/2" 15 x 3/4" & 22 x 3/4"	•	
CB64	Bent Union Adaptor	15 x 3/4" to 28 x 1.1/4"	•	
CB65	Bent Male Union Connector	15 x 1/2" to 28 x 1"	•	
		35 x 1 1/4" to 54 x 2"		•
CB65F	Bent Female Union Connector	15 x 1/2" to 28 x 1"	•	

First Issued: 1945-10-02

Latest Issue: 2017-09-11

Page: 14 of 52

This certificate has been issued by and remains the property of BSI Assurance UK Ltd, Kitemark Court, Davy Avenue, Knowlhill, Milton Keynes MK5 8PP, United Kingdom and should be returned immediately upon request.  
To check its validity telephone +44 (0) 345 080 9000. An electronic certificate can be authenticated [online](#).

BSI Assurance UK Limited, registered in England under number 7805321 at 389 Chiswick High Road, London W4 4AL, UK.  
A member of BSI Group of Companies.

# Kitemark™ Certificate

No. KM 15121

Reference Number	Description	Size	Production site	
			France	Budapest
CB68	Straight Union Adaptor	15 x 3/4" to 28 x 1.1/4"	•	
E1 IM	Adaptor Coupling	1/2" x 15, 3/4" x 22, 1" x 28	•	
E1	Straight Coupling	6 to 28	•	
		35 to 54		•
E1R	Reducing Coupling	8 x 6 to 28 x 22	•	•
		35 x 18 to 54 x 42		•
E1s	Straight Coupling, Slip Pattern	15 to 28	•	
		35 to 54		•
E2	Straight Female Connector	10 x 3/8", to 28 x 3/4"	•	
		35 x 1" to 54 x 2"		•
E3	Straight Male Connector	10 x 3/8" to 28 x 3/4"	•	
		35 x 1 1/4" to 54 x 2"		•
E6	Reducer	8 x 6 to 54 x 42		•
		8 x 6 to 28 x 22	•	
E9	Adaptor	1/2" x 15 to 3/4" x 22	•	
E12	Elbow	10 to 28	•	
		35 to 76		•
E12S	Street Elbow	15 to 28	•	
		35 to 54		•
E13	Male Elbow	15 x 1/2" to 28 x 1"	•	
		35 x 1 1/4" to 54 x 2"		•
E15	Backplate Elbow	15 x 1/2" & 22 x 3/4"	•	

First Issued: 1945-10-02

Latest Issue: 2017-09-11

Page: 15 of 52

This certificate has been issued by and remains the property of BSI Assurance UK Ltd, Kitemark Court, Davy Avenue, Knowlhill, Milton Keynes MK5 8PP, United Kingdom and should be returned immediately upon request.  
To check its validity telephone +44 (0) 345 080 9000. An electronic certificate can be authenticated [online](#).

BSI Assurance UK Limited, registered in England under number 7805321 at 389 Chiswick High Road, London W4 4AL, UK.  
A member of BSI Group of Companies.

# Kitemark™ Certificate

No. KM 15121

Reference Number	Description	Size	Production site	
			France	Budapest
E21	Obtuse Elbow 45°	15 to 28	•	
		35 to 54		•
E21s	Obtuse Street Elbow	15 to 28	•	
		35 to 54		•
E22	Partial Crossover	15 & 22	•	•
E23	Full Crossover	15 & 22	•	•
E24	Tee	6 to 28	•	•
		35 to 54		•
E25	Reducing Tee	10 x 10 x 6 to 28 x 28 x 22	•	
		15 x 15 x 8 to 54 x 54 x 42		•
E26	Reducing Tee	15 x 12 x 15 to 28 x 22 x 28	•	
		28 x 15 x 28 to 54 x 42 x 54		•
E27	Reducing Tee	22 x 15 x 15 to 28 x 22 x 22	•	
		28 x 15 x 15 to 54 x 42 x 42		•
E28	Reducing Tee	15 x 15 x 22 to 22 x 22 x 28	•	
		22 x 22 x 38 to 35 x 35 x 42		•
E30	Tee	15 x 15 x 1/2", 22 x 22 x 3/4" & 28 x 28 x 1"	•	
E30R	Reducing Tee	22 x 22 x 1/2", 28 x 28 x 1/2" & 28 x 28 x 3/4"	•	
E61	Stop End	8 to 28	•	
		35 to 54		•
E61AV	Air release Stop End	15 to 28	•	
E62	Straight Tap Connector	12 x 1/2" to 22 x 3/4"	•	
E63	Bent Tap Connector	15 x 1/2" 15 x 3/4" & 22 x 3/4"	•	
E64	Bent Union Adaptor	15 x 3/4" to 28 x 1.1/4"	•	
E68	Straight Union Adaptor	15 x 3/4" to 28 x 1 1/4"	•	

First Issued: 1945-10-02

Latest Issue: 2017-09-11

Page: 16 of 52

This certificate has been issued by and remains the property of BSI Assurance UK Ltd, Kitemark Court, Davy Avenue, Knowlhill, Milton Keynes MK5 8PP, United Kingdom and should be returned immediately upon request.  
To check its validity telephone +44 (0) 345 080 9000. An electronic certificate can be authenticated [online](#).

BSI Assurance UK Limited, registered in England under number 7805321 at 389 Chiswick High Road, London W4 4AL, UK.  
A member of BSI Group of Companies.

# Kitemark™ Certificate

No. KM 15121

Reference Number	Description	Size	Production site	
			France	Budapest
K600 – 610	Straight Coupling	6, 8, 10, 12*, 15, 18*, 22, 28, 35*, 42*, 54*, 8 x 6, 10 x 8, 12 x 8*, 12 x 10*, 15 x 8*, 15, x 10, 15 x 12*, 18 x 15*, 22 x 15, 28 x 15, 28 x 22		•
K900 Pro – 910	Straight Coupling	10, 12, 15, 18, 22, 28, 35, 42, 54, 12 x 10, 15 x 8, 15, x 10, 15 x 12, 18 x 15, 22 x 15, 28 x 22		•
K600 – 611	Male Coupling	6 x 1/8", 6 x 1/4", 8 x 1/8", 8 x 1/4", 10 x 1/4", 10 x 3/8", 10 x 1/2", 12 x 1/4"*, 12 x 3/8"*, 12 x 1/2"*, 15 x 1/4", 15 x 3/8"*, 15 x 1/2", 15 x 3/4", 18 x 1/2"*, 18 x 3/4", 22 x 1/2"*, 22 x 3/4", 22 x 1", 28 x 3/4"*, 28 x 1", 28 x 1 1/4", 35 x 1"*, 35 x 1 1/4"*, 42 x 1 1/2"*, 54 x 2"*		•
K900 Pro – 911	Male Coupling	12 x 3/8", 12 x 1/2", 15 x 1/4", 15 x 3/8", 15 x 1/2", 15 x 3/4", 18 x 1/2", 18 x 3/4", 22 x 1/2", 22 x 3/4", 22 x 1", 28 x 3/4", 28 x 1", 35 x 1", 35 x 1 1/4", 42 x 1 1/2", 54 x 2"		•
K600 – 611P	Male Coupling	8 x 1/4"*, 10 x 3/8"*, 12 x 3/8"*, 15 x 1/2", *15 x 3/4", 22 x 3/4", 22 x 1", 28 x 1", *35 x 1 1/4", 42 x 1 1/2"*		•
*Items in the K600 Range marked * are supplied from the K900 Range.				

First Issued: 1945-10-02

Latest Issue: 2017-09-11

Page: 17 of 52

This certificate has been issued by and remains the property of BSI Assurance UK Ltd, Kitemark Court, Davy Avenue, Knowlhill, Milton Keynes MK5 8PP, United Kingdom and should be returned immediately upon request.  
To check its validity telephone +44 (0) 345 080 9000. An electronic certificate can be authenticated [online](#).

BSI Assurance UK Limited, registered in England under number 7805321 at 389 Chiswick High Road, London W4 4AL, UK.  
A member of BSI Group of Companies.

# Kitemark™ Certificate

No. KM 15121

Reference Number	Description	Size	Production site	
			France	Budapest
K900 Pro – 911P	Male Coupling	8 x 1/4", 10 x 3/8", 12 x 3/8", 15 x 1/2", 15 x 3/4", 22 x 3/4", 22 x 1", 28 x 1", 35 x 1 1/4", 42 x 1 1/2"		•
K600 – 611TC	Long Tank Coupling	15 x 1/2", 22 x 3/4", *28 x 1", 22 x 3/4"	•	•
K900 Pro – 911LB	Long Tank Coupling	22 x 3/4", 28 x 1"*	•	•
K600 – 611TC	Tank Coupling	15 x 1/2"	•	•
K900 Pro – 911TC	Tank Coupling	15x1/2"	•	•
K600 – 612	Female Coupling	8x1/4", 10x3/8", 10x1/2", 12x3/8"*, 12x1/2"*, 15x3/8"*, 15x1/2", 15x3/4"*, 18x1/2"*, 18x3/4"*, 22x1/2"*, 22x3/4", 22x1", 28x3/4", 28x1", 35x11/4"*, 42x11/2"*, 54x2"*		•
K900 Pro – 912	Female Coupling	12x3/8", 12x1/2", 15x3/8"*, 15x1/2", 15x3/4", 18x1/2", 18x3/4"*, 22x1/2"*, 22x3/4", 28x1", 35x11/4"*, 42x11/2", 54x2"		•
K600 – 612ST	Female Tap Coupling	15 x 1/2", 15 x 3/4", 22 x 3/4"	•	•
K600 – 615	Elbow	15 x 10, 15 x 12, 22 x 15, 28 x 22 6, 8, 10, 12*, 15, 22, 28, 35*, 42* 54mm*		•
K900 Pro – 915	Elbow	12, 15, 22, 28, 35, 42, 54mm		•
*Items in the K600 Range marked * are supplied from the K900 Range.				

First Issued: 1945-10-02

Latest Issue: 2017-09-11

Page: 18 of 52

This certificate has been issued by and remains the property of BSI Assurance UK Ltd, Kitemark Court, Davy Avenue, Knowlhill, Milton Keynes MK5 8PP, United Kingdom and should be returned immediately upon request.  
To check its validity telephone +44 (0) 345 080 9000. An electronic certificate can be authenticated [online](#).

BSI Assurance UK Limited, registered in England under number 7805321 at 389 Chiswick High Road, London W4 4AL, UK.  
A member of BSI Group of Companies.

# Kitemark™ Certificate

No. KM 15121

Reference Number	Description	Size	Production site	
			France	Budapest
K600 – 615S	Slow Bend	15, 22, 28	•	•
K600 – 616	Male Elbow	22 x 1/2", 22 x 3/4", 22 x 1", 28 x 1" 35 x 11/4"*, 42 x 11/2"*, 54 x 2"*		•
K900 Pro – 916	Male Elbow	22 x 3/4", 22 x 1", 28 x 1" 35 x 11/4", 42 x 11/2", 54 x 2"		•
K600 – 616LB	Long Male Elbow	15 x 1/2", *22 x 3/4"	•	•
K900 Pro – 916LB	Long Male Elbow	22 x 3/4 "	•	•
K600 – 617	Female Elbow	12 x 3/8"*, 12 x 1/2"*, 15 x 3/8"*, 15 x 1/2", 15 x 3/4"*, 18 x 1/2"*, 18 x 3/4"*, 22 x 1/2", 22 x 3/4", 22 x 1", 28 x 3/4", 28 x 1", 35 x 11/4"*, 42x11/2"*		•
K900 Pro – 917	Female Elbow	12 x 3/8", 12 x 1/2", 15 x 3/8", 15 x 1/2", 15 x 3/4", 18 x 1/2", 18 x 3/4", 22 x 3/4", 22 x 1", 28 x 3/4", 28 x 1", 35 x 11/4", 42 x 11/2"		•
K600 – 617W	Backplate Elbow	15 x 1/2", 15 x 3/4", 18 x 1/2"*, 22 x 1/2", *22 x 3/4"	•	•
K900 Pro – 917W	Backplate Elbow	22 x 3/4"	•	•
K600 – 618	Equal Tee	6, 8, 10, 12*, 15, 18*, 22, 28	•	•
K900 Pro – 918	Equal Tee	10, 12, 15, 18, 22, 28	•	•
*Items in the K600 Range marked * are supplied from the K900 Range.				

First Issued: 1945-10-02

Latest Issue: 2017-09-11

Page: 19 of 52

This certificate has been issued by and remains the property of BSI Assurance UK Ltd, Kitemark Court, Davy Avenue, Knowlhill, Milton Keynes MK5 8PP, United Kingdom and should be returned immediately upon request.  
To check its validity telephone +44 (0) 345 080 9000. An electronic certificate can be authenticated [online](#).

BSI Assurance UK Limited, registered in England under number 7805321 at 389 Chiswick High Road, London W4 4AL, UK.  
A member of BSI Group of Companies.



# Kitemark™ Certificate

No. KM 15121

Reference Number	Description	Size	Production site	
			France	Budapest
K600 – 618B	Reduced Branch Tee	15 x 15 x 12*, 18 x 18 x 12*, 18 x 18 x 15*, 22 x 22 x 15, 22 x 22 x 18*, 28 x 28 x 15*, 28 x 28 x 22*, 35 x 35 x 15*, 35 x 35 x 22*, 35 x 35 x 28*, 42 x 42 x 22*, 42 x 42 x 28*, 54 x 54 x 28*		•
K900 Pro – 918B	Reduced Branch Tee	15 x 15 x 12, 18 x 18 x 12, 18 x 18 x 15, 22 x 22 x 15, 22 x 22 x 18, 28 x 28 x 15, 28 x 28 x 22, 35 x 35 x 15 35 x 35 x 22, 35 x 35 x 28, 42 x 42 x 22, 42 x 42 x 28, 54 x 54 x 28		•
K600 – 618E	Tee – One End Reduced	15 x 12 x 15*, 18 x 12 x 18*, 18 x 15 x 18*, 22 x 12 x 22*, 22 x 15 x 22	•	•
K900 Pro – 918E	Tee – One End Reduced	22 x 15 x 22	•	•
K600 – 618EB	Tee – One End & Branch Reduced	15 x 12 x 12*, 18 x 12 x 12*, 18 x 15 x 12*, 18 x 15 x 15*, 22 x 15 x 12*, 22 x 15 x 15, 28 x 15 x 15, 28 x 15 x 22*, 28 x 22 x 15*, 28 x 22 x 22*	•	•
*Items in the K600 Range marked * are supplied from the K900 Range.				

First Issued: 1945-10-02

Latest Issue: 2017-09-11

Page: 20 of 52

This certificate has been issued by and remains the property of BSI Assurance UK Ltd, Kitemark Court, Davy Avenue, Knowlhill, Milton Keynes MK5 8PP, United Kingdom and should be returned immediately upon request.  
To check its validity telephone +44 (0) 345 080 9000. An electronic certificate can be authenticated [online](#).

BSI Assurance UK Limited, registered in England under number 7805321 at 389 Chiswick High Road, London W4 4AL, UK.  
A member of BSI Group of Companies.

# Kitemark™ Certificate

No. KM 15121

Reference Number	Description	Size	Production site	
			France	Budapest
K900 Pro – 918EB	Tee – One End & Branch Reduced	15 x 12 x 12, 22 x 15 x 15, 28 x 22 x 22	•	•
K600 – 620	Male End Tee	15 x 1/2" x 15*, 22 x 3/4" x 22*, 28 x 1" x 28*	•	•
K900 Pro – 920	Male End Tee	15 x 1/2" x 15	•	•
K600 – 623	Cross	15 x 15 x 15 x 15*, 15 x 22 x 15 x 15, 15 x 22 x 15 x 22, 22 x 22 x 22 x 22	•	•
K900 Pro – 923	Cross	15 x 15 x 15 x 15	•	•
K600 – 630	Female Branch Tee	12 x 12 x 3/8"*, 15 x 15 x 1/4"*, 15 x 15 x 3/8"*, 15 x 15 x 1/2"*, 18 x 18 x 1/2", 18 x 18 x 3/4"*, 22 x 22 x 1/2"*, 22 x 22 x 3/4"*, 28 x 28 x 1/2"*, 28 x 28 x 3/4", 28 x 28 x 1"*	•	•
K900 Pro – 930	Female Branch Tee	15 x 15 x 1/4", 15 x 15 x 1/2", 22 x 22 x 1/2", 22 x 22 x 3/4", 28 x 28 x 1/2"*, 28 x 28 x 1"	•	•
K600 – 650	Tank Connector	15, 22, 28, 35*, 42*, 54*		•
K900 Pro – 950	Tank Connector	15, 22, 28, 35, 42, 54		•
K600 – 651	Stop End	6, 8, 10, 12*, 15, 18*, 22, 28, 35*, 42*		•
K900 Pro – 951	Stop End	12, 15, 18, 22, 28, 35, 42		•
K600 – 657	Sweep Tee	15, 22	•	•
*Items in the K600 Range marked * are supplied from the K900 Range.				

First Issued: 1945-10-02

Latest Issue: 2017-09-11

Page: 21 of 52

This certificate has been issued by and remains the property of BSI Assurance UK Ltd, Kitemark Court, Davy Avenue, Knowlhill, Milton Keynes MK5 8PP, United Kingdom and should be returned immediately upon request.  
To check its validity telephone +44 (0) 345 080 9000. An electronic certificate can be authenticated [online](#).

BSI Assurance UK Limited, registered in England under number 7805321 at 389 Chiswick High Road, London W4 4AL, UK.  
A member of BSI Group of Companies.

# Kitemark™ Certificate

No. KM 15121

Reference Number	Description	Size	Production site	
			France	Budapest
5090 (90 CU)	Elbow 90°	8, 10, 12, 15, 22, 28	•	
5041 (41 CU)	Elbow 45°	15, 22, 28	•	
5130 (130 CU)	Equal Tee	8, 10, 12, 15, 22, 28, 35, 42, 54	•	
5270 (270 CU)	Coupling	8, 10, 12, 15, 22, 28, 35, 42, 54	•	
5243 (243 CU)	Fitting Reducer	15 x 10, 15 x 12, 22 x 15, 28 x 22, 28 x 15	•	
5301 (300 CU)	End Cap	15, 22, 28	•	
5085 (85 CU)	Full Crossover	15, 22	•	
5086 (86 CU)	Part Crossover	22	•	

First Issued: 1945-10-02

Latest Issue: 2017-09-11

Page: 22 of 52

This certificate has been issued by and remains the property of BSI Assurance UK Ltd, Kitemark Court, Davy Avenue, Knowlhill, Milton Keynes MK5 8PP, United Kingdom and should be returned immediately upon request.

To check its validity telephone +44 (0) 345 080 9000. An electronic certificate can be authenticated [online](#).

BSI Assurance UK Limited, registered in England under number 7805321 at 389 Chiswick High Road, London W4 4AL, UK.  
A member of BSI Group of Companies.

# Kitemark™ Certificate

No. KM 15121

## BS EN 1254-6:2012 – Fittings with push-fit ends

Reference number	Description	Branding	Production site
32004	15MMX1/2 BSP GUNMETAL ROTH ELBOW	Classic	Doncaster
40759	T68FF 15x3/4 BSP Flat Faced Union	Classic	Doncaster
40901	T1 1/2 Coupling	Classic	Doncaster
40902	T1 3/4 Coupling	Classic	Doncaster
40903	T1 1 Coupling	Classic	Doncaster
40911	T3P 1/2 x 1/2 Male Connector	Classic	Doncaster
40912	T3P 3/4 x 3/4 Male Connector	Classic	Doncaster
40914	T5 1/2 x 1/2	Classic	Doncaster
40915	T5 3/4 x 3/4	Classic	Doncaster
40916	T6 3/4 x 1/2 Reducer	Classic	Doncaster
40918	T6 1x3/4 Reducer	Classic	Doncaster
40920	T12 1/2 Elbow	Classic	Doncaster
40921	T12 3/4 Elbow	Classic	Doncaster
40922	T12 1 Elbow	Classic	Doncaster
40930	T24 1/2 Equal Tee	Classic	Doncaster
40931	T24 3/4 Equal Tee	Classic	Doncaster
40932	T24 1 Equal Tee	Classic	Doncaster
40940	T25 3/4 x 1/2 Red Tee	Classic	Doncaster
40942	T25 1x1x3/4 Red Tee	Classic	Doncaster
40946	T26 3/4x1/2x3/4	Classic	Doncaster
40948	T27 3/4x1/2x1/2	Classic	Doncaster
40949	T27 1x3/4x3/4 Red Tee	Classic	Doncaster
40950	T61 1/2 Stop End	Classic	Doncaster
40952	T61 3/4 Stop End	Classic	Doncaster
40960	T62 1/2 x 1/2 Tap Connector	Classic	Doncaster
40963	T62 3/4 x 3/4	Classic	Doncaster
40970	T63 1/2 x 1/2	Classic	Doncaster

First Issued: 1945-10-02

Latest Issue: 2017-09-11

Page: 23 of 52

This certificate has been issued by and remains the property of BSI Assurance UK Ltd, Kitemark Court, Davy Avenue, Knowlhill, Milton Keynes MK5 8PP, United Kingdom and should be returned immediately upon request.

To check its validity telephone +44 (0) 345 080 9000. An electronic certificate can be authenticated [online](#).

BSI Assurance UK Limited, registered in England under number 7805321 at 389 Chiswick High Road, London W4 4AL, UK.  
A member of BSI Group of Companies.

# Kitemark™ Certificate

No. KM 15121

Reference number	Description	Branding	Production site
45108	T1/T270 10 Coupling	Classic	Doncaster
45109	T1/T270 10 Coupling CP	Classic	Doncaster
45110	T1/T270 12 Coupling	Classic	Doncaster
45110H	T1/T270 12 Coupling	Classic	Doncaster
45111	T1/T270 12 Coupling CP	Classic	Doncaster
45112	T1/T270 14 Coupling	Classic	Doncaster
45114	T1/T270 15 Coupling	Classic	Doncaster
45114H	T1/T270 15 Coupling	Classic	Doncaster
45114R	T1/T270 15 Coupling - Nordic	Classic	Doncaster
45115	T1/T270 15 Coupling CP	Classic	Doncaster
45116	T1/T270 16 Coupling	Classic	Doncaster
45118	T1/T270 18 Coupling	Classic	Doncaster
45118H	T1/T270 18 Coupling	Classic	Doncaster
45120	T1/T270 20 Coupling	Classic	Doncaster
45121	T1/T270 22 Coupling	Classic	Doncaster
45121H	T1/T270 22 Coupling	Classic	Doncaster
45121R	T1/T270 22 Coupling - Nordic	Classic	Doncaster
45123	T1/T270 28 Coupling	Classic	Doncaster
45123H	T1/T270 28 Coupling	Classic	Doncaster
45138	T1S/T270S 14 Slip Coupling	Classic	Doncaster
45140	T1S/T270S 12 Slip Coupling	Classic	Doncaster
45141	T1S/T270S 15 Slip Coupling	Classic	Doncaster
45141H	T1S/T270S 15 Slip Coupling	Classic	Doncaster
45142	T1S/T270S 18 Slip Coupling	Classic	Doncaster
45142H	T1S/T270S 18 Slip Coupling	Classic	Doncaster
45143	T1S/T270S 22 Slip Coupling	Classic	Doncaster
45143H	T1S/T270S 22 Slip Coupling	Classic	Doncaster
45144	T1S/T270S 28 Slip Coupling	Classic	Doncaster

First Issued: 1945-10-02

Latest Issue: 2017-09-11

Page: 24 of 52

This certificate has been issued by and remains the property of BSI Assurance UK Ltd, Kitemark Court, Davy Avenue, Knowlhill, Milton Keynes MK5 8PP, United Kingdom and should be returned immediately upon request.

To check its validity telephone +44 (0) 345 080 9000. An electronic certificate can be authenticated [online](#).

# Kitemark™ Certificate

No. KM 15121

Reference number	Description	Branding	Production site
45155	T1R/T240 12X10 Reduced Coupling	Classic	Doncaster
45156	T1R/T240 12X10 Red Coupling CP	Classic	Doncaster
45157	T1R/T240 14X12 Reduced Coupling	Classic	Doncaster
45159	T1R/T240 15X10 Reduced Coupling	Classic	Doncaster
45160	T1R/T240 15X10 Red Coupling CP	Classic	Doncaster
45161	T1R/T240 15X12 Reduced Coupling	Classic	Doncaster
45162	T1R/T240 15X12 Red Coupling CP	Classic	Doncaster
45163	T1R/T240 16X12 Reduced Coupling	Classic	Doncaster
45165	T1R/T240 16X14 Reduced Coupling	Classic	Doncaster
45167	T1R/T240 18X15 Reduced Coupling	Classic	Doncaster
45167H	T1R/T240 18x15 reduced Coupling	Classic	Doncaster
45171	T62/T062 15X3/4 St Tap Connector	Classic	Doncaster
45172	T1R/T240 22X15 Reduced Coupling	Classic	Doncaster
45174	T1R/T240 22X18 Reduced Coupling	Classic	Doncaster
45178	T1R/T240 28X22 Reduced Coupling	Classic	Doncaster
45178H	T1R/T240 28X22 REDUCED COUPLING	Classic	Doncaster
45191	T2/T270G 10X3/8 Fem Coupling CP	Classic	Doncaster
45192	T2/T270G 10X1/2 Female Coupling	Classic	Doncaster
45194	T2/T270G 12X3/8 Female Coupling	Classic	Doncaster
45194H	T2/T270G 12X3/8 FEMALE COUPLING	Classic	Doncaster
45195	T2/T270G 12X3/8 Fem Coupling CP	Classic	Doncaster
45196	T2/T270G 12X1/2 Female Coupling	Classic	Doncaster
45196H	T2/T270G 12x1/2 Female Coupling	Classic	Doncaster
45197	T2/T270G 12X1/2 Fem Coupling CP	Classic	Doncaster
45200	T2/T270G 14X3/8 Female Coupling	Classic	Doncaster
45202	T2/T270G 14X1/2 Female Coupling	Classic	Doncaster
45204	T2/T270G 15X3/8 Female Coupling	Classic	Doncaster
45204H	T2/T270G 15x3/8 Female Coupling	Classic	Doncaster

First Issued: 1945-10-02

Latest Issue: 2017-09-11

Page: 25 of 52

This certificate has been issued by and remains the property of BSI Assurance UK Ltd, Kitemark Court, Davy Avenue, Knowlhill, Milton Keynes MK5 8PP, United Kingdom and should be returned immediately upon request.

To check its validity telephone +44 (0) 345 080 9000. An electronic certificate can be authenticated [online](#).

# Kitemark™ Certificate

No. KM 15121

Reference number	Description	Branding	Production site
45205	T2/T270G 15X3/8 Fem Coupling CP	Classic	Doncaster
45206	T2/T270G 15X1/2 Female Coupling	Classic	Doncaster
45206H	T2/T270G 15X1/2 Female Coupling	Classic	Doncaster
45207	T2/T270G 15X1/2 Fem Coupling CP	Classic	Doncaster
45209	T2/T270G 16X1/2 Female Coupling	Classic	Doncaster
45210	T2/T270G 18X1/2 Female Coupling	Classic	Doncaster
45210H	T2/T270G 18X1/2 Female Coupling	Classic	Doncaster
45212	T2/T270G 18X3/4 Female Coupling	Classic	Doncaster
45212H	T2/T270G 18X3/4 Female Coupling	Classic	Doncaster
45220	T2/T270G 22X1/2 Female Coupling	Classic	Doncaster
45220H	T2/T270G 22X1/2 Female Coupling	Classic	Doncaster
45222	T2/T270G 22X3/4 Female Coupling	Classic	Doncaster
45222H	T2/T270G 22X3/4 Female Coupling	Classic	Doncaster
45223	T2/T270G 22X1 Female Coupling	Classic	Doncaster
45223H	T2/T270G 22X1 FEMALE COUPLING	Classic	Doncaster
45224	T2/T270G 28X3/4 Female Coupling	Classic	Doncaster
45224H	T2/T270G 28X3/4 FEMALE COUPLING	Classic	Doncaster
45225	T2/T270G 28X1 Female Coupling	Classic	Doncaster
45225H	T2/T270G 28x1 Female Coupling	Classic	Doncaster
45250	T3T/T243G 10X3/8 Male Coupling	Classic	Doncaster
45251	T3T/T243G 10X3/8 Male Coupling CP	Classic	Doncaster
45252	T3T/T243G 10X1/2 Male Coupling	Classic	Doncaster
45253	T3T/T243G 10X1/2 Male Coupling CP	Classic	Doncaster
45254	T3T/T243G 12X3/8 Male Coupling	Classic	Doncaster
45254H	T3T/T243G 12X3/8 MALE COUPLING	Classic	Doncaster
45255	T3T/T243G 12X3/8 Male Cplg CP	Classic	Doncaster
45256	T3T/T243G 12X1/2 Male Coupling	Classic	Doncaster
45256H	T3T/T243G 12x1/2 Male Coupling	Classic	Doncaster

First Issued: 1945-10-02

Latest Issue: 2017-09-11

Page: 26 of 52

This certificate has been issued by and remains the property of BSI Assurance UK Ltd, Kitemark Court, Davy Avenue, Knowlhill, Milton Keynes MK5 8PP, United Kingdom and should be returned immediately upon request.

To check its validity telephone +44 (0) 345 080 9000. An electronic certificate can be authenticated [online](#).

BSI Assurance UK Limited, registered in England under number 7805321 at 389 Chiswick High Road, London W4 4AL, UK.  
A member of BSI Group of Companies.

# Kitemark™ Certificate

No. KM 15121

Reference number	Description	Branding	Production site
45257	T3T/T243G 12X1/2 Male Coupling CP	Classic	Doncaster
45260	T3T/T243G (ita) 14x1/2	Classic	Doncaster
45265	T3T/T243G 15X3/8 Male Coupling	Classic	Doncaster
45265H	T3T/T243G 15x3/8 Male Coupling	Classic	Doncaster
45266	T3T/T243G 15X3/8 Male Coupling CP	Classic	Doncaster
45267	T3T/T243G 15X1/2 Male Coupling	Classic	Doncaster
45267H	T3T/T243G 15X1/2 Male Coupling	Classic	Doncaster
45268	T3T/T243G 15X1/2 Male Coupling CP	Classic	Doncaster
45269	T3T/T243G (ita) 16x1/2	Classic	Doncaster
45286	T3T/T243G 18X1/2 Male Coupling	Classic	Doncaster
45286H	T3T/T243G 18X1/2 Male Coupling	Classic	Doncaster
45288	T3T/T243G 18X3/4 Male Coupling	Classic	Doncaster
45288H	T3T/T243G 18X3/4 Male Coupling	Classic	Doncaster
45290	T3T/T243G 22X1/2 Male Coupling	Classic	Doncaster
45290H	T3T/T243G 22X1/2 Male Coupling	Classic	Doncaster
45292	T3T/T243G 22X3/4 Male Coupling	Classic	Doncaster
45292H	T3T/T243G 22X3/4 Male Coupling	Classic	Doncaster
45294	T3T/T243G 22X1 Male Coupling	Classic	Doncaster
45294H	T3T/T243G 22x1 Male Coupling	Classic	Doncaster
45296	T3T/T243G 28X1 Male Coupling	Classic	Doncaster
45296H	T3T/T243G 28X1 Male Coupling	Classic	Doncaster
45349	T3P/T243G 10X1/2	Classic	Doncaster
45350	T3P 12X3/8 Male Coupling	Classic	Doncaster
45354	T3P/T243P 14X3/8 Male Coupling	Classic	Doncaster
45356	T3P 14X1/2 Male Coupling	Classic	Doncaster
45358	T3P 15X1/2 Male Coupling	Classic	Doncaster
45362	T3P/T243G 16X1/2 Male	Classic	Doncaster
45364	T3P 22 X 1/2 Male Coupling	Classic	Doncaster

First Issued: 1945-10-02

Latest Issue: 2017-09-11

Page: 27 of 52

This certificate has been issued by and remains the property of BSI Assurance UK Ltd, Kitemark Court, Davy Avenue, Knowlhill, Milton Keynes MK5 8PP, United Kingdom and should be returned immediately upon request.

To check its validity telephone +44 (0) 345 080 9000. An electronic certificate can be authenticated [online](#).

BSI Assurance UK Limited, registered in England under number 7805321 at 389 Chiswick High Road, London W4 4AL, UK.  
A member of BSI Group of Companies.



# Kitemark™ Certificate

No. KM 15121

Reference number	Description	Branding	Production site
45366	T3P 22X3/4 Male Coupling	Classic	Doncaster
45367	T3P 18x1/2 Male Coupling	Classic	Doncaster
45368	T3P 22X1 Male Coupling	Classic	Doncaster
45370	T3P 28X1 Male Coupling	Classic	Doncaster
45390	T5 15X1/2 Tank Coupling	Classic	Doncaster
45410	T6/T243 12X10 Reducer	Classic	Doncaster
45411	T6/T243 12X10 Reducer CP	Classic	Doncaster
45416	T6/T243 15X10 Reducer	Classic	Doncaster
45417	T6/T243 15X10 Reducer CP	Classic	Doncaster
45418	T6/T243 15X12 Reducer	Classic	Doncaster
45418H	T6/T243 15X12 Reducer	Classic	Doncaster
45419	T6/T243 15X12 Reducer CP	Classic	Doncaster
45424	T6/T243 18x15 Reducer	Classic	Doncaster
45424H	T6/T243 18x15 Reducer	Classic	Doncaster
45425	T6/T243 22X12 Reducer	Classic	Doncaster
45426	T6/T243 22X15 Reducer	Classic	Doncaster
45426H	T6/T243 22X15 Reducer	Classic	Doncaster
45430	T6/T243 22X18 Reducer	Classic	Doncaster
45430H	T6/T243 22X18 Reducer	Classic	Doncaster
45435	T6/T243 28X15 Reducer	Classic	Doncaster
45435H	T6/T243 28X15 REDUCER	Classic	Doncaster
45438	T6/T243 28X22 Reducer	Classic	Doncaster
45438H	T6/T243 28X22 REDUCER	Classic	Doncaster
45491	T12S/T092 10 NCKEL PLATE St Elbow	Classic	Doncaster
45492	T12S/T092 12 Street Elbow	Classic	Doncaster
45492H	T12S/T092 12 Street Elbow	Classic	Doncaster
45493	T12S/T092 CHROME 15x12 St Elbow	Classic	Doncaster
45494	T12S/T092 10X15S Street Red Elbow	Classic	Doncaster

First Issued: 1945-10-02

Latest Issue: 2017-09-11

Page: 28 of 52

This certificate has been issued by and remains the property of BSI Assurance UK Ltd, Kitemark Court, Davy Avenue, Knowlhill, Milton Keynes MK5 8PP, United Kingdom and should be returned immediately upon request.

To check its validity telephone +44 (0) 345 080 9000. An electronic certificate can be authenticated [online](#).

BSI Assurance UK Limited, registered in England under number 7805321 at 389 Chiswick High Road, London W4 4AL, UK.  
A member of BSI Group of Companies.

# Kitemark™ Certificate

No. KM 15121

Reference number	Description	Branding	Production site
45495	T12S/T092 10X15s NP Red Elb	Classic	Doncaster
45496	T12S/T092 15 Street Elbow	Classic	Doncaster
45496H	T12S/T092 15 Street Elbow	Classic	Doncaster
45496R	T12S/T092 15 Street Elbow -Nordic	Classic	Doncaster
45497	T12S/T092 15 NICKEL PLATED Elbow	Classic	Doncaster
45498	T12S/T092 18 Street Elbow	Classic	Doncaster
45498H	T12S/T092 18 Street Elbow	Classic	Doncaster
45500	T12S/T092 22 Street Elbow	Classic	Doncaster
45500H	T12S/T092 22 Street Elbow	Classic	Doncaster
45500R	T12S/T092 22 Street Elbow -Nordic	Classic	Doncaster
45500S	T12S/T092 22 Street Elbow- ROTH	Classic	Doncaster
45502	T12S/T092 28 Street Elbow	Classic	Doncaster
45502H	T12S/T092 28 STREET ELBOW	Classic	Doncaster
45510	T12/T090 10 Elbow	Classic	Doncaster
45511	T12/T090 10 Chrome Elbow	Classic	Doncaster
45512	T12/T090 12 Elbow	Classic	Doncaster
45512H	T12/T090 12 Elbow	Classic	Doncaster
45513	T12/T090 12 Chrome Elbow	Classic	Doncaster
45514	T12/T090 14 Elbow	Classic	Doncaster
45516	T12/T090 15 Elbow	Classic	Doncaster
45516H	T12/T090 15 Elbow	Classic	Doncaster
45516R	T12/T090 15 Elbow - Nordic	Classic	Doncaster
45517	T12/T090 15 Chrome Elbow	Classic	Doncaster
45518	T12/T090 16 Elbow	Classic	Doncaster
45520	T12/T090 18 Elbow	Classic	Doncaster
45520H	T12/T090 18 Elbow	Classic	Doncaster
45522	T12/T090 20 Elbow	Classic	Doncaster
45524	T12/T090 22 Elbow	Classic	Doncaster

First Issued: 1945-10-02

Latest Issue: 2017-09-11

Page: 29 of 52

This certificate has been issued by and remains the property of BSI Assurance UK Ltd, Kitemark Court, Davy Avenue, Knowlhill, Milton Keynes MK5 8PP, United Kingdom and should be returned immediately upon request.

To check its validity telephone +44 (0) 345 080 9000. An electronic certificate can be authenticated [online](#).

BSI Assurance UK Limited, registered in England under number 7805321 at 389 Chiswick High Road, London W4 4AL, UK.  
A member of BSI Group of Companies.

# Kitemark™ Certificate

No. KM 15121

Reference number	Description	Branding	Production site
45524H	T12/T090 22 Elbow	Classic	Doncaster
45524R	T12/T090 22 Elbow - Nordic	Classic	Doncaster
45524S	T12/T090 22 Elbow - ROTH	Classic	Doncaster
45526	T12/T090 28 Elbow	Classic	Doncaster
45526H	T12/T090 28 Elbow	Classic	Doncaster
45528	T21S/T040 12 Obtuse Street Elbow	Classic	Doncaster
45531	T21/T041 12 Obtuse Elbow	Classic	Doncaster
45535	T21/T041 15 Obtuse Elbow	Classic	Doncaster
45535H	T21/T041 15 Obtuse Elbow	Classic	Doncaster
45537	T21/T041 18mm Obtuse Elbow	Classic	Doncaster
45537H	T21/T041 18MM OBTUSE ELBOW	Classic	Doncaster
45538	T21/T041 22 Obtuse Elbow	Classic	Doncaster
45538H	T21/T041 22 OBTUSE ELBOW	Classic	Doncaster
45539	T21/T041 28 Obtuse Elbow	Classic	Doncaster
45539H	T21/T041 28 OBTUSE ELBOW	Classic	Doncaster
45542	T21S/T040 15 Obtuse Street Elbow	Classic	Doncaster
45542H	T21S/T040 15 OBTUSE STREET ELBOW	Classic	Doncaster
45544	T21S/T040 18 Obtuse Street Elbow	Classic	Doncaster
45545	T21S/T040 22 Obtuse Street Elbow	Classic	Doncaster
45545H	T21S/T040 22 OBTUSE STREET ELBOW	Classic	Doncaster
45546	T21S/T040 28 Obtuse Street Elbow	Classic	Doncaster
45551	T13/T092G 10X3/8 Male Elbow CP	Classic	Doncaster
45552	T13/T092G 10X1/2 Male Elbow	Classic	Doncaster
45554	T13/T092G 12X3/8 Male Elbow	Classic	Doncaster
45555	T13/T092G 12X3/8 Male Elbow CP	Classic	Doncaster
45556	T13/T092G 12X1/2 Male Elbow	Classic	Doncaster
45557	T13/T092G 12X1/2 Male Elbow CP	Classic	Doncaster
45560	T13/T092 14X1/2 Male Elbow	Classic	Doncaster

First Issued: 1945-10-02

Latest Issue: 2017-09-11

Page: 30 of 52

This certificate has been issued by and remains the property of BSI Assurance UK Ltd, Kitemark Court, Davy Avenue, Knowlhill, Milton Keynes MK5 8PP, United Kingdom and should be returned immediately upon request.

To check its validity telephone +44 (0) 345 080 9000. An electronic certificate can be authenticated [online](#).

BSI Assurance UK Limited, registered in England under number 7805321 at 389 Chiswick High Road, London W4 4AL, UK.  
A member of BSI Group of Companies.

# Kitemark™ Certificate

No. KM 15121

Reference number	Description	Branding	Production site
45561	T13/T092G 15X1/2 Male Elbow	Classic	Doncaster
45561H	T13/T092G 15X1/2 Male Elbow	Classic	Doncaster
45562	T13/T092G 15X1/2 Male Elbow CP	Classic	Doncaster
45563	T13/T092G 16X1/2 Male Elbow	Classic	Doncaster
45564	T13/T092G 16X3/4 Male Elbow	Classic	Doncaster
45569	T13/T092G 18X1/2 Male Elbow	Classic	Doncaster
45569H	T13/T092G 18X1/2 MALE ELBOW	Classic	Doncaster
45570	T13/T092G 18X3/4 Male Elbow	Classic	Doncaster
45576	T13/T092G 22X3/4 Male Elbow	Classic	Doncaster
45578	T13/T092G 28X1 Male Elbow	Classic	Doncaster
45578H	T13/T092G 28X1 MALE ELBOW	Classic	Doncaster
45591	T14/T090G 10X3/8 Female Elbow CP	Classic	Doncaster
45593	T14/T090G 10X1/2 Female Elbow CP	Classic	Doncaster
45594	T14/T090G 12X3/8 Female Elbow	Classic	Doncaster
45596	T14/T090G 12X1/2 Female Elbow	Classic	Doncaster
45596H	T14/T090G 12X1/2 FEMALE ELBOW	Classic	Doncaster
45597	T14/T090G 12X1/2 Female Elbow CP	Classic	Doncaster
45600	T14/T090G 14X1/2 Female Elbow	Classic	Doncaster
45606	T14/T090G 15X1/2 Female Elbow	Classic	Doncaster
45606H	T14/T090G 15X1/2 Female Elbow	Classic	Doncaster
45607	T14/T090G 15X1/2 Female Elbow CP	Classic	Doncaster
45608	T14/T090G 16X1/2 Female Elbow	Classic	Doncaster
45614	T14/T090G 18X1/2 Female Elbow	Classic	Doncaster
45614H	T14/T090G 18X1/2 FEMALE ELBOW	Classic	Doncaster
45615	T14/T090G 18X3/4 Female Elbow	Classic	Doncaster
45620	T14/T090G 22X3/4 Female Elbow	Classic	Doncaster
45620H	T14/T090G 22X3/4 FEMALE ELBOW	Classic	Doncaster
45622	T14/T090G 28X1 Female Elbow	Classic	Doncaster

First Issued: 1945-10-02

Latest Issue: 2017-09-11

Page: 31 of 52

This certificate has been issued by and remains the property of BSI Assurance UK Ltd, Kitemark Court, Davy Avenue, Knowlhill, Milton Keynes MK5 8PP, United Kingdom and should be returned immediately upon request.

To check its validity telephone +44 (0) 345 080 9000. An electronic certificate can be authenticated [online](#).

# Kitemark™ Certificate

No. KM 15121

Reference number	Description	Branding	Production site
45631	T15/T471G 10X1/2 B-Plate Elb CP	Classic	Doncaster
45638	T15/T471G 12X1/2 Back Plate Elbow	Classic	Doncaster
45638H	T15/T471G 12x1/2 Back plate Elbow	Classic	Doncaster
45639	T15/T471G 12X1/2 B-Plate Elbow CP	Classic	Doncaster
45640	T15/T471G 14X1/2 Back Plate Elbow	Classic	Doncaster
45646	T15/T471G 15X1/2 Back Plate Elbow	Classic	Doncaster
45646H	T15/T471G 15X1/2 Back Plate Elbow	Classic	Doncaster
45647	T15/T471G 15X1/2 B-Plate Elbow CP	Classic	Doncaster
45648	T15/T471G 16X1/2 Back Plate Elbow	Classic	Doncaster
45650	T15/T471G 18X1/2 Back Plate Elbow	Classic	Doncaster
45652	T15/T471G 18X3/4 Back Plate Elbow	Classic	Doncaster
45654	T15/T471G 22X3/4 Back Plate Elbow	Classic	Doncaster
45660	T24/T130 10 Equal Tee	Classic	Doncaster
45661	T24/T130 10 Equal Tee CP	Classic	Doncaster
45662	T24/T130 12 Equal Tee	Classic	Doncaster
45663	T24/T130 12 Equal Tee CP	Classic	Doncaster
45664	T24/T130 14 Equal Tee	Classic	Doncaster
45666	T24/T130 15 Equal Tee	Classic	Doncaster
45666H	T24/T130 15 Equal Tee	Classic	Doncaster
45666R	T24/T130 15 Equal Tee - Nordic	Classic	Doncaster
45667	T24/T130 15 Equal Tee CP	Classic	Doncaster
45668	T24/T130 16 Equal Tee	Classic	Doncaster
45670	T24/T130 18 Equal Tee	Classic	Doncaster
45670H	T24/T130 18 Equal Tee	Classic	Doncaster
45674	T24/T130 20 Equal Tee	Classic	Doncaster
45676	T24/T130 22 Equal Tee	Classic	Doncaster
45676H	T24/T130 22 Equal Tee	Classic	Doncaster
45676R	T24/T130 22 Equal Tee - Nordic	Classic	Doncaster

First Issued: 1945-10-02

Latest Issue: 2017-09-11

Page: 32 of 52

This certificate has been issued by and remains the property of BSI Assurance UK Ltd, Kitemark Court, Davy Avenue, Knowlhill, Milton Keynes MK5 8PP, United Kingdom and should be returned immediately upon request.  
To check its validity telephone +44 (0) 345 080 9000. An electronic certificate can be authenticated [online](#).

BSI Assurance UK Limited, registered in England under number 7805321 at 389 Chiswick High Road, London W4 4AL, UK.  
A member of BSI Group of Companies.

# Kitemark™ Certificate

No. KM 15121

Reference number	Description	Branding	Production site
45678	T24/T130 28 Equal Tee	Classic	Doncaster
45678H	T24/T130 28 EQUAL TEE	Classic	Doncaster
45701	T25 12X12X10/T130 12X10X12 TeeCP	Classic	Doncaster
45710	T25 14X14X12 / T130 14X12X14 Tee	Classic	Doncaster
45715	T25 15X15X10 / T130 15X10X15 Tee	Classic	Doncaster
45717	T25 15X15X12 / T130 15X12X15 Tee	Classic	Doncaster
45717H	T25 15X15X12 / T130 15X12X15 TEE	Classic	Doncaster
45718	T25 15X15X12/T130 15X12X15 TeeCP	Classic	Doncaster
45719	T25 16X16X12 / T130 16X12X16 Tee	Classic	Doncaster
45722	T25 16X16X14 / T130 16X14X16 Tee	Classic	Doncaster
45724	T25 18X18X14 / T130 18X14X18 Tee	Classic	Doncaster
45726	T25 20X20X16 / T130 20X16X20 Tee	Classic	Doncaster
45730	T25 22X22X10 / T130 22X10X22 Tee	Classic	Doncaster
45736	T25 22X22X14 / T130 22X14X22 Tee	Classic	Doncaster
45737	T25 22X22X15 / T130 22X15X22 Tee	Classic	Doncaster
45737H	T25 22X22x15/T130 22x15x22 Tee	Classic	Doncaster
45742	T25 22X22X18 / T130 22X18X22 Tee	Classic	Doncaster
45744	T25 28X28X15 / T130 28X15X28 Tee	Classic	Doncaster
45745	T25 28X28X18 / T130 28X18X28 Tee	Classic	Doncaster
45746	T25 28X28X22 / T130 28X22X28 Tee	Classic	Doncaster
45746H	T25 28X28X22 / T130 28X22X28 TEE	Classic	Doncaster
45780	T26 15X10X15 / T130 15X15X10 Tee	Classic	Doncaster
45786	T26 22X15X22 / T130 22X22X15 Tee	Classic	Doncaster
45786H	T26 22X15X22 / T130 22X22X15 Tee	Classic	Doncaster
45790	T26 28X15X28 / T130 28X28X15 Tee	Classic	Doncaster
45793	T26 28X22X28 / T130 28X28X22 Tee	Classic	Doncaster
45810	T27/T130 15X10X10 Tee Red EndBch	Classic	Doncaster
45812	T27/T130 15X12X12 Tee Red EndBch	Classic	Doncaster

First Issued: 1945-10-02

Latest Issue: 2017-09-11

Page: 33 of 52

This certificate has been issued by and remains the property of BSI Assurance UK Ltd, Kitemark Court, Davy Avenue, Knowlhill, Milton Keynes MK5 8PP, United Kingdom and should be returned immediately upon request.

To check its validity telephone +44 (0) 345 080 9000. An electronic certificate can be authenticated [online](#).

BSI Assurance UK Limited, registered in England under number 7805321 at 389 Chiswick High Road, London W4 4AL, UK.  
A member of BSI Group of Companies.

# Kitemark™ Certificate

No. KM 15121

Reference number	Description	Branding	Production site
45813	T27/T130 15X12X12 Tee Red EndBrCP	Classic	Doncaster
45820	T27/T130 22X15X15 Tee Red EndBch	Classic	Doncaster
45820H	T27/T130 22X15X15 TEE RED END BCH	Classic	Doncaster
45820R	T27/T130 22x15x15 Tee - Nordic	Classic	Doncaster
45822	T27/T130 28X22X22 Tee Red EndBch	Classic	Doncaster
45823	T30 12X12X1/2F/T130G 12X1/2FX12	Classic	Doncaster
45825	T30 16X16X1/2F/T130G 16X1/2FX16	Classic	Doncaster
45840	T30 15X15X1/2F/T130G 15X1/2FX15	Classic	Doncaster
45840H	T30 15x15x1/2/T130G 15x1/2Fx15	Classic	Doncaster
45841	T30 15X15X1/2F/T130G 15X1/2FX15CP	Classic	Doncaster
45845	T30 22X22X1/2F/T130G 22X1/2FX22	Classic	Doncaster
45845H	T30 22X22X1/2F/T130G 22X1/2FX22	Classic	Doncaster
45846	T30 22X22X3/4F/T130G 22X3/4FX22	Classic	Doncaster
45846H	T30 22X22X3/4F/T130G 22X3/4FX22	Classic	Doncaster
45860	T61/T301 10 Stopend	Classic	Doncaster
45861	T61/T301 10 Stopend CP	Classic	Doncaster
45862	T61/T301 12 Stopend	Classic	Doncaster
45862H	T61/T301 12 Stopend	Classic	Doncaster
45864	T61/T301 14 Stopend	Classic	Doncaster
45866	T61/T301 15 Stopend	Classic	Doncaster
45866H	T61/T301 15 Stopend	Classic	Doncaster
45867	T61/T301 15 Stopend CP	Classic	Doncaster
45868	T61/T301 16 Stopend	Classic	Doncaster
45870	T61/T301 18 Stopend	Classic	Doncaster
45870H	T61/T301 18 Stopend	Classic	Doncaster
45872	T61/T301 20 Stopend	Classic	Doncaster
45874	T61/T301 22 Stopend	Classic	Doncaster
45874H	T61/T301 22 Stopend	Classic	Doncaster

First Issued: 1945-10-02

Latest Issue: 2017-09-11

Page: 34 of 52

This certificate has been issued by and remains the property of BSI Assurance UK Ltd, Kitemark Court, Davy Avenue, Knowlhill, Milton Keynes MK5 8PP, United Kingdom and should be returned immediately upon request.

To check its validity telephone +44 (0) 345 080 9000. An electronic certificate can be authenticated [online](#).

BSI Assurance UK Limited, registered in England under number 7805321 at 389 Chiswick High Road, London W4 4AL, UK.  
A member of BSI Group of Companies.

# Kitemark™ Certificate

No. KM 15121

Reference number	Description	Branding	Production site
45876	T61/T301 28 Stopend	Classic	Doncaster
45876H	T61/T301 28 Stopend	Classic	Doncaster
45890	T61RV/T302 10 Air Release Valve	Classic	Doncaster
45891	T61RV/T302 12 Air Release Valve	Classic	Doncaster
45892	T61RV/T302 15 Air Release Valve	Classic	Doncaster
45892H	T61RV/T302 15 Air Release Valve	Classic	Doncaster
45893	T61RV/T302 18 Air Release Valve	Classic	Doncaster
45894	T61RV/T302 22 Air Release Valve	Classic	Doncaster
45895	T61RV/T302 28 Air Release Valve	Classic	Doncaster
45900	T62/T062 10X1/2 St Tap Connector	Classic	Doncaster
45902	T62/T062 15X1/2 St Tap Connector	Classic	Doncaster
45903	T62/T062 22x3/4 Tap Connector	Classic	Doncaster
45910	T62S 15X1/2 St Tap Connector	Classic	Doncaster
45912	T62S 15X3/4 St Tap Connector	Classic	Doncaster
45914	T62S 22X3/4 St Tap Connector	Classic	Doncaster
45922	T63 /T063 15X1/2 Bent Tap Connect	Classic	Doncaster
45923	T63 15X3/4 Bent Tap Connector	Classic	Doncaster
45924	T63 /T063 22X3/4 Bent Tap Connect	Classic	Doncaster
45925	15mm PF x 1/2 straight tap CON	Classic	Doncaster
45926	15mm PF x 1/2 elbow tap CON	Classic	Doncaster
45927	22mm PF x 3/4 straight tap CON	Classic	Doncaster

First Issued: 1945-10-02

Latest Issue: 2017-09-11

Page: 35 of 52

This certificate has been issued by and remains the property of BSI Assurance UK Ltd, Kitemark Court, Davy Avenue, Knowlhill, Milton Keynes MK5 8PP, United Kingdom and should be returned immediately upon request.

To check its validity telephone +44 (0) 345 080 9000. An electronic certificate can be authenticated [online](#).

BSI Assurance UK Limited, registered in England under number 7805321 at 389 Chiswick High Road, London W4 4AL, UK.  
A member of BSI Group of Companies.



# Kitemark™ Certificate

No. KM 15121

Reference number	Description and Size	Branding	Production site
75500	TT1/TT270 10mm Coupling	Sprint	Doncaster
75501	TT1/TT270 15mm Coupling	Sprint	Doncaster
75502	TT1/TT270 22mm Coupling	Sprint	Doncaster
75503	TT1/TT270 28mm Coupling	Sprint	Doncaster
75504	TT1R/TT240 15x10mm Red Coupling	Sprint	Doncaster
75505	TT1R/TT240 22x15mm Red Coupling	Sprint	Doncaster
75510	TT2/TT270G 15X1/2 FEMALE CPLNG	Sprint	Doncaster
75511	TT2/TT270G 22X3/4 FEMALE CPLNG	Sprint	Doncaster
75682G	TT3/TT243G 12X1/2 MALE TROX	Sprint	Doncaster
75515	TT3/TT243G 15X1/2 MALE COUPLING	Sprint	Doncaster
75516	TT3/TT243G 22X3/4 MALE COUPLING	Sprint	Doncaster
75518	TT3/TT243G 28X1 MALE COUPLING	Sprint	Doncaster
75520	TT5 15X1/2 TANK COUPLING	Sprint	Doncaster
75521	TT5 22x3/4 Tank Coupling	Sprint	Doncaster
75523	TT6/TT243 15x10mm Reducer	Sprint	Doncaster
75524	TT6/TT243 15x12mm Reducer	Sprint	Doncaster
75525	TT6/TT243 22x15mm Reducer	Sprint	Doncaster
75526	TT6/TT243 28x15mm Reducer	Sprint	Doncaster
75527	TT6/TT243 28x22mm Reducer	Sprint	Doncaster
75530	TT12/TT090 10mm Elbow	Sprint	Doncaster
75531	TT12/TT090 15mm Elbow	Sprint	Doncaster
75532	TT12/TT090 22mm Elbow	Sprint	Doncaster
75533	TT12/TT090 28mm Elbow	Sprint	Doncaster
75535	TT12S/TT092 10mm Street Elbow	Sprint	Doncaster
75536	TT12S/TT092 10x15S Strt Red Elbow	Sprint	Doncaster
75537	TT12S/TT092 15mm Street Elbow	Sprint	Doncaster
75538	TT12S/TT092 22mm Street Elbow	Sprint	Doncaster
75540	TT13/TT092G 15X1/2 MALE ELBOW	Sprint	Doncaster

First Issued: 1945-10-02

Latest Issue: 2017-09-11

Page: 36 of 52

This certificate has been issued by and remains the property of BSI Assurance UK Ltd, Kitemark Court, Davy Avenue, Knowlhill, Milton Keynes MK5 8PP, United Kingdom and should be returned immediately upon request.

To check its validity telephone +44 (0) 345 080 9000. An electronic certificate can be authenticated [online](#).

BSI Assurance UK Limited, registered in England under number 7805321 at 389 Chiswick High Road, London W4 4AL, UK.  
A member of BSI Group of Companies.

# Kitemark™ Certificate

No. KM 15121

Reference number	Description and Size	Branding	Production site
75545	TT14/TT090G 15X1/2 FEMALE ELBOW	Sprint	Doncaster
75548	TT15/TT471G 12X1/2 BACKPLATE ELB	Sprint	Doncaster
75550	TT15/TT471G 15X1/2 BACKPLATE ELB	Sprint	Doncaster
75551	TT21/TT041 15mm Obtuse Elbow	Sprint	Doncaster
75552	TT21/TT041 22mm Obtuse Elbow	Sprint	Doncaster
75553	TT21/TT041 28mm Obtuse Elbow	Sprint	Doncaster
75555	TT24/TT130 10mm Equal Tee	Sprint	Doncaster
75556	TT24/TT130 15mm Equal Tee	Sprint	Doncaster
75557	TT24/TT130 22mm Equal Tee	Sprint	Doncaster
75558	TT24/TT130 28mm Equal Tee	Sprint	Doncaster
75565	TT25 15x15x10 /TT130 15x10x15 Tee	Sprint	Doncaster
75566	TT25 22x22x10/TT130 22x10x22 Tee	Sprint	Doncaster
75567	TT25 22x22x15/TT130 22x15x22 Tee	Sprint	Doncaster
75568	TT25 28x28x15/TT130 28x15x28 Tee	Sprint	Doncaster
75569	TT25 28x28x22 /TT130 28x22x28 Tee	Sprint	Doncaster
75573	TT26 22x15x22/TT130 22x22x15 Tee	Sprint	Doncaster
75574	TT26 28x15x28/TT130 28x28x15 Tee	Sprint	Doncaster
75575	TT26 28x22x28/TT130 28x28x22 Tee	Sprint	Doncaster
75582	TT27/TT130 22x15x15 Tee RedEndBch	Sprint	Doncaster
75584	TT27/TT130 28x22x22 Tee RedEndBch	Sprint	Doncaster
75585	TT21S/TT040 15mm Obtuse Street El	Sprint	Doncaster
75586	TT21S/TT040 22mm Obtuse Street El	Sprint	Doncaster
75587	TT21S/TT040 28mm Obtuse Street El	Sprint	Doncaster
75590	TT61/TT301 10mm Stop End	Sprint	Doncaster
75591	TT61/TT301 15mm Stop End	Sprint	Doncaster
75592	TT61/TT301 22mm Stop End	Sprint	Doncaster
75593	TT61/TT301 28mm Stop End	Sprint	Doncaster
75600	TT62/TT062 10MMX1/2 STR TAP CONN	Sprint	Doncaster

First Issued: 1945-10-02

Latest Issue: 2017-09-11

Page: 37 of 52

This certificate has been issued by and remains the property of BSI Assurance UK Ltd, Kitemark Court, Davy Avenue, Knowlhill, Milton Keynes MK5 8PP, United Kingdom and should be returned immediately upon request.

To check its validity telephone +44 (0) 345 080 9000. An electronic certificate can be authenticated [online](#).

BSI Assurance UK Limited, registered in England under number 7805321 at 389 Chiswick High Road, London W4 4AL, UK.  
A member of BSI Group of Companies.

# Kitemark™ Certificate

No. KM 15121

Reference number	Description and Size	Branding	Production site
75601	TT62/TT062 15MMX1/2 STR TAP CONN	Sprint	Doncaster
75603	TT62/TT062 22MMX3/4 STR TAP CONN	Sprint	Doncaster
75604	TT63/TT063 10X1/2 BENT TAP CONN	Sprint	Doncaster
75605	TT63/TT063 15X1/2 BENT TAP CONN	Sprint	Doncaster
75660	TT1/TT270 12mm Coupling	Sprint	Doncaster
75661	TT1/TT270 14mm Coupling	Sprint	Doncaster
75662	TT1/TT270 16mm Coupling	Sprint	Doncaster
75663	TT1/TT270 18mm Coupling	Sprint	Doncaster
75664	TT1R/TT240 14x12mm Red Coupling	Sprint	Doncaster
75665	TT1R/TT240 15x12mm Red Coupling	Sprint	Doncaster
75667	TT1R/TT240 16x14mm Red Coupling	Sprint	Doncaster
75668	TT1R/TT240 18x15mm Red Coupling	Sprint	Doncaster
75671	TT1R/TT240 22x18mm Red Coupling	Sprint	Doncaster
75673	TT2/TT270G 12X1/2 FEMALE CPLNG	Sprint	Doncaster
75674	TT2/TT270G 14X3/8 FEMALE CPLNG	Sprint	Doncaster
75675	TT2/TT270G 14X1/2 FEMALE CPLNG	Sprint	Doncaster
75676	TT2/TT270G 16X1/2 FEMALE CPLNG	Sprint	Doncaster
75677	TT2/TT270G 18X1/2 FEMALE CPLNG	Sprint	Doncaster
75678	TT2/TT270G 28X1 FEMALE CPLNG	Sprint	Doncaster
75679	TT3/TT243G 10x3/8 Male Coupling	Sprint	Doncaster
75680	TT3/TT243G 10X1/2 MALE COUPLING	Sprint	Doncaster
75681	TT3/TT243G 12X3/8 MALE COUPLING	Sprint	Doncaster
75682	TT3/TT243G 12X1/2 MALE COUPLING	Sprint	Doncaster
75683	TT3/TT243G 14X3/8 MALE COUPLING	Sprint	Doncaster
75684	TT3/TT243G 14X1/2 MALE COUPLING	Sprint	Doncaster
75685	TT3/TT243G 16X1/2 MALE COUPLING	Sprint	Doncaster
75687	TT3/TT243G 18X3/4 MALE COUPLING	Sprint	Doncaster
75689	TT12/TT090 12mm Elbow	Sprint	Doncaster

First Issued: 1945-10-02

Latest Issue: 2017-09-11

Page: 38 of 52

This certificate has been issued by and remains the property of BSI Assurance UK Ltd, Kitemark Court, Davy Avenue, Knowlhill, Milton Keynes MK5 8PP, United Kingdom and should be returned immediately upon request.

To check its validity telephone +44 (0) 345 080 9000. An electronic certificate can be authenticated [online](#).

BSI Assurance UK Limited, registered in England under number 7805321 at 389 Chiswick High Road, London W4 4AL, UK.  
A member of BSI Group of Companies.

# Kitemark™ Certificate

No. KM 15121

Reference number	Description and Size	Branding	Production site
75690	TT12/TT090 14mm Elbow	Sprint	Doncaster
75691	TT12/TT090 16mm Elbow	Sprint	Doncaster
75692	TT12/TT090 18mm Elbow	Sprint	Doncaster
75693	TT12S/TT092 12mm Street Elbow	Sprint	Doncaster
75695	TT12S/TT092 16mm Street Elbow	Sprint	Doncaster
75696	TT12S/TT092 18mm Street Elbow	Sprint	Doncaster
75697	TT14/TT090G 14X1/2 FEMALE ELBOW	Sprint	Doncaster
75698	TT14/TT090G 16X1/2 FEMALE ELBOW	Sprint	Doncaster
75703	TT21/TT041 16mm Obtuse Elbow	Sprint	Doncaster
75704	TT21/TT041 18mm Obtuse Elbow	Sprint	Doncaster
75705	TT21S/TT040 12mm Obtuse Street El	Sprint	Doncaster
75708	TT21S/TT040 18mm Obtuse Street El	Sprint	Doncaster
75709	TT24/TT130 12mm Equal Tee	Sprint	Doncaster
75710	TT24/TT130 14mm Equal Tee	Sprint	Doncaster
75712	TT24/TT130 18mm Equal Tee	Sprint	Doncaster
75714	TT25 15x15x12/TT130 15x12x15 Tee	Sprint	Doncaster
75719	TT25 18x18x15/TT130 18x15x18 Tee	Sprint	Doncaster
75722	TT25 22x22x18/TT130 22x18x22 Tee	Sprint	Doncaster
75724	TT26 15x12x15/TT130 15x15x12 Tee	Sprint	Doncaster
75731	TT61/TT301 12mm Stop End	Sprint	Doncaster
75732	TT61/TT301 14mm Stop End	Sprint	Doncaster
75733	TT61/TT301 16mm Stop End	Sprint	Doncaster
75734	TT61/TT301 18mm Stop End	Sprint	Doncaster
75736	TT62/TT062 12MMX3/8 STR TAP CONN	Sprint	Doncaster
75740	TT62/TT062 16mmx3/4 Str Tap Conn	Sprint	Doncaster
75741	TT62 18x1/2 Tap Connector	Sprint	Doncaster
75831	TT14/TT090G 22x3/4 Female Elbow	Sprint	Doncaster
75833	TT13/TT092G 22x3/4 Male Elbow	Sprint	Doncaster

First Issued: 1945-10-02

Latest Issue: 2017-09-11

Page: 39 of 52

This certificate has been issued by and remains the property of BSI Assurance UK Ltd, Kitemark Court, Davy Avenue, Knowlhill, Milton Keynes MK5 8PP, United Kingdom and should be returned immediately upon request.

To check its validity telephone +44 (0) 345 080 9000. An electronic certificate can be authenticated [online](#).

BSI Assurance UK Limited, registered in England under number 7805321 at 389 Chiswick High Road, London W4 4AL, UK.  
A member of BSI Group of Companies.

# Kitemark™ Certificate

No. KM 15121

Reference number	Description and Size	Branding	Production site
75835	TT2/TT270G 18x3/4 Strt Female Con	Sprint	Doncaster
75838	TT1CP/TT270 15mm Coupling	Sprint	Doncaster
75839	TT1CP/TT270 22mm Coupling	Sprint	Doncaster
75840	TT1RCP/TT240 15x10mm Red Coupling	Sprint	Doncaster
75843	TT2CP/TT270G 15X1/2 FEMALE COUP	Sprint	Doncaster
75845	TT3CP/TT243G 12x3/8" Male Coup	Sprint	Doncaster
75847	TT3CP/TT243G 15X1/2 MALE COUP	Sprint	Doncaster
75850	TT6CP/TT243 22x15mm Reducer	Sprint	Doncaster
75852	TT12CP/TT090 12mm Elbow	Sprint	Doncaster
75853	TT12CP/TT090 15mm Elbow	Sprint	Doncaster
75854	TT12CP/TT090 22mm Elbow	Sprint	Doncaster
75861	TT24CP/TT130 15mm Equal Tee	Sprint	Doncaster
75862	TT24CP/TT130 22mm Equal Tee	Sprint	Doncaster
75865	TT25CP 22x22x15/TT130 22x15x22 T	Sprint	Doncaster
75868	TT61CP/TT301 15mm Stop End	Sprint	Doncaster
75869	TT26CP 22x15x22/TT130 22x22x15 T	Sprint	Doncaster
75870	TT27CP/TT130 22x15x15 RedEndBch	Sprint	Doncaster
75900	TT1 35mm Coupling	Sprint	Doncaster
75901	TT1 42mm Coupling	Sprint	Doncaster
75902	TT1 54mm Coupling	Sprint	Doncaster
75903	TT2/TT270G 35 x 1 1/4 Str Fem Con	Sprint	Doncaster
75904	TT2/TT270G 42 x 1 1/2 Str Fem Con	Sprint	Doncaster
75905	TT2/TT270G 54 x 2 Str Fem Con	Sprint	Doncaster
75906	TT3 35 x 1 1/4 Str Male Con	Sprint	Doncaster
75907	TT3 42 x 1 1/2 Str Male Con	Sprint	Doncaster
75908	TT3 54 x 2 Str Male Con	Sprint	Doncaster
75909	TT6 35x15mm Reducer	Sprint	Doncaster
75910	TT6 35x22mm Reducer	Sprint	Doncaster

First Issued: 1945-10-02

Latest Issue: 2017-09-11

Page: 40 of 52

This certificate has been issued by and remains the property of BSI Assurance UK Ltd, Kitemark Court, Davy Avenue, Knowlhill, Milton Keynes MK5 8PP, United Kingdom and should be returned immediately upon request.

To check its validity telephone +44 (0) 345 080 9000. An electronic certificate can be authenticated [online](#).

BSI Assurance UK Limited, registered in England under number 7805321 at 389 Chiswick High Road, London W4 4AL, UK.  
A member of BSI Group of Companies.

# Kitemark™ Certificate

No. KM 15121

Reference number	Description and Size	Branding	Production site
75911	TT6 35x28mm Reducer	Sprint	Doncaster
75913	TT6 42x22mm Reducer	Sprint	Doncaster
75914	TT6 42x28mm Reducer	Sprint	Doncaster
75915	TT6 42x35mm Reducer	Sprint	Doncaster
75917	TT6 54x22mm Reducer	Sprint	Doncaster
75918	TT6 54x28mm Reducer	Sprint	Doncaster
75919	TT6 54x35mm Reducer	Sprint	Doncaster
75920	TT6 54x42mm Reducer	Sprint	Doncaster
75921	TT12 35mm Elbow	Sprint	Doncaster
75922	TT12 42mm Elbow	Sprint	Doncaster
75923	TT12 54mm Elbow	Sprint	Doncaster
75924	TT12S 35mm Street Elbow	Sprint	Doncaster
75925	TT12S 42mm Street Elbow	Sprint	Doncaster
75926	TT12S 54mm Street Elbow	Sprint	Doncaster
75927	TT21 35mm Obtuse Elbow	Sprint	Doncaster
75928	TT21 42mm Obtuse Elbow	Sprint	Doncaster
75929	TT21 54mm Obtuse Elbow	Sprint	Doncaster
75930	TT21S 35mm Obtuse Street Elbow	Sprint	Doncaster
75931	TT21S 42mm Obtuse Street Elbow	Sprint	Doncaster
75932	TT21S 54mm Obtuse Street Elbow	Sprint	Doncaster
75933	TT24 35mm Equal Tee	Sprint	Doncaster
75934	TT24 42mm Equal Tee	Sprint	Doncaster
75935	TT24 54mm Equal Tee	Sprint	Doncaster
75936	TT25 35x35x15mm Tee	Sprint	Doncaster
75937	TT25 35x35x22mm Tee	Sprint	Doncaster
75938	TT25 35x35x28mm Tee	Sprint	Doncaster
75939	TT25 42x42x15mm Tee	Sprint	Doncaster
75940	TT25 42x42x22mm Tee	Sprint	Doncaster

First Issued: 1945-10-02

Latest Issue: 2017-09-11

Page: 41 of 52

This certificate has been issued by and remains the property of BSI Assurance UK Ltd, Kitemark Court, Davy Avenue, Knowlhill, Milton Keynes MK5 8PP, United Kingdom and should be returned immediately upon request.

To check its validity telephone +44 (0) 345 080 9000. An electronic certificate can be authenticated [online](#).

BSI Assurance UK Limited, registered in England under number 7805321 at 389 Chiswick High Road, London W4 4AL, UK.  
A member of BSI Group of Companies.

# Kitemark™ Certificate

No. KM 15121

Reference number	Description and Size	Branding	Production site
75941	TT25 42x42x28mm Tee	Sprint	Doncaster
75942	TT25 42x42x35mm Tee	Sprint	Doncaster
75944	TT25 54x54x22mm Tee	Sprint	Doncaster
75946	TT25 54x54x35mm Tee	Sprint	Doncaster
75947	TT25 54x54x42mm Tee	Sprint	Doncaster
75949	TT26 35x22x35mm Tee	Sprint	Doncaster
75950	TT26 35x28x35mm Tee	Sprint	Doncaster
75954	TT27 35x22x22mm Tee	Sprint	Doncaster
75955	TT27 35x28x28mm Tee	Sprint	Doncaster
75957	TT27 42x35x35mm Tee	Sprint	Doncaster
75958	TT27 54x42x42mm Tee	Sprint	Doncaster
75959	TT30 35x35x1/2 Fl Tee	Sprint	Doncaster
75960	TT30 42x1/2 Fl Tee	Sprint	Doncaster
75961	TT30 54x1/2 Fl Tee	Sprint	Doncaster
75965	TT69 35 x 1.1/4 Str M/Union	Sprint	Doncaster
75966	TT69 42 x 1.1/2 Str M/Union	Sprint	Doncaster
75967	TT69 54 x 2 Str M/Union	Sprint	Doncaster
75968	TT30 35 x 35x 3/4 FEM Tee	Sprint	Doncaster
75969	TT30 42 x 42 x 3/4 FEM Tee	Sprint	Doncaster
75970	TT30 54 x 54 x 3/4 FEM Tee	Sprint	Doncaster
75971	TT30 54 x 54 x 1 FEM Tee	Sprint	Doncaster

First Issued: 1945-10-02

Latest Issue: 2017-09-11

Page: 42 of 52

This certificate has been issued by and remains the property of BSI Assurance UK Ltd, Kitemark Court, Davy Avenue, Knowlhill, Milton Keynes MK5 8PP, United Kingdom and should be returned immediately upon request.

To check its validity telephone +44 (0) 345 080 9000. An electronic certificate can be authenticated [online](#).

BSI Assurance UK Limited, registered in England under number 7805321 at 389 Chiswick High Road, London W4 4AL, UK.  
A member of BSI Group of Companies.

# Kitemark™ Certificate

No. KM 15121

Reference number	Description and Size	Branding	Production site
45126	TX1/TX270 35 Pro Coupling	Pro	Doncaster
45128	TX1/TX270 42 Pro Coupling	Pro	Doncaster
45130	TX1/TX270 54 Pro Coupling	Pro	Doncaster
45145	TX1S/TX270S 35 Slip Coupling	Pro	Doncaster
45146	TX1S/TX270S 42 Slip Coupling	Pro	Doncaster
45147	TX1S/TX270S 54 Slip Coupling	Pro	Doncaster
45230	TX2/TX270G 35X11/4 Pro Fem Coup	Pro	Doncaster
45232	TX2/TX270G 42X11/2 ProFemale Coup	Pro	Doncaster
45234	TX2/TX270G 54X2 Pro Female Coup	Pro	Doncaster
45310	TX3/TX243G 35X11/4 Pro Male Coup	Pro	Doncaster
45312	TX3/TX243G 42X11/2 Pro Male Coup	Pro	Doncaster
45314	TX3/TX243G 54X2 Pro Male Coup	Pro	Doncaster
45450	TX6/TX243 35X15 Pro Reducer	Pro	Doncaster
45452	TX6/TX243 35X22 Pro Reducer	Pro	Doncaster
45454	TX6/TX243 35X28 Pro Reducer	Pro	Doncaster
45456	TX6/TX243 42X15 Pro Reducer	Pro	Doncaster
45458	TX6/TX243 42X22 Pro Reducer	Pro	Doncaster
45460	TX6/TX243 42X28 Pro Reducer	Pro	Doncaster
45462	TX6/TX243 42X35 Pro Reducer	Pro	Doncaster
45464	TX6/TX243 54X15 Pro Reducer	Pro	Doncaster
45466	TX6/TX243 54X22 Pro Reducer	Pro	Doncaster
45468	TX6/TX243 54X28 Pro Reducer	Pro	Doncaster
45470	TX6/TX243 54X35 Pro Reducer	Pro	Doncaster
45472	TX6/TX243 54X42 Pro Reducer	Pro	Doncaster
45530	TX12/TX090 35 Pro Elbow	Pro	Doncaster
45532	TX12/TX090 42 Pro Elbow	Pro	Doncaster
45534	TX12/TX090 54 Pro Elbow	Pro	Doncaster
45540	TX21/TX041 35 Obtuse Elbow	Pro	Doncaster

First Issued: 1945-10-02

Latest Issue: 2017-09-11

Page: 43 of 52

This certificate has been issued by and remains the property of BSI Assurance UK Ltd, Kitemark Court, Davy Avenue, Knowlhill, Milton Keynes MK5 8PP, United Kingdom and should be returned immediately upon request.

To check its validity telephone +44 (0) 345 080 9000. An electronic certificate can be authenticated [online](#).

BSI Assurance UK Limited, registered in England under number 7805321 at 389 Chiswick High Road, London W4 4AL, UK.  
A member of BSI Group of Companies.



# Kitemark™ Certificate

No. KM 15121

Reference number	Description and Size	Branding	Production site
45541	TX21/TX041 42 Obtuse Elbow	Pro	Doncaster
45547	TX21S/TX040 35 Obtuse Street Elb	Pro	Doncaster
45548	TX21S/TX040 42 Obtuse Street Elb	Pro	Doncaster
45549	TX21S/TX040 54 Obtuse Street Elb	Pro	Doncaster
45558	TX21/TX041 54 Obtuse Elbow	Pro	Doncaster
45680	TX24/TX130 35 Pro Equal Tee	Pro	Doncaster
45682	TX24/TX130 42 Pro Equal Tee	Pro	Doncaster
45684	TX24/TX130 54 Pro Equal Tee	Pro	Doncaster
45750	TX25 35X15/TX130 35X15X35 Pro Tee	Pro	Doncaster
45752	TX25 35X22/TX130 35X22X35 Pro Tee	Pro	Doncaster
45753	TX25 35X28/TX130 35X28X35 Pro Tee	Pro	Doncaster
45754	TX25 42X15/TX130 42X15X42 Pro Tee	Pro	Doncaster
45756	TX25 42X22/TX130 42X22X42 Pro Tee	Pro	Doncaster
45758	TX25 42X28/TX130 42X28X42 Pro Tee	Pro	Doncaster
45760	TX25 54X15/TX130 54X15X54 Pro Tee	Pro	Doncaster
45762	TX25 54X22/TX130 54X22X54 Pro Tee	Pro	Doncaster
45764	TX25 54X28/TX130 54X28X54 Pro Tee	Pro	Doncaster
45765	TX25 54X35/TX130 54X35X54 Pro Tee	Pro	Doncaster
45848	TX30 35X1/2F/TX130G 35X1/2FX35Pro	Pro	Doncaster
45850	TX30 42X1/2F/TX130G 42X1/2FX42Pro	Pro	Doncaster
45878	TX61/TX301 35 Pro Stop End	Pro	Doncaster
45880	TX61/TX301 42 Pro Stopend	Pro	Doncaster
45882	TX61/TX301 54 Pro Stopend	Pro	Doncaster
65114	TX1/TX270 15 Pro Coupling	Pro	Doncaster
65121	TX1/TX270 22 Pro Coupling	Pro	Doncaster
65123	TX1/TX270 28 Pro Coupling	Pro	Doncaster
65141	TX1S/TX270S 15 Slip Coupling	Pro	Doncaster
65143	TX1S/TX270S 22 Slip Coupling	Pro	Doncaster

First Issued: 1945-10-02

Latest Issue: 2017-09-11

Page: 44 of 52

This certificate has been issued by and remains the property of BSI Assurance UK Ltd, Kitemark Court, Davy Avenue, Knowlhill, Milton Keynes MK5 8PP, United Kingdom and should be returned immediately upon request.

To check its validity telephone +44 (0) 345 080 9000. An electronic certificate can be authenticated [online](#).

BSI Assurance UK Limited, registered in England under number 7805321 at 389 Chiswick High Road, London W4 4AL, UK.  
A member of BSI Group of Companies.

# Kitemark™ Certificate

No. KM 15121

Reference number	Description and Size	Branding	Production site
65144	TX1S/TX270S 28 Slip Coupling	Pro	Doncaster
65171	TX62/TX062 15X3/4 Pro Tap Connect	Pro	Doncaster
65206	TX2/TX270G 15X1/2 Pro Fem Coup	Pro	Doncaster
65222	TX2/TX270G 22X3/4 Pro Fem Coup	Pro	Doncaster
65223	TX2/TX270G 22X1 Pro Fem Coup	Pro	Doncaster
65225	TX2/TX270G 28X1 Pro Fem Coup	Pro	Doncaster
65267	TX3/TX243G 15X1/2 Pro Male Coup	Pro	Doncaster
65292	TX3/TX243G 22X3/4 Pro Male Coup	Pro	Doncaster
65294	TX3/TX243G 22X1 Pro Male Coup	Pro	Doncaster
65296	TX3/TX243G 28X1 Pro Male Coup	Pro	Doncaster
65358	TX3P/TX243G 15X1/2 Pro Male Coup	Pro	Doncaster
65364	TX3P/TX243G 22x1/2 Male Coupling	Pro	Doncaster
65366	TX3P/TX243G 22X3/4 Pro Male Coup	Pro	Doncaster
65368	TX3P/TX243G 22X1 Pro Male Coup	Pro	Doncaster
65370	TX3P/TX243G 28X1 Pro Male Coup	Pro	Doncaster
65426	TX6/TX243 22X15 Pro Reducer	Pro	Doncaster
65435	TX6/TX243 28X15 Pro Reducer	Pro	Doncaster
65438	TX6/TX243 28X22 Pro Reducer	Pro	Doncaster
65496	TX12S/TX092 15 Pro Street Elbow	Pro	Doncaster
65500	TX12S/TX092 22 Pro Street Elbow	Pro	Doncaster
65502	TX12S/TX092 28 Pro Street Elbow	Pro	Doncaster
65516	TX12/TX090 15 Pro Elbow	Pro	Doncaster
65524	TX12/TX090 22 Pro Elbow	Pro	Doncaster
65526	TX12/TX090 28 Pro Elbow	Pro	Doncaster
65535	TX21/TX041 15mm Obtuse Elbow	Pro	Doncaster
65538	TX21/TX041 22mm Obtuse Elbow	Pro	Doncaster
65539	TX21/TX041 28mm Obtuse Elbow	Pro	Doncaster
65542	TX21S/TX040 15 Obtuse Street Elb	Pro	Doncaster

First Issued: 1945-10-02

Latest Issue: 2017-09-11

Page: 45 of 52

This certificate has been issued by and remains the property of BSI Assurance UK Ltd, Kitemark Court, Davy Avenue, Knowlhill, Milton Keynes MK5 8PP, United Kingdom and should be returned immediately upon request.

To check its validity telephone +44 (0) 345 080 9000. An electronic certificate can be authenticated [online](#).

BSI Assurance UK Limited, registered in England under number 7805321 at 389 Chiswick High Road, London W4 4AL, UK.  
A member of BSI Group of Companies.

# Kitemark™ Certificate

No. KM 15121

Reference number	Description and Size	Branding	Production site
65545	TX21S/TX040 22 Obtuse Street Elb	Pro	Doncaster
65546	TX21S/TX040 28 Obtuse Street Elb	Pro	Doncaster
65561	TX13/TX092G 15X1/2 Pro Male Elbow	Pro	Doncaster
65578	TX13/T092G 28X1 Pro Male Elbow	Pro	Doncaster
65606	TX14/TX090G 15X1/2 Pro Fem Elbow	Pro	Doncaster
65620	TX14/TX090G 22X3/4 Pro Fem Elbow	Pro	Doncaster
65622	TX14/TX090G 28X1 Pro Female Elbow	Pro	Doncaster
65646	TX15/TX471G 15x1/2 Pro Bplate Elb	Pro	Doncaster
65666	TX24/TX130 15 Pro Equal Tee	Pro	Doncaster
65676	TX24/TX130 22 Pro Equal Tee	Pro	Doncaster
65678	TX24/TX130 28 Pro Equal Tee	Pro	Doncaster
65737	TX25 22X15/TX130 22X15X22 Pro Tee	Pro	Doncaster
65744	TX25 28X15/TX130 28X15X28 Pro Tee	Pro	Doncaster
65746	TX25 28X22/TX130 28X22X28 Pro Tee	Pro	Doncaster
65759	TX68/TX068 15X3/4 FF Union Adptr	Pro	Doncaster
65760	TX68FF 22 x 3/4	Pro	Doncaster
65786	TX26 22X15/TX130 22X22X15 Pro Tee	Pro	Doncaster
65790	TX26 28X15/TX130 28X28X15 Pro Tee	Pro	Doncaster
65793	TX26 28X22/TX130 28X28X22 Pro Tee	Pro	Doncaster
65820	TX27/TX130 22X15X15 PTee Red EBch	Pro	Doncaster
65822	TX27/TX130 28X22X22 PTee Red EBch	Pro	Doncaster
65840	TX30 15X1/2/TX130G 15x1/2x15 Pro	Pro	Doncaster
65845	TX30 22x22x1/2F/TX130G 22x1/2Fx22	Pro	Doncaster
65866	TX61/TX301 15 Pro Stopend	Pro	Doncaster
65874	TX61/TX301 22 Pro Stopend	Pro	Doncaster
65876	TX61/TX301 28 Pro Stopend	Pro	Doncaster
65892	TX61RV/TX302 15 Pro Stopend A/R	Pro	Doncaster
65894	TX61RV/TX302 22 Pro Stopend A/R	Pro	Doncaster

First Issued: 1945-10-02

Latest Issue: 2017-09-11

Page: 46 of 52

This certificate has been issued by and remains the property of BSI Assurance UK Ltd, Kitemark Court, Davy Avenue, Knowlhill, Milton Keynes MK5 8PP, United Kingdom and should be returned immediately upon request.

To check its validity telephone +44 (0) 345 080 9000. An electronic certificate can be authenticated [online](#).

BSI Assurance UK Limited, registered in England under number 7805321 at 389 Chiswick High Road, London W4 4AL, UK.  
A member of BSI Group of Companies.

# Kitemark™ Certificate

No. KM 15121

Reference number	Description and Size	Branding	Production site
65895	TX61RV/TX302 28 Pro Stopend A/R	Pro	Doncaster
65902	TX62/TX062 15X1/2 Pro Tap Connect	Pro	Doncaster
65903	TX62/TX062 22x3/4 Pro St Tap Conn	Pro	Doncaster
65922	TX63/TX063 15X1/2 Pro Bent Tp Con	Pro	Doncaster
65924	TX63/TX063 22X3/4 Pro Bent Tp Con	Pro	Doncaster
65930	TX68S 22X1 Pro St Cylinder Union	Pro	Doncaster
65936	TX526S/TX467 15mm Draincock	Pro	Doncaster



First Issued: 1945-10-02

Latest Issue: 2017-09-11

Page: 47 of 52

This certificate has been issued by and remains the property of BSI Assurance UK Ltd, Kitemark Court, Davy Avenue, Knowlhill, Milton Keynes MK5 8PP, United Kingdom and should be returned immediately upon request.

To check its validity telephone +44 (0) 345 080 9000. An electronic certificate can be authenticated [online](#).

BSI Assurance UK Limited, registered in England under number 7805321 at 389 Chiswick High Road, London W4 4AL, UK.  
A member of BSI Group of Companies.

# Kitemark™ Certificate

No. KM 15121

## Tectite Stainless

Reference number	Description and Size	Branding	Production site
25114	TS1/TS270 Coupling 15mm	Tectite	Doncaster
25118	TS1/TS270 Coupling 18mm	Tectite	Doncaster
25121	TS1/TS270 Coupling 22mm	Tectite	Doncaster
25123	TS1/TS270 Coupling 28mm	Tectite	Doncaster
25126	TS1/TS270 Coupling 35mm	Tectite	Doncaster
25128	TS1/TS270 Coupling 42mm	Tectite	Doncaster
25130	TS1/TS270 Coupling 54mm	Tectite	Doncaster
25141	TS1s/TS270s Slip Coupling 15mm	Tectite	Doncaster
25142	TS1s/TS270s Slip Coupling 18mm	Tectite	Doncaster
25143	TS1s/TS270s Slip Coupling 22mm	Tectite	Doncaster
25144	TS1s/TS270s Slip Coupling 28mm	Tectite	Doncaster
25206	TS2/TS270G Strt FemaleConn 15x1/2	Tectite	Doncaster
25210	TS2/TS270G Strt FemaleConn 18x1/2	Tectite	Doncaster
25212	TS2/TS270G Strt FemaleConn 18x3/4	Tectite	Doncaster
25220	TS2/TS270G Strt FemaleConn 22x1/2	Tectite	Doncaster
25222	TS2/TS270G Strt FemaleConn 22x3/4	Tectite	Doncaster
25223	TS2/TS270G Strt FemaleConn 22x1	Tectite	Doncaster
25224	TS2/TS270G Strt FemaleConn 28x3/4	Tectite	Doncaster
25225	TS2/TS270G Strt FemaleConn 28x1	Tectite	Doncaster
25230	TS2/TS270G St FemaleConn 35x11/4	Tectite	Doncaster
25231	TS2/TS270G Strt De Fe Con 35x11/4	Tectite	Doncaster
25232	TS2/TS270G St FemaleConn 42x11/2	Tectite	Doncaster
25233	TS2/TS270G Strt De Fe Con 42x11/2	Tectite	Doncaster
25234	TS2/TS270G Strt FemaleConn 54x2	Tectite	Doncaster
25235	TS2/TS270G Strt De Fem Con 54x2	Tectite	Doncaster

First Issued: 1945-10-02

Latest Issue: 2017-09-11

Page: 48 of 52

This certificate has been issued by and remains the property of BSI Assurance UK Ltd, Kitemark Court, Davy Avenue, Knowlhill, Milton Keynes MK5 8PP, United Kingdom and should be returned immediately upon request.

To check its validity telephone +44 (0) 345 080 9000. An electronic certificate can be authenticated [online](#).

BSI Assurance UK Limited, registered in England under number 7805321 at 389 Chiswick High Road, London W4 4AL, UK.  
A member of BSI Group of Companies.

# Kitemark™ Certificate

No. KM 15121

Reference number	Description and Size	Branding	Production site
25267	TS3/TS243G Strt Male Conn 15x1/2	Tectite	Doncaster
25286	TS3/TS243G Strt Male Conn 18x1/2	Tectite	Doncaster
25288	TS3/TS243G Strt Male Conn 18x3/4	Tectite	Doncaster
25290	TS3/TS243G Strt Male Conn 22x1/2	Tectite	Doncaster
25292	TS3/TS243G Strt Male Conn 22x3/4	Tectite	Doncaster
25295	TS3/TS243G Strt Male Conn 28x3/4	Tectite	Doncaster
25296	TS3/TS243G Strt Male Conn 28x1	Tectite	Doncaster
25310	TS3/TS243G Strt Male Conn 35x11/4	Tectite	Doncaster
25312	TS3/TS243G Strt Male Conn 42x11/2	Tectite	Doncaster
25314	TS3/TS243G Strt Male Conn 54x2	Tectite	Doncaster
25424	TS6/TS243 Reducer 18x15	Tectite	Doncaster
25426	TS6/TS243 Reducer 22x15	Tectite	Doncaster
25430	TS6/TS243 Reducer 22x18	Tectite	Doncaster
25435	TS6/TS243 Reducer 28x15	Tectite	Doncaster
25437	TS6/TS243 Reducer 28x18	Tectite	Doncaster
25438	TS6/TS243 Reducer 28x22	Tectite	Doncaster
25452	TS6/TS243 Reducer 35x22	Tectite	Doncaster
25454	TS6/TS243 Reducer 35x28	Tectite	Doncaster
25458	TS6/TS243 Reducer 42x22	Tectite	Doncaster
25460	TS6/TS243 Reducer 42x28	Tectite	Doncaster
25462	TS6/TS243 Reducer 42x35	Tectite	Doncaster
25470	TS6/TS243 Reducer 54x35	Tectite	Doncaster
25472	TS6/TS243 Reducer 54x42	Tectite	Doncaster
25496	TS12s/TS092 Street Elbow 15mm	Tectite	Doncaster
25498	TS12s/TS092 Street Elbow 18mm	Tectite	Doncaster
25500	TS12s/TS092 Street Elbow 22mm	Tectite	Doncaster

First Issued: 1945-10-02

Latest Issue: 2017-09-11

Page: 49 of 52

This certificate has been issued by and remains the property of BSI Assurance UK Ltd, Kitemark Court, Davy Avenue, Knowlhill, Milton Keynes MK5 8PP, United Kingdom and should be returned immediately upon request.

To check its validity telephone +44 (0) 345 080 9000. An electronic certificate can be authenticated [online](#).

BSI Assurance UK Limited, registered in England under number 7805321 at 389 Chiswick High Road, London W4 4AL, UK.  
A member of BSI Group of Companies.

# Kitemark™ Certificate

No. KM 15121

Reference number	Description and Size	Branding	Production site
25502	TS12s/TS092 Street Elbow 28mm	Tectite	Doncaster
25516	TS12/TS090 Elbow 15mm	Tectite	Doncaster
25520	TS12/TS090 Elbow 18mm	Tectite	Doncaster
25524	TS12/TS090 Elbow 22mm	Tectite	Doncaster
25528	TS12/TS090 Elbow 28mm	Tectite	Doncaster
25530	TS12/TS090 Elbow 35mm	Tectite	Doncaster
25532	TS12/TS090 Elbow 42mm	Tectite	Doncaster
25534	TS12/TS090 Elbow 54mm	Tectite	Doncaster
25561	TS13/TS092G Male Elbow 15x1/2	Tectite	Doncaster
25569	TS13/TS092G Male Elbow 18x1/2	Tectite	Doncaster
25576	TS13/TS092G Male Elbow 22x3/4	Tectite	Doncaster
25578	TS13/TS092G Male Elbow 28x1	Tectite	Doncaster
25606	TS14/TS090G Female Elbow 15x1/2	Tectite	Doncaster
25614	TS14/TS090G Female Elbow 18x1/2	Tectite	Doncaster
25615	TS14/TS090G Female Elbow 18x3/4	Tectite	Doncaster
25620	TS14/TS090G Female Elbow 22x3/4	Tectite	Doncaster
25622	TS14/TS090G Female Elbow 28x1	Tectite	Doncaster
25646	TS15/TS471G B/Plate Elbow 15x1/2	Tectite	Doncaster
25650	TS15/TS471G B/Plate Elbow 18x1/2	Tectite	Doncaster
25654	TS15/TS471G B/Plate Elbow 22x3/4	Tectite	Doncaster
25666	TS24/TS130 Equal Tee 15mm	Tectite	Doncaster
25670	TS24/TS130 Equal Tee 18mm	Tectite	Doncaster
25676	TS24/TS130 Equal Tee 22mm	Tectite	Doncaster
25678	TS24/TS130 Equal Tee 28mm	Tectite	Doncaster
25680	TS24/TS130 Equal Tee 35mm	Tectite	Doncaster
25682	TS24/TS130 Equal Tee 42mm	Tectite	Doncaster

First Issued: 1945-10-02

Latest Issue: 2017-09-11

Page: 50 of 52

This certificate has been issued by and remains the property of BSI Assurance UK Ltd, Kitemark Court, Davy Avenue, Knowlhill, Milton Keynes MK5 8PP, United Kingdom and should be returned immediately upon request.

To check its validity telephone +44 (0) 345 080 9000. An electronic certificate can be authenticated [online](#).

BSI Assurance UK Limited, registered in England under number 7805321 at 389 Chiswick High Road, London W4 4AL, UK.  
A member of BSI Group of Companies.

# Kitemark™ Certificate

No. KM 15121

Reference number	Description and Size	Branding	Production site
25684	TS24/TS130 Equal Tee 54mm	Tectite	Doncaster
25725	TS25/TS130 Tee Red Branch 18x15	Tectite	Doncaster
25737	TS25/TS130 Tee Red Branch 22x15	Tectite	Doncaster
25742	TS25/TS130 Tee Red Branch 22x18	Tectite	Doncaster
25744	TS25/TS130 Tee Red Branch 28x15	Tectite	Doncaster
25745	TS25/TS130 Tee Red Branch 28x18	Tectite	Doncaster
25746	TS25/TS130 Tee Red Branch 28x22	Tectite	Doncaster
25750	TS25/TS130 Tee Red Branch 35x15	Tectite	Doncaster
25752	TS25/TS130 Tee Red Branch 35x22	Tectite	Doncaster
25753	TS25/TS130 Tee Red Branch 35x28	Tectite	Doncaster
25758	TS25/TS130 Tee Red Branch 42x28	Tectite	Doncaster
25762	TS25/TS130 Tee Red Branch 54x22	Tectite	Doncaster
25764	TS25/TS130 Tee Red Branch 54x28	Tectite	Doncaster
25840	TS30/TS130G Tee Female Bch 15x1/2	Tectite	Doncaster
25843	TS30/TS130G Tee Female Bch 18x1/2	Tectite	Doncaster
25845	TS30/TS130G Tee Female Bch 22x1/2	Tectite	Doncaster
25846	TS30/TS130G Tee Female Bch 22x3/4	Tectite	Doncaster
25847	TS30/TS130G Tee Female Bch 28x1/2	Tectite	Doncaster
25848	TS30/TS130G Tee Female Bch 35x1/2	Tectite	Doncaster
25850	TS30/TS130G Tee Female Bch 42x1/2	Tectite	Doncaster
25866	TS61/TS301 Stop End 15mm	Tectite	Doncaster
25870	TS61/TS301 Stop End 18mm	Tectite	Doncaster
25874	TS61/TS301 Stop End 22mm	Tectite	Doncaster
25876	TS61/TS301 Stop End 28mm	Tectite	Doncaster
25878	TS61/TS301 Stop End 35mm	Tectite	Doncaster
25880	TS61/TS301 Stop End 42mm	Tectite	Doncaster

First Issued: 1945-10-02

Latest Issue: 2017-09-11

Page: 51 of 52

This certificate has been issued by and remains the property of BSI Assurance UK Ltd, Kitemark Court, Davy Avenue, Knowlhill, Milton Keynes MK5 8PP, United Kingdom and should be returned immediately upon request.

To check its validity telephone +44 (0) 345 080 9000. An electronic certificate can be authenticated [online](#).

BSI Assurance UK Limited, registered in England under number 7805321 at 389 Chiswick High Road, London W4 4AL, UK.  
A member of BSI Group of Companies.



# Kitemark™ Certificate

No. KM 15121

Reference number	Description and Size	Branding	Production site
25882	TS61/TS301 Stop End 54mm	Tectite	Doncaster
25884	TS61RV/TS302 Stop End 15mm	Tectite	Doncaster
25886	TS61RV/TS302 Stop End 22mm	Tectite	Doncaster
25902	TS62/TS062 15X1/2 St Tap Connectr	Tectite	Doncaster
25903	TS62/TS062 22X3/4 St Tap Connectr	Tectite	Doncaster
26003	TS18/TS002A Slow Bend 15mm	Tectite	Doncaster
26005	TS18/TS002A Slow Bend 18mm	Tectite	Doncaster
26007	TS18/TS002A Slow Bend 22mm	Tectite	Doncaster
26008	TS18/TS002A Slow Bend 28mm	Tectite	Doncaster
26009	TS18/TS002A Slow Bend 35mm	Tectite	Doncaster
26010	TS18/TS002A Slow Bend 42mm	Tectite	Doncaster
26011	TS18/TS002A Slow Bend 54mm	Tectite	Doncaster
26023	TS18S/TS001 Slow Street Elbow 15	Tectite	Doncaster
26025	TS18S/TS001 Slow Street Elbow 18	Tectite	Doncaster
26027	TS18S/TS001 Slow Street Elbow 22	Tectite	Doncaster
26028	TS18S/TS001 Slow Street Elbow 28	Tectite	Doncaster
26043	TS21/TS041 Obtuse Elbow 15mm	Tectite	Doncaster
26045	TS21/TS041 Obtuse Elbow 18mm	Tectite	Doncaster
26047	TS21/TS041 Obtuse Elbow 22mm	Tectite	Doncaster
26048	TS21/TS041 Obtuse Elbow 28mm	Tectite	Doncaster
26049	TS21/TS041 Obtuse Elbow 35mm	Tectite	Doncaster
26050	TS21/TS041 Obtuse Elbow 42mm	Tectite	Doncaster
26051	TS21/TS041 Obtuse Elbow 54mm	Tectite	Doncaster
26063	TS21s/TS040 ObtuseStreet Elbow 15	Tectite	Doncaster
26065	TS21s/TS040 ObtuseStreet Elbow 18	Tectite	Doncaster
26067	TS21s/TS040 ObtuseStreet Elbow 22	Tectite	Doncaster
26068	TS21s/TS040 ObtuseStreet Elbow 28	Tectite	Doncaster
26069	TS21s/TS040 ObtuseStreet Elbow 35	Tectite	Doncaster
26070	TS21s/TS040 ObtuseStreet Elbow 42	Tectite	Doncaster

First Issued: 1945-10-02

Latest Issue: 2017-09-11

Page: 52 of 52

This certificate has been issued by and remains the property of BSI Assurance UK Ltd, Kitemark Court, Davy Avenue, Knowlhill, Milton Keynes MK5 8PP, United Kingdom and should be returned immediately upon request.

To check its validity telephone +44 (0) 345 080 9000. An electronic certificate can be authenticated [online](#).

BSI Assurance UK Limited, registered in England under number 7805321 at 389 Chiswick High Road, London W4 4AL, UK.  
A member of BSI Group of Companies.



CERTIFICATION MARK

*This certifies that*

**PEGLER YORKSHIRE GROUP LTD**

---

*has had the undermentioned product examined, tested and found, when correctly installed, to comply with the requirements of the United Kingdom Water Supply (Water Fittings) Regulations and Scottish Water Byelaws.*

**ISR' RANGE OF COPPER, DZR BRASS OR GUNMETAL CAPILLARY, LEAD FREE SOLDER RING AND THREADED FITTINGS FOR USE WITH COPPER PIPE**

*The certificate by itself is not evidence of a valid WRAS Approval. Confirmation of the current status of an approval must be obtained from the WRAS Directory ([www.wras.co.uk/directory](http://www.wras.co.uk/directory))*

---

*The product so mentioned will be valid until the end of:*

**September 2020**

---

**1509059**

*Certificate No.*

*J. Funnell*

---

Secretary

*K. Lewis*

---

Chairman, Product Assessment Group