

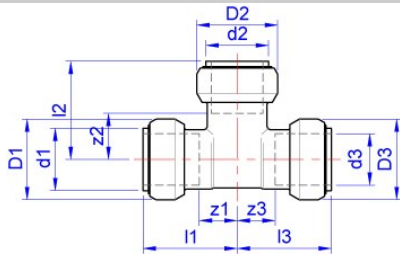

Tectite

Equal tee, push-fit on all ends

TS24/TS130 Tee



| Code | Description | d1 | d2 | d3 | l1 | l2 | l3 | D1 | D2 | D3 | z1 | z2 | z3 |
|-------|-----------------|----|----|----|----|----|----|----|----|----|----|----|----|
| 25666 | 15mm TS24/TS130 | 15 | 15 | 15 | 33 | 33 | 33 | 26 | 26 | 26 | 9 | 9 | 9 |
| 25670 | 18mm TS24/TS130 | 18 | 18 | 18 | 34 | 34 | 34 | 29 | 29 | 29 | 10 | 10 | 10 |
| 25676 | 22mm TS24/TS130 | 22 | 22 | 22 | 39 | 39 | 39 | 34 | 34 | 34 | 12 | 12 | 12 |
| 25678 | 28mm TS24/TS130 | 28 | 28 | 28 | 46 | 46 | 46 | 42 | 42 | 42 | 15 | 15 | 15 |

Pegler Yorkshire reserve the right to change specifications

Pegler Yorkshire Tectite Sprint, Classic, Pro and 316 Guarantee - Terms and Conditions

Products are subject to a guarantee that is between Pegler Yorkshire and the final purchaser of the product. When correctly assembled with the stated tubes and pipe the length of guarantee is as follows:

25 Years Where Tectite Sprint, Tectite Classic, Tectite Pro and Tectite 316 fittings, Tectite-PEX barrier pipe and 316 System tube are installed in pipelines with products from other manufacturers, they are guaranteed for 25 years.

30 Years Where pipelines are constructed exclusively using Tectite fittings and recommended tubes, the resulting installations will be deemed Tectite Systems and qualify for a 30 year guarantee.

Qualifying systems are:

- Tectite Sprint fittings with Yorkex copper tube and/or Tectite-PEX pipe
- Tectite Classic fittings with Yorkex copper tube and/or Tectite-PEX pipe
- Tectite Pro fittings with Yorkex copper tube and/or Tectite-PEX pipe
- Tectite 316 fittings and stainless steel 316 System tube.

The guarantee is subject to proof of purchase being supplied.

This guarantee does not affect any statutory rights the consumer may have in law.

The guarantee covers manufacturing or material defects when installed in accordance with our instructions on specified tube materials and applications, and does not cover parts subject to normal wear and tear.

This product range has been designed for the use of homeowners, domestic and commercial applications and therefore the Guarantee is subject to the product being properly selected for their intended service conditions.

The guarantee is not applicable where the product is fitted contrary to the conditions in the fitting instructions.

This is reinforced where valves are covered by the European Pressure Equipment Directive (PED97/23/EC) where Installation, Operating and Maintenance Instructions are supplied with each product and/or carton.

Provided it is installed correctly and receives adequate preventative maintenance it should give years of trouble-free service.

Abusive behaviour and accidental damage to the product are not covered by this guarantee.

The extent of this liability is limited to the cost of the replacement of the defective item and not to installation or consequential damages.

| Tectite Fitting | Tube/pipe used with | Min temperature | | | Max temperature |
|-----------------|---------------------|-----------------|---------------|---------------|-----------------|
| 316 up to 28mm | Stainless Steel | -24°C at 20bar | 30°C at 20bar | 65°C at 16bar | 114°C at 10bar |
| 316 over 35mm | Stainless Steel | -24°C at 16bar | 30°C at 16bar | 65°C at 10bar | 90°C at 6bar |

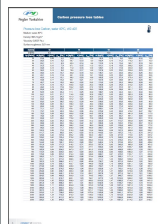

Pressure Loss Tables: Stainless Steel Water

Care

No regular aesthetic care is required for this product

Maintenance

No regular maintenance is required for this product.

For any further help please contact the Service Support Team on: 0800 1560050.

| Component | Material |
|----------------|-----------------------|
| Body | Stainless steel (316) |
| O ring | EPDM |
| Pipe guide | Glass filled nylon 6 |
| Demount collar | Brass tin plated |
| Grab ring | Stainless steel |

Pegler Yorkshire Group Ltd, St Catherine's Ave, Doncaster, S Yorkshire, DN4 8DF
Telephone: Phone +44 (0) 844 243 4400 Fax: +44 (0) 844 243 9870 Website: www.pegler-yorkshire.co.uk
Registered office : Pegler Yorkshire Group Ltd, St Catherine's Ave, Doncaster, S Yorkshire, DN4 8DF Company no : 00401507

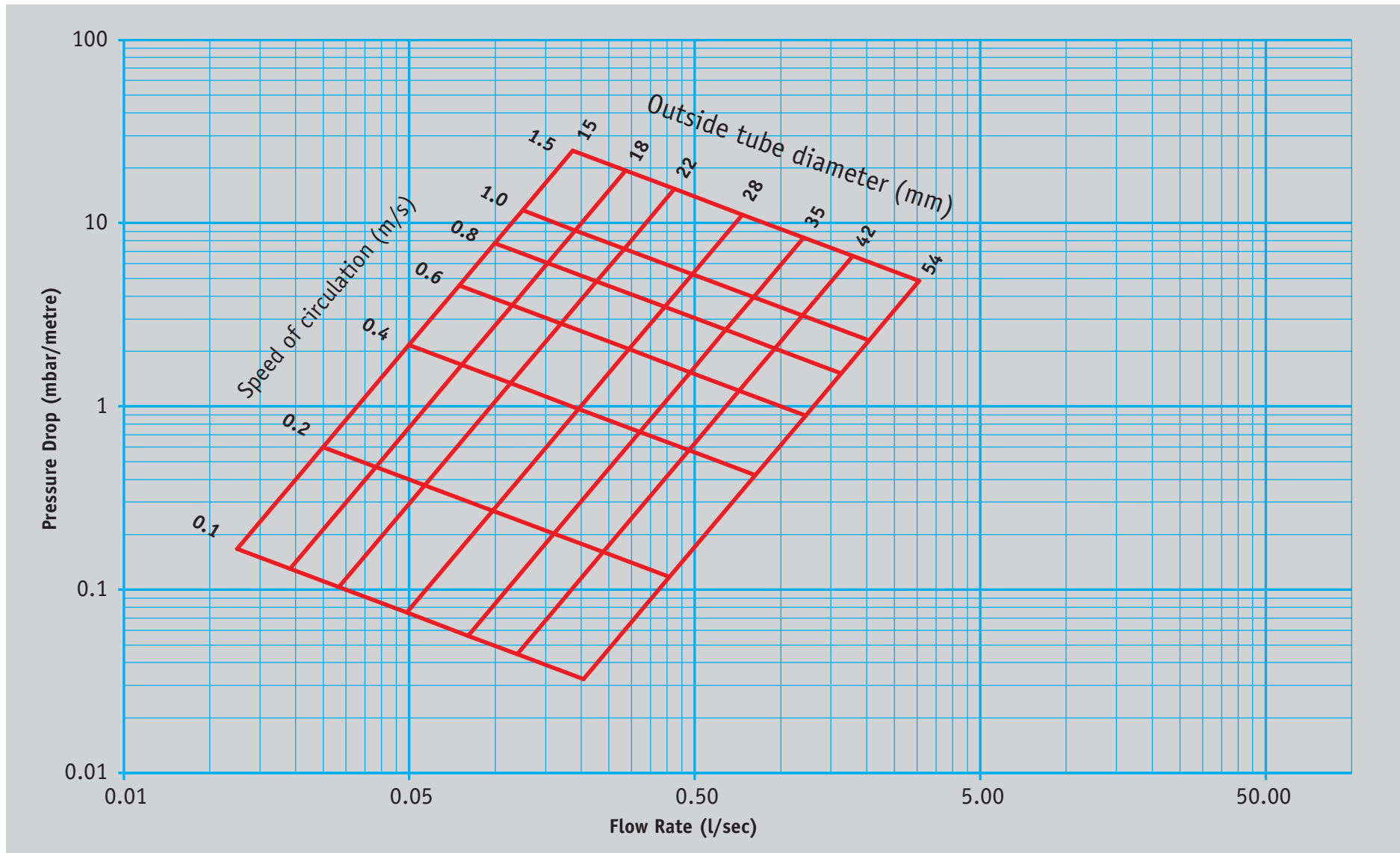

For joints 10 to 54mm

Always cut the tube square, using a rotary tube cutter whenever possible. Ensure the cutter wheel appropriate for the material been cut (Carbon steel requires a higher grade of cutter wheel, Pegler Yorkshire recommend using the TC155 with a REMS Cento)

If you are using PEX or PB pipe cut the pipe using pipe shears. When using plastic coated carbon steel tube remove the coating using the S115 stripping tool.

Deburr the tube end, both internally and externally to create a 1mm chamfer on the outside of the tube.

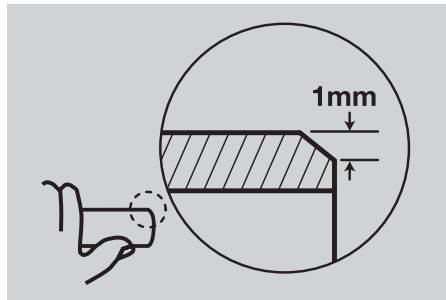

Check the tube ends are free from damage and clean, wiping away any swarf to avoid damaging the 'O' ring on tube insertion. Tube end must also be free from stickers, tape and adhesive residues.

Where using PEX or PB you must use always insert a support liner ensuring it is the correct liner as specified by the pipe manufacturer. If the pipe has been used on previous installations you will need to cut it back to behind the teeth or score marks.

Mark the socket depth with a marker.

Fitting socket depths for Tectite:

| Size | Sprint | Classic, PRO & 316 | Carbon |
|------|--------|--------------------|--------|
| 10mm | 15mm | 23mm | - |
| 12mm | 17mm | 23mm | - |
| 15mm | 16mm | 23mm | 28mm |
| 18mm | - | 23mm | 28mm |
| 22mm | 19mm | 27mm | 30mm |
| 28mm | 20mm | 31mm | 32mm |
| 35mm | - | 57mm | 40mm |
| 42mm | - | 62mm | 42mm |
| 54mm | - | 68mm | 45mm |

For chrome plated copper tube you must scribe the tube using the correct Tectite Scribing tool.

Select the correct type and size of fitting for pipework.

The fitting should be kept in its bag until point of use to protect the 'O' ring.

Check the fitting ensuring the grab rings/'O'rings have not been contaminated with grit or debris.

Insert the tube/pipe firmly with a slight twisting action until it reaches the tube stop with a positive "click".

Ensure the depth insertion mark corresponds with the mouth of the fitting, then pull firmly on the tube/pipe to ensure the fitting is secure.

Note: Tectite Sprint and Tectite Carbon fittings must not be used with male ended fittings from other Tectite ranges (except T5265). Other third party male ended products should not be used with any Tectite fittings.

Do not use Tectite fittings on gas services.

Tectite Classic fittings do not provide electrical continuity, other Tectite fittings only provide electrical continuity when installed with metal tube.

De-mounting Tectite fittings

| Range | De-mountability |
|---------|-----------------|
| Sprint | No |
| Classic | Yes |
| PRO | Yes |
| 316 | Yes |
| Carbon | No |

For sizes 10mm to 28mm

Place the forks of the disconnecting tool around the fitting assembly. The fork side carrying the Tectite brand logo should be positioned around the tube/pipe with the opposite side around the neck of the fitting.

Squeeze the disconnecting tool with one hand until the release collar in the fitting is compressed. With the other hand, twist out the tube/pipe using the thumb as a lever against the tool to assist disconnection.

Check the fitting and tube/pipe for damage before remaking the joint.

The plastic disconnecting clip may be used where only an occasional disconnecting facility is needed.

For sizes 35mm to 54mm

Have replacement parts for the discarded items ready for insertion. Using a spanner on the fitting flats to prevent the fitting from rotating, insert the Tectite DTX end cap tool into the slots in the end cap. Turn the tool anti-clockwise to unscrew the end cap and slide it along the tube away from the fitting body.

Pull the tube out of the fitting body.

Remove and discard the 'O' ring.

Remove and retain the alignment ring.

Snip off the grab ring with side cutters and discard. Before re-assembly replace the discarded parts, Tectite Pro grab rings (TX105) and Tectite 316 grab rings (TS106) these are not interchangeable.

The components must be clean and the 'O' ring lubricated using S130 Silicone lubricant. Replace the components in the correct order, as shown, and check they are fully seated in the fitting body.



Screw the end cap back into the fitting until hand tight. If resistance is felt and the end cap is not flush with the fitting body, remove the end cap and ensure the grab ring is fully located i.e. fully in contact with the alignment ring. Again screw the end cap into the fitting until hand tight. Temporarily insert a 300mm length of deburred tube into the fitting BUT NOT THROUGH the grab ring to help locate the demount tool. Tighten the end cap a further 8mm to 10mm (radically). Remove the tube.

Before reinstalling the fitting back into the system, check the end of the tube for damage. If the tube is scored or damaged, remove the affected section with a tube cutter and prepare the tube end as described in preliminaries and tube preparation.

The advantages of Tectite

- A totally heat-free jointing solution
- Major reductions in installation times provides major installed cost savings
- No need for hot works permits or additional costly insurance
- Sizes from 10mm up to 54mm
- Systems have an exceptionally clean bore with no flux residues
- System guarantees* of up to 30 Years for Tectite Sprint, Tectite Classic, Tectite Pro Tectite 316 and 20 Years for Tectite Carbon and Tectite Flexifit connectors

| Tectite Fitting | Tube/Pipe used with | Min Performance | | Max Performance | |
|------------------------|---------------------|-----------------|--------|-----------------|--------|
| Classic | Copper | -24°C | 30°C | 65°C | 95°C |
| | | 16 bar | 16 bar | 10 bar | 6 bar |
| Sprint & Classic | PEX & PB | -20°C | 20°C | 65°C | 92°C |
| | | 12 bar | 12 bar | 6 bar | 3 bar |
| Sprint & PRO upto 28mm | Copper | -24°C | 30°C | 65°C | 114°C |
| | | 20 bar | 20 bar | 16 bar | 10 bar |
| PRO over 35mm | Copper | -24°C | 30°C | 65°C | 90°C |
| | | 16 bar | 16 bar | 10 bar | 6 bar |
| 316 upto 28mm | Stainless steel | -24°C | 30°C | 65°C | 114°C |
| | | 20 bar | 20 bar | 16 bar | 10 bar |
| 316 over 35mm | Stainless steel | -24°C | 30°C | 65°C | 90°C |
| | | 16 bar | 16 bar | 10 bar | 6 bar |
| Carbon | Carbon Steel | -24°C | 30°C | 65°C | 114°C |
| | | 20 bar | 20 bar | 16 bar | 10 bar |



CERT

DVGW-Baumusterprüfzertifikat

DVGW type examination certificate

DW-8511BO0199

Registration Number
Registriernummer

| | |
|---|---|
| Field of Application <i>Anwendungsbereich</i> | products of water supply <i>Produkte der Wasserversorgung</i> |
| Owner of Certificate <i>Zertifikatinhaber</i> | Pegler Yorkshire Group Ltd. Haigh Park Road, GB- Stourton; Leeds LS10 1RT |
| Distributor <i>Vertreiber</i> | Pegler Yorkshire Group Ltd. Haigh Park Road, GB- Stourton; Leeds LS10 1RT |
| Product Category <i>Produktart</i> | installation systems and system joints: pipe joint for pipes in drinking water installation systems (8511) |
| Product Description <i>Produktbezeichnung</i> | push connector type M-MM, made of stainless steel for pipes made of stainless steel according to DVGW GW 541 and pipes made of copper according to DVGW GW 392 (semi-hard, R 250 or hard, R 290) |
| Model <i>Modell</i> | Tectite 316 |
| Test Reports <i>Prüfberichte</i> | supplement test: 120004471 from 25.09.2014 (MPM) laboratory control test: 120001607-12 L from 10.07.2012 (MPM) laboratory control test: 120001607-12 B from 10.07.2012 (MPM) type testing: 22 0002907 from 22.12.2003 (MPM) KTW testing: K-235415-13-Bs/st from 15.10.2013 (WHY) hygienic testing: MO 272/10 from 24.06.2011 (TZW) |
| Test Basis <i>Prüfgrundlagen</i> | DVGW W 534 (01.05.2004) BGA KTW (12.12.1985) DVGW W 270 (01.11.2007) |

Date of Expiry / File No. 18.06.2018 / 14-0442-WNA
Ablaufdatum / Aktenzeichen

14.01.2015 GI A-1/2

Date, issued by, Sheet, Head of Certification Body
Datum, Bearbeiter, Blatt, Leiter der Zertifizierungsstelle

DVGW CERT GmbH is an accredited body by DAkkS according to EN 45011:1998 for certification of products for energy and water supply industry.

DVGW CERT GmbH ist von der DAkkS nach DIN EN 45011:1998 akkreditierte Stelle für die Zertifizierung von Produkten der Energie- und Wasserversorgung.



DVGW CERT GmbH
Zertifizierungsstelle

Josef-Wirmer-Str. 1-3
53123 Bonn

Tel. +49 228 91 88 - 888
Fax +49 228 91 88 - 993

www.dvgw-cert.com
info@dvgw-cert.com

WRAS[®]

Water Regulations Advisory Scheme

This certifies that

PEGLER YORKSHIRE GROUP LTD.

has had the undermentioned product examined, tested and found, when correctly installed, to comply with the requirements of the United Kingdom Water Supply (Water Fittings) Regulations/Scottish Water Byelaws.

TECTITE 316 RANGE OF STAINLESS STEEL PUSH-FIT FITTINGS FOR USE WITH STAINLESS STEEL PIPES

This certificate by itself is not evidence of a valid WRAS Approval. Confirmation of the current status of an approval must be obtained from the WRAS Directory (www.wras.co.uk/directory)

The product so mentioned will be listed in the Water Fittings and Materials Directory for a period until:

31 MARCH 2019

1403701

Certificate No.

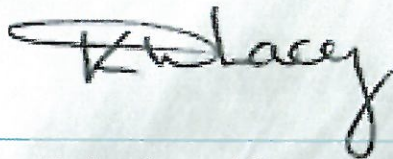

Chairman, Product Approval Group

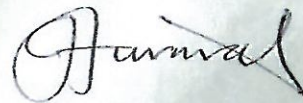

Secretary

WRAS
APPROVED
PRODUCT



Strojírenský zkušební ústav, s.p.
(Engineering Test Institute, Public Enterprise), Authorized Body 202
Hudcova 424/56b, 621 00 Brno, Czech Republic
Authorization Decision 27/2006 of 2006-08-29

DECISION

on the validity period extension of
Construction Technical Certificate

STO-30-00427-11

Manufacturer: Pegler Yorkshire Group Limited
St. Catherines Avenue, DN4 8D Doncaster, South Yorkshire
United Kingdom

Products: Tectite fittings

Type designation: Tectite PRO, Tectite CLASSIC, Tectite 316, Tectite SPRINT,
Tectite ADVANCE

Versions: see Pages 2 to 4

**Place of
manufacture:** YORKSHIRE Fittings Gyártó Kft.
Maglódi út 16., H-1106 Budapešť
Hungary

In accordance with the provisions of Section 10 of Act 22/1997 Coll., on technical requirements for products and on amendment to certain Acts, as amended, the abovementioned Authorized Body has verified Construction Technical Certificate STO-30-00427-11, issued on 2011-05-09. Whereas the data of the physical properties of the said products, their level and the ascertainment procedures with regard to essential requirements of Government 163/2002 Coll., as amended, have not changed, its validity is hereby extended until **2017-07-01**.

The rules for using the Decision are specified on Page 5.

Brno, 2014-07-01



Ing. Jiří Rozsival, MBA
Deputy Director

STO-30-00427-11-Decision, page 1 (5)

Strojírenský zkušební ústav, s.p., Hudcova 56b, 621 00 Brno, Česká republika
Engineering Test Institute, public enterprise, Hudcova 56b, 621 00 Brno, Czech Republic

www.szutest.cz



Specification of types and versions:

Tectite fittings with quick coupling device are made of CW024A copper (Tectite SPRINT), CW617N brass (Tectite CLASSIC, PRO), AISI 316-DIN 1.4401 stainless steel (Tectite 316), and of carbon steel (Tectite ADVANCE).

Application of Tectite SPRINT, CLASSIC, PRO, 316:

Domestic and commercial not directly buried installations inside or outside of buildings, for assembling of distribution systems transporting water (including potable water pursuant to Decree 409/2005 Coll.), heating water, pressure air and other non-corrosive fluids.

Application of Tectite ADVANCE:

Domestic and commercial not directly buried installations inside or outside of buildings, for assembling of distribution systems transporting water not intended for human consumption, heating water, pressure air and other non-corrosive fluids.

Operating pressures and temperatures:

| Fittings | Tubes | Temperature | | | |
|-------------------------|-----------------------------|-------------|--------|--------|--------|
| | | -24°C | 30°C | 65°C | 95°C |
| Tectite CLASSIC | Copper | 16 bar | 16 bar | 10 bar | 6 bar |
| Tectite CLASSIC | PB or PEX | 12 bar | 12 bar | 6 bar | 3 bar |
| Tectite SPRINT | Copper | 20 bar | 20 bar | 16 bar | 10 bar |
| Tectite SPRINT | PB or PEX | 12 bar | 12 bar | 6 bar | 3 bar |
| Tectite PRO up to 28 mm | Copper | 20 bar | 20 bar | 16 bar | 10 bar |
| Tectite PRO over 35 mm | Copper | 16 bar | 16 bar | 10 bar | 6 bar |
| Tectite 316 up to 28 mm | Stainless steel | 20 bar | 20 bar | 16 bar | 10 bar |
| Tectite 316 over 35 mm | Stainless steel | 16 bar | 16 bar | 10 bar | 6 bar |
| Tectite ADVANCE | Carbon steel | 20 bar | 20 bar | 16 bar | 10 bar |
| Tectite ADVANCE | Plastic coated carbon steel | 20 bar | 20 bar | 16 bar | 10 bar |

Threads as per ČSN EN 10226-1:2005 (ČSN ISO 7-1:1996) or ČSN EN ISO 228-1:2003, according to the joint type.

Cap nut threads as per ČSN EN ISO 228-1:2003, fitting ends for flat seals.

Specification of versions:

| Type | Description | Size |
|-----------------------|---------------------------|------------------|
| Tectite SPRINT | | |
| TT1 | Straight coupling | 10+28 |
| TT1R | Reducing coupling | 15+22x10+18 |
| TT2 | Straight female connector | 10+28x1/2"+1" |
| TT3 | Straight male connector | 10+28x1/2"+1" |
| TT5 | Tank connector | 15x1/2", 22x3/4" |
| TT6 | Reducer | 15+28x10+22 |

STO-30-00427-11-Decision, page 2 (5)

Strojírenský zkušební ústav, s.p., Hudcova 56b, 621 00 Brno, Česká republika
Engineering Test Institute, public enterprise, Hudcova 56b, 621 00 Brno, Czech Republic

www.szutest.cz



| Type | Description | Size |
|------------------------|--------------------------------------|-------------------------|
| TT12 | Elbow | 10+28 |
| TT12S | Street elbow | 10+22x10+22 |
| TT13 | Male elbow | 15x1/2" |
| TT14 | Female elbow | 14+16x1/2" |
| TT15 | Backplate elbow | 12+15x1/2" |
| TT21 | Obtuse elbow | 12+28 |
| TT21S | Obtuse street elbow | 12+28 |
| TT24 | Equal tee | 10+28 |
| TT25 | Tee, reduced branch | 14+28x14+28x12+22 |
| TT26 | Tee, one end reduced | 15+28x12+22x15+28 |
| TT27 | Tee, one end and branch reduced | 16+28x14+22x14+22 |
| TT61 | Stop end | 10+28 |
| TT62 | Tap connector | 10+22x1/2"+3/4" |
| TT63 | Bent tap connector | 10+18x1/2" |
| Tectite CLASSIC | | |
| T1 | Straight coupling | 10+28 |
| T1R | Reducing coupling | 12+28x10+22 |
| T2 | Straight female connector | 10+28x3/8"+1" |
| T3 | Tapered male connector | 10+28x3/8"+1" |
| T3P | Straight male connector | 12+28x3/8"+1" |
| T5 | Tank connector | 15x1/2", 22x1/2", 28x1" |
| T6 | Reducer | 12+28x10+22 |
| T12 | Elbow | 10+28 |
| T12S | Street elbow | 10+28 |
| T13 | Male elbow | 10+28x3/8"+1" |
| T14 | Female elbow | 10+28x3/8"+1" |
| T15 | Backplate elbow | 10+22x1/2"+3/4" |
| T21 | Obtuse elbow | 12+28 |
| T21S | Obtuse street elbow | 12+28 |
| T24 | Equal tee | 10+28 |
| T25 | Tee, reduced branch | 12+28x12+28x10+22 |
| T26 | Tee, one end reduced | 15+28x10+22x15+28 |
| T27 | Tee, one end and branch reduced | 15+28x10+22x10+22 |
| T30 | Female branch tee | 12+22x12+22x1/2"+3/4" |
| T61 | Stop end | 10+28 |
| T62 | Tap connector | 10+22x1/2"+3/4" |
| T62S | Tap connector | 15+22x1/2"+3/4" |
| T63 | Bent tap connector | 10+22x1/2"+3/4" |
| T68FF | Flat faced union adaptor | 15x3/4" |
| Tectite PRO | | |
| TX1 | Straight coupling | 15+54 |
| TX1 | Slip straight coupling, slip pattern | 15+54 |
| TX2 | Straight female connector | 15+54x1/2"+2" |
| TX3 | Tapered male connector | 15+54x1/2"+2" |
| TX3P | Straight male connector | 15+28x1/2"+1" |
| TX6 | Reducer | 22+54x15+42 |
| TX12 | Elbow | 15+54 |





| Type | Description | Size |
|------------------------|---------------------------------|---------------------------|
| TX12S | Street elbow | 15+28 |
| TX13 | Male elbow | 15+28x1/2"+1" |
| TX14 | Female elbow | 15+28x1/2"+1" |
| TX15 | Backplate elbow | 15x1/2" |
| TX21 | Obtuse elbow | 15+54 |
| TX21S | Obtuse street elbow | 15+54 |
| TX24 | Equal tee | 15+54 |
| TX25 | Tee, reduced branch | 22+54x22+54x15+35 |
| TX26 | Tee, one end reduced | 22+28x15+22x22+28 |
| TX27 | Tee, one end and branch reduced | 22x15x15, 28x22x22 |
| TX30 | Female branch tee | 15+42x15+42x1/2" |
| TX61 | Stop end | 15+54 |
| TX62 | Tap connector | 15+22x1/2"+3/4" |
| TX63 | Bent tap connector | 15+22x1/2"+3/4" |
| TX68FF | Flat faced union adaptor | 15x3/4" |
| TX68S | Cylinder union | 22x1" |
| Tectite 316 | | |
| TS1 | Straight coupling | 15+54 |
| TS2 | Straight female connector | 15+54x1/2"+2" |
| TS3 | Tapered male connector | 15+54x1/2"+2" |
| TS6 | Reducer | 18+54x15+42 |
| TS12 | Elbow | 15+54 |
| TS12S | Street elbow | 15+28 |
| TS13 | Male elbow | 15+28x1/2"+1" |
| TS14 | Female elbow | 15+28x1/2"+1" |
| TS15 | Backplate elbow | 15x1/2", 18x1/2", 22x3/4" |
| TS21 | Obtuse elbow | 15+54 |
| TS21S | Obtuse street elbow | 15+54 |
| TS24 | Equal tee | 15+54 |
| TS25 | Tee, reduced branch | 18+54x18+54x15+42 |
| TS30 | Female branch tee | 15+42x15+42x1/2" |
| TS61 | Stop end | 15+54 |
| TS62 | Tap connector | 15+22x1/2"+3/4" |
| Tectite ADVANCE | | |
| TA1 | Straight coupling | 15+54 |
| TA2 | Straight female connector | 15+28x1/2"+1" |
| TA3 | Tapered male connector | 15+54x1/2"+2" |
| TA6 | Reducer | 18+54x15+42 |
| TA12 | Elbow | 15+54 |
| TA12S | Street elbow | 15+54 |
| TA21 | Obtuse elbow | 15+54 |
| TA21S | Obtuse street elbow | 15+54 |
| TA24 | Equal tee | 15+54 |
| TA25 | Tee, reduced branch | 18+54x18+54x15+42 |
| TA30 | Female branch tee | 15+54x15+54x1/2" |
| TA61 | Stop end | 15+54 |
| TA69 | Straight male union connector | 15+54x1/2"+2" |

STO-30-00427-11-Decision, page 4 (5)

Strojírenský zkušební ústav, s.p., Hudcova 56b, 621 00 Brno, Česká republika
Engineering Test Institute, public enterprise, Hudcova 56b, 621 00 Brno, Czech Republic

www.szutest.cz



RULES FOR USING THE DECISION:

This Decision shall only be used in conjunction with Construction Technical Certificate STO-30-00427-11 of 2011-05-09.

Unauthorised or deceptive use of the Decision may result in its withdrawal.

It is prohibited to change, amend or overwrite the data contained in the Decision.

This Decision may not be used for the products changed without the consent of the Engineering Test Institute, Public Enterprise, in such a way that conformity with the Construction Technical Certificate has been affected.

The Construction Technical Certificate and the Decision on its validity period extension cannot be used as documents of conformity assessment.



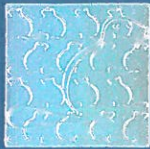

Product certificate K12080/09

Issued 2015-03-15
Replaces K12080/08
Page 1 of 14

Tectite Push-fit fittings

STATEMENT BY KIWA

With this product certificate, issued in accordance with the Kiwa Regulations for Product Certification, Kiwa declares that legitimate confidence exists that the products supplied by

Pegler Yorkshire Group Ltd.

as specified in this product certificate and marked with the Kiwa®-mark in the manner as indicated in this product certificate may, on delivery, be relied upon to comply with

Kiwa evaluation guideline BRL-K640/04: "Fittings to be tightened with matching compression tool, compression- and push fit fittings as part of appliances and installations".

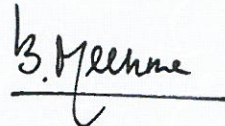

Bouke Meekma
Kiwa

Publication of the certificate is allowed.

Advice: consult www.kiwa.nl in order to ensure that this certificate is still valid.

Kiwa Nederland B.V.
Sir Winston Churchilllaan 273
P.O. Box 70
2280 AB RIJSWIJK
The Netherlands

Tel. +31 70 414 44 00
Fax +31 70 414 44 20
info@kiwa.nl
www.kiwa.nl



287130829

Supplier

Pegler Yorkshire Group Ltd.
St. Catherines Avenue
DONCASTER DN4 8DF
United Kingdom of Great Britain
Tel. +44 844 243 4400
Fax +44 844 243 9870
www.peglyorkshire.co.uk

Certification process
consists of initial and
regular assessment of:

- quality system
- product

Tectite Push-fit fittings

PRODUCT SPECIFICATION

The products mentioned below belong to this certificate.

Tectite Sprint Series

TT1 Straight coupling

| Art. no. | Size |
|----------|------|
| 75500 | 10mm |
| 75501 | 15mm |
| 75502 | 22mm |
| 75503 | 28mm |

TT2 Straight female connector

| Art. no. | Size |
|----------|-------------|
| 75510 | 15mm x 1/2" |
| 75511 | 22mm x 3/4" |

TT21 Obtuse elbow

| Art. no. | Size |
|----------|------|
| 75701 | 12mm |
| 75702 | 14mm |
| 75551 | 15mm |
| 75703 | 16mm |
| 75704 | 18mm |
| 75552 | 22mm |
| 75553 | 28mm |

TT5 Tank connector

| Art. no. | Size |
|----------|-------------|
| 75520 | 15mm x 1/2" |
| 75521 | 22mm x 3/4" |

TT12 Elbow

| Art. no. | Size |
|----------|------|
| 75530 | 10mm |
| 75531 | 15mm |
| 75532 | 22mm |
| 75533 | 28mm |

TT13 Male elbow

| Art. no. | Size |
|----------|-------------|
| 75540 | 15mm x 1/2" |

TT15 Backplate elbow

| Art. no. | Size |
|----------|-------------|
| 75550 | 15mm x 1/2" |

TT26 Tee, one end reduced

| Art. no. | Size |
|----------|----------------|
| 75582 | 22 x 15 x 15mm |
| 75584 | 28 x 22 x 22mm |

TT25 Tee, reduced branch

| Art. no. | Size |
|----------|----------------|
| 75565 | 15 x 15 x 10mm |
| 75566 | 22 x 22 x 10mm |
| 75567 | 22 x 22 x 15mm |
| 75568 | 28 x 28 x 15mm |
| 75569 | 28 x 28 x 22mm |

TT1R Reducing coupling

| Art. no. | Size |
|----------|-----------|
| 75504 | 5 x 10mm |
| 75505 | 22 x 15mm |

TT3 Straight male connector

| Art. no. | Size |
|----------|-------------|
| 75515 | 15mm x 1/2" |
| 75516 | 22mm x 3/4" |
| 75518 | 28mm x 1" |

TT21S Obtuse street elbow

| Art. no. | Size |
|----------|------|
| 75705 | 12mm |
| 75706 | 14mm |
| 75585 | 15mm |
| 75707 | 16mm |
| 75708 | 18mm |
| 75586 | 22mm |
| 75587 | 28mm |

TT6 Reducer

| Art. no. | Size |
|----------|-----------|
| 75523 | 15 x 10mm |
| 75525 | 22 x 15mm |
| 75526 | 28 x 15mm |
| 75527 | 28 x 22mm |

TT12S Street elbow

| Art. no. | Size |
|----------|-----------|
| 75535 | 10mm |
| 75536 | 10 x 15mm |
| 75537 | 15mm |
| 75538 | 22mm |

TT14 Female elbow

| Art. no. | Size |
|----------|-------------|
| 75545 | 15mm x 1/2" |

TT24 Equal tee

| Art. no. | Size |
|----------|------|
| 75555 | 10mm |
| 75556 | 15mm |
| 75557 | 22mm |
| 75558 | 28mm |

TT26 Tee, one end reduced

| Art. no. | Size |
|----------|----------------|
| 75573 | 22 x 15 x 22mm |
| 75574 | 28 x 15 x 28mm |
| 75575 | 28 x 22 x 28mm |

Tectite Push-fit fittings

Tectite Sprint series (continued)

TT62 Tap connector

| Art. no. | Size |
|----------|-------------|
| 75600 | 10mm x 1/2" |
| 75601 | 15mm x 1/2" |
| 75603 | 22mm x 3/4" |

TT61 Stop end

| Art. no. | Size |
|----------|------|
| 75590 | 10mm |
| 75591 | 15mm |
| 75592 | 22mm |
| 75593 | 28mm |

TT63 Bent tap connector

| Art. no. | Size |
|----------|-------------|
| 75604 | 10mm x 1/2" |
| 75605 | 15mm x 1/2" |

Tectite Push-fit fittings

Tactite Pro Series

TX1 Straight coupling

| Art. no. | Size |
|----------|------|
| 65114 | 15mm |
| 65121 | 22mm |
| 65123 | 28mm |
| 65126 | 35mm |
| 65128 | 42mm |
| 65130 | 54mm |

TX1 Slip straight coupling, slip pattern

| Art. no. | Size |
|----------|------|
| 65141 | 15mm |
| 65143 | 22mm |
| 65144 | 28mm |
| 65145 | 35mm |
| 65146 | 42mm |
| 65147 | 54mm |

TX2 Straight female connector

| Art. no. | Size |
|----------|------------|
| 65206 | 15mm x ½" |
| 65222 | 22mm x ¾" |
| 65223 | 22mm x 1" |
| 65225 | 28mm x 1" |
| 45230 | 35mm x 1¾" |
| 45232 | 42mm x 1½" |
| 45234 | 54mm x 2" |

TX3 Tapered male connector

| Art. no. | Size |
|----------|------------|
| 65267 | 15mm x ½" |
| 65292 | 22mm x ¾" |
| 65294 | 22mm x 1" |
| 65296 | 28mm x 1" |
| 45310 | 35mm x 1¼" |
| 45312 | 42mm x 1½" |
| 45314 | 54mm x 2" |

TX3P Straight male connector

| Art. no. | Size |
|----------|-----------|
| 65358 | 15mm x ½" |
| 65366 | 22mm x ¾" |
| 65368 | 22mm x 1" |
| 65370 | 28mm x 1" |

TX6 Reducer

| Art. no. | Size |
|----------|-----------|
| 65426 | 22 x 15mm |
| 65435 | 28 x 15mm |
| 65438 | 28 x 22mm |
| 45450 | 35 x 15mm |
| 45452 | 35 x 22mm |
| 45454 | 35 x 28mm |
| 45456 | 42 x 15mm |
| 45458 | 42 x 22mm |
| 45460 | 42 x 28mm |
| 45462 | 42 x 35mm |
| 45464 | 54 x 15mm |
| 45466 | 54 x 22mm |
| 45468 | 54 x 28mm |
| 45470 | 54 x 35mm |
| 45472 | 54 x 42mm |

TX12 Elbow*

| Art. no. | Size |
|----------|------|
| 65516 | 15mm |
| 65524 | 22mm |
| 65526 | 28mm |
| 45530 | 35mm |
| 45532 | 42mm |
| 45334 | 54mm |

TX13 Male elbow

| Art. no. | Size |
|----------|-----------|
| 65561 | 15mm x ½" |
| 65576 | 22mm x ¾" |
| 65578 | 28mm x 1" |

TX15 Backplate elbow

| Art. no. | Size |
|----------|-----------|
| 65646 | 15mm x ½" |

TX21S Obtuse street elbow

| Art. no. | Size |
|----------|------|
| 65542 | 15mm |
| 65545 | 22mm |
| 65546 | 28mm |
| 45547 | 35mm |
| 45548 | 42mm |
| 45549 | 54mm |

TX12S Street elbow

| Art. no. | Size |
|----------|------|
| 65496 | 15mm |
| 65500 | 22mm |
| 65502 | 28mm |

TX14 Female elbow

| Art. no. | Size |
|----------|-----------|
| 65606 | 15mm x ½" |
| 65620 | 22mm x ¾" |
| 65622 | 28mm x 1" |

TX21 Obtuse elbow

| Art. no. | Size |
|----------|------|
| 65535 | 15mm |
| 65538 | 22mm |
| 65539 | 28mm |
| 45540 | 35mm |
| 45541 | 42mm |
| 45558 | 54mm |

Tectite Push-fit fittings

Tectite Pro series (continued)

TX27 Tee, one end branch reduced

| Art. no. | Size |
|----------|----------------|
| 65820 | 22 x 15 x 15mm |
| 65822 | 28 x 22 x 22mm |

TX24 Equal tee

| Art. no. | Size |
|----------|------|
| 65666 | 15mm |
| 65676 | 22mm |
| 65680 | 28mm |
| 45680 | 35mm |
| 45682 | 42mm |
| 45684 | 54mm |

TX25 Tee, reduced branch

| Art. no. | Size |
|----------|----------------|
| 65737 | 22 x 22 x 15mm |
| 65744 | 28 x 28 x 15mm |
| 65746 | 28 x 28 x 22mm |
| 45750 | 35 x 35 x 15mm |
| 45752 | 35 x 35 x 22mm |
| 45753 | 35 x 35 x 28mm |
| 45754 | 42 x 42 x 15mm |
| 45756 | 42 x 42 x 22mm |
| 45758 | 42 x 42 x 28mm |
| 45760 | 54 x 54 x 15mm |
| 45762 | 54 x 54 x 22mm |
| 45764 | 54 x 54 x 28mm |
| 45765 | 54 x 54 x 35mm |

TX26 Tee, one end reduced

| Art. no. | Size |
|----------|----------------|
| 65786 | 22 x 15 x 22mm |
| 65790 | 28 x 15 x 28mm |
| 65793 | 28 x 22 x 28mm |

TX30 Female branch tee

| Art. no. | Size |
|----------|----------------|
| 65840 | 15 x 15 x 1/2" |
| 65845 | 22 x 22 x 1/2" |
| 65848 | 35 x 35 x 1/2" |
| 65850 | 42 x 42 x 1/2" |

TX61 Stop end

| Art. no. | Size |
|----------|------|
| 65866 | 15mm |
| 65874 | 22mm |
| 65876 | 28mm |
| 65878 | 35mm |
| 65880 | 42mm |
| 65882 | 54mm |

TX68S Cylinder union

| Art. no. | Size |
|----------|-----------|
| 65930 | 22mm x 1" |

TX68FF Flat faced union adaptor

| Art. no. | Size |
|----------|-------------|
| 65759 | 15mm x 3/4" |

TX62 Tap connector

| Art. no. | Size |
|----------|-------------|
| 65902 | 15mm x 1/2" |
| 65171 | 15mm x 3/4" |
| 65903 | 22mm x 3/4" |

TX63 Bent tap connector

| Art. no. | Size |
|----------|-------------|
| 65922 | 15mm x 1/2" |
| 65924 | 22mm x 3/4" |

Tectite Push-fit fittings

Tectite Classic series

T1 Straight coupling

| Art. no. | Size |
|----------|------|
| 45108 | 10mm |
| 45110 | 12mm |
| 45112 | 14mm |
| 45114 | 15mm |
| 45116 | 16mm |
| 45118 | 18mm |
| 45120 | 20mm |
| 45121 | 22mm |
| 45123 | 28mm |

T1R Reducing coupling

| Art. no. | Size |
|----------|-----------|
| 45155 | 12 x 10mm |
| 45157 | 14 x 12mm |
| 45159 | 15 x 10mm |
| 45161 | 15 x 12mm |
| 45163 | 16 x 12mm |
| 45165 | 16 x 14mm |
| 45167 | 18 x 15mm |
| 45168 | 20 x 18mm |
| 45170 | 22 x 10mm |
| 45172 | 22 x 15mm |
| 45174 | 22 x 18mm |
| 45178 | 28 x 22mm |

T2 Straight female connector

| Art. no. | Size |
|----------|-------------|
| 45190 | 10mm x 3/8" |
| 45192 | 10mm x 1/2" |
| 45194 | 12mm x 3/8" |
| 45196 | 12mm x 1/2" |
| 45200 | 14mm x 3/8" |
| 45202 | 14mm x 1/2" |
| 45204 | 15mm x 3/8" |
| 45206 | 15mm x 1/2" |
| 45208 | 15mm x 3/4" |
| 45210 | 18mm x 1/2" |
| 45212 | 18mm x 3/4" |
| 45220 | 22mm x 1/2" |
| 45222 | 22mm x 3/4" |
| 45223 | 22mm x 1" |
| 45224 | 28mm x 3/4" |
| 45225 | 28mm x 1" |

T3 Tapered male connector

| Art. no. | Size |
|----------|-------------|
| 45250 | 10mm x 3/8" |
| 45252 | 10mm x 1/2" |
| 45254 | 12mm x 3/8" |
| 45256 | 12mm x 1/2" |
| 45265 | 15mm x 3/8" |
| 45267 | 15mm x 1/2" |
| 45286 | 18mm x 1/2" |
| 45288 | 18mm x 3/4" |
| 45290 | 22mm x 1/2" |
| 45292 | 22mm x 3/4" |
| 45294 | 22mm x 1" |
| 45296 | 28mm x 1" |

T3P Straight male connector

| Art. no. | Size |
|----------|-------------|
| 45350 | 12mm x 3/8" |
| 45354 | 14mm x 3/8" |
| 45356 | 14mm x 1/2" |
| 45358 | 15mm x 1/2" |
| 45360 | 15mm x 3/4" |
| 45362 | 16mm x 1/2" |
| 45364 | 22mm x 1/2" |
| 45366 | 22mm x 3/4" |
| 45368 | 22mm x 1" |
| 45370 | 28mm x 1" |

T5 Tank connector

| Art. no. | Size |
|----------|-------------|
| 45390 | 15mm x 1/2" |
| 45394 | 22mm x 1/2" |
| 45396 | 28mm x 1" |

T12 Elbow

| Art. no. | Size |
|----------|------|
| 45510 | 10mm |
| 45512 | 12mm |
| 45514 | 14mm |
| 45516 | 15mm |
| 45518 | 16mm |
| 45520 | 18mm |
| 45522 | 20mm |
| 45524 | 22mm |
| 45526 | 28mm |

Tectite Push-fit fittings

Tectite Classic series (continued)

T12S Street elbow

| Art. no. | Size |
|----------|-----------|
| 45490 | 10mm |
| 45492 | 12mm |
| 45494 | 10 x 15mm |
| 45496 | 15mm |
| 45498 | 18mm |
| 45500 | 22mm |
| 45502 | 28mm |

T13 Male elbow

| Art. no. | Size |
|----------|-------------|
| 45550 | 10mm x 3/8" |
| 45552 | 10mm x 1/2" |
| 45554 | 12mm x 3/8" |
| 45556 | 12mm x 1/2" |
| 45560 | 14mm x 1/2" |
| 45561 | 15mm x 1/2" |
| 45563 | 16mm x 1/2" |
| 45564 | 16mm x 3/4" |
| 45569 | 18mm x 1/2" |
| 45570 | 18mm x 3/4" |
| 45576 | 22mm x 3/4" |
| 45578 | 28mm x 1" |

T21 Obtuse elbow

| Art. no. | Size |
|----------|------|
| 45531 | 12mm |
| 45533 | 14mm |
| 45535 | 15mm |
| 45536 | 16mm |
| 45537 | 18mm |
| 45538 | 22mm |
| 45539 | 28mm |

T24 Equal tee

| Art. no. | Size |
|----------|------|
| 45660 | 10mm |
| 45662 | 12mm |
| 45664 | 14mm |
| 45666 | 15mm |
| 45668 | 16mm |
| 45670 | 18mm |
| 45674 | 20mm |
| 45676 | 22mm |
| 45678 | 28mm |

T6 Reducer

| Art. no. | Size |
|----------|-----------|
| 45410 | 12 x 10mm |
| 45414 | 14 x 12mm |
| 45416 | 15 x 10mm |
| 45418 | 15 x 12mm |
| 45420 | 16 x 12mm |
| 45421 | 16 x 14mm |
| 45423 | 18 x 12mm |
| 45424 | 18 x 15mm |
| 45425 | 22 x 12mm |
| 45426 | 22 x 15mm |
| 45430 | 22 x 18mm |
| 45435 | 28 x 15mm |
| 45437 | 28 x 18mm |
| 45438 | 28 x 22mm |

T15 Backplate elbow

| Art. no. | Size |
|----------|-------------|
| 45630 | 10mm x 1/2" |
| 45638 | 12mm x 1/2" |
| 45640 | 14mm x 1/2" |
| 45646 | 15mm x 1/2" |
| 45648 | 16mm x 1/2" |
| 45650 | 18mm x 1/2" |
| 45652 | 18mm x 3/4" |
| 45654 | 22mm x 3/4" |

T21S Obtuse street elbow

| Art. no. | Size |
|----------|------|
| 45528 | 12mm |
| 45529 | 14mm |
| 45542 | 15mm |
| 45543 | 16mm |
| 45544 | 18mm |
| 45545 | 22mm |
| 45546 | 28mm |

T25 Tee, reduced branch

| Art. no. | Size |
|----------|----------------|
| 45700 | 12 x 12 x 10mm |
| 45710 | 14 x 14 x 12mm |
| 45715 | 15 x 15 x 10mm |
| 45717 | 15 x 15 x 12mm |
| 45719 | 16 x 16 x 12mm |
| 45722 | 16 x 16 x 14mm |
| 45724 | 18 x 18 x 14mm |
| 45726 | 20 x 20 x 16mm |
| 45730 | 22 x 22 x 10mm |
| 45736 | 22 x 22 x 14mm |
| 45737 | 22 x 22 x 15mm |
| 45739 | 22 x 22 x 16mm |
| 45742 | 22 x 22 x 18mm |
| 45744 | 28 x 28 x 15mm |
| 45745 | 28 x 28 x 18mm |
| 45746 | 28 x 28 x 22mm |

Tectite Push-fit fittings

Tectite Classic series (continued)

T26 Tee, one end reduced

| Art. no. | Size |
|----------|----------------|
| 45780 | 15 x 10 x 15mm |
| 45786 | 22 x 15 x 22mm |
| 45788 | 22 x 18 x 22mm |
| 45790 | 28 x 15 x 28mm |
| 45792 | 28 x 18 x 28mm |
| 45793 | 28 x 22 x 28mm |

T30 Female branch tee

| Art. no. | Size |
|----------|----------------|
| 45823 | 12 x 12mm x ½" |
| 45840 | 15 x 15mm x ½" |
| 45825 | 16 x 16mm x ½" |
| 45845 | 22 x 22mm x ½" |
| 45846 | 22 x 22mm x ¾" |

T14 Female elbow

| Art. no. | Size |
|----------|--------------|
| 45590 | 10mm x 3/8 " |
| 45592 | 10mm x ½" |
| 45594 | 12mm x 3/8" |
| 45596 | 12mm x ½" |
| 45600 | 14mm x ½" |
| 45606 | 15mm x ½" |
| 45608 | 16mm x ½" |
| 45609 | 16mm x ¾" |
| 45614 | 18mm x ½" |
| 45615 | 18mm x ¾" |
| 45620 | 22mm x ¾" |
| 45622 | 28mm x 1" |

T62S Tap connector

| Art. no. | Size |
|----------|-----------|
| 45910 | 15mm x ½" |
| 45912 | 15mm x ¾" |
| 45914 | 22mm x ¾" |

T68FF Flat faced union adaptor*

| Art. no. | Size |
|----------|-----------|
| 4075 | 15mm x ¾" |

TM81 Manifold

| Art. no. | Size |
|----------|---------------------|
| 45942 | 22 x 22 x 10 x 10mm |

T27 Tee, one end and branch reduced

| Art. no. | Size |
|----------|----------------|
| 45810 | 15 x 10 x 10mm |
| 45812 | 15 x 12 x 12mm |
| 45815 | 16 x 14 x 14mm |
| 45819 | 22 x 18 x 18mm |
| 45820 | 22 x 15 x 15mm |
| 45821 | 28 x 18 x 18mm |
| 45822 | 28 x 22 x 22mm |

T61 Stop end

| Art. no. | Size |
|----------|------|
| 45860 | 10mm |
| 45862 | 12mm |
| 45864 | 14mm |
| 45866 | 15mm |
| 45868 | 16mm |
| 45870 | 18mm |
| 45872 | 20mm |
| 45874 | 22mm |
| 45876 | 28mm |

T62 Tap connector

| Art. no. | Size |
|----------|-----------|
| 45900 | 10mm x ½" |
| 45902 | 15mm x ½" |
| 45171 | 15mm x ¾" |
| 45903 | 22mm x ¾" |

T63 Bent tap connector

| Art. no. | Size |
|----------|-----------|
| 45920 | 10mm x ½" |
| 45922 | 15mm x ½" |
| 45924 | 22mm x ¾" |

TM80 Manifold*

| Art. no. | Size |
|----------|----------------|
| 45940 | 22 x 22 x 10mm |

Tectite Push-fit fittings

Tectite 316 SS series* (stainless steel)

TS1 Straight coupling

| Art. no. | Size |
|----------|------|
| 25114 | 15mm |
| 25118 | 18mm |
| 25121 | 22mm |
| 25123 | 28mm |
| 25126 | 35mm |
| 25128 | 42mm |
| 25130 | 54mm |

TS2 Straight female connector

| Art. no. | Size |
|----------|---------------|
| 25206 | 15mm x 1/2" |
| 25210 | 18mm x 1/2" |
| 25212 | 18mm x 3/4" |
| 25220 | 22mm x 1/2" |
| 25222 | 22mm x 3/4" |
| 25225 | 28mm x 1" |
| 25230 | 35mm x 1 1/4" |
| 25232 | 42mm x 1 1/2" |
| 25234 | 54mm x 2" |

TS3 Tapered male connector

| Art. no. | Size |
|----------|---------------|
| 25267 | 15mm x 1/2" |
| 25286 | 18mm x 1/2" |
| 25288 | 18mm x 3/4" |
| 25292 | 22mm x 3/4" |
| 25296 | 28mm x 1" |
| 25310 | 35mm x 1 1/4" |
| 25312 | 42mm x 1 1/2" |
| 25314 | 54mm x 2" |

TS6 Reducer

| Art. no. | Size |
|----------|-----------|
| 25424 | 18 x 15mm |
| 25426 | 22 x 15mm |
| 25430 | 22 x 18mm |
| 25435 | 28 x 15mm |
| 25437 | 28 x 18mm |
| 25438 | 28 x 22mm |
| 25452 | 35 x 22mm |
| 25454 | 35 x 28mm |
| 25458 | 42 x 22mm |
| 25460 | 42 x 28mm |
| 25462 | 42 x 35mm |
| 25470 | 54 x 35mm |
| 25472 | 54 x 42mm |

TS12 Elbow

| Art. no. | Size |
|----------|------|
| 25516 | 15mm |
| 25520 | 18mm |
| 25524 | 22mm |
| 25528 | 28mm |
| 25530 | 35mm |
| 25532 | 42mm |
| 25334 | 54mm |

TS12S Street elbow

| Art. no. | Size |
|----------|------|
| 25496 | 15mm |
| 25498 | 18mm |
| 25500 | 22mm |
| 25502 | 28mm |

TS13 Male elbow

| Art. no. | Size |
|----------|-------------|
| 25561 | 15mm x 1/2" |
| 25569 | 18mm x 1/2" |
| 25576 | 22mm x 3/4" |
| 25578 | 28mm x 1" |

TS14 Female elbow

| Art. no. | Size |
|----------|-------------|
| 25606 | 15mm x 1/2" |
| 25614 | 18mm x 1/2" |
| 25615 | 18mm x 3/4" |
| 25620 | 22mm x 3/4" |
| 25622 | 28mm x 1" |

TS15 Back plate elbow

| Art. no. | Size |
|----------|-------------|
| 25646 | 15mm x 1/2" |
| 25650 | 18mm x 1/2" |
| 25654 | 22mm x 3/4" |

TS21 Obtuse elbow

| Art. no. | Size |
|----------|------|
| 26043 | 15mm |
| 26045 | 18mm |
| 26047 | 22mm |
| 26048 | 28mm |
| 26049 | 35mm |
| 26050 | 42mm |
| 26051 | 54mm |

Tectite Push-fit fittings

Tectite 316 SS series (continued)

TS12S Obtuse street elbow

| Art. no. | Size |
|----------|------|
| 26063 | 15mm |
| 26065 | 18mm |
| 26067 | 22mm |
| 26068 | 28mm |
| 26069 | 35mm |
| 26010 | 42mm |
| 26071 | 54mm |

TS24 Equal tee

| Art. no. | Size |
|----------|------|
| 25666 | 15mm |
| 25670 | 18mm |
| 25676 | 22mm |
| 25678 | 28mm |
| 25680 | 35mm |
| 25682 | 42mm |
| 25684 | 54mm |

TS25 Tee, reduced branch

| Art. no. | Size |
|----------|----------------|
| 25725 | 18 x 18 x 15mm |
| 25737 | 22 x 22 x 15mm |
| 25742 | 22 x 22 x 18mm |
| 25744 | 28 x 28 x 15mm |
| 25745 | 28 x 28 x 18mm |
| 25746 | 28 x 28 x 22mm |
| 25750 | 35 x 35 x 15mm |
| 25752 | 35 x 35 x 22mm |
| 25753 | 35 x 35 x 28mm |
| 25756 | 42 x 42 x 22mm |
| 25758 | 42 x 42 x 28mm |
| 25762 | 54 x 54 x 22mm |
| 25764 | 54 x 54 x 28mm |
| 25765 | 54 x 54 x 35mm |
| 25766 | 54 x 54 x 42mm |

TS30 Female branch tee

| Art. no. | Size |
|----------|------------------|
| 25840 | 15 x 15mm x 1/2" |
| 25843 | 18 x 18mm x 1/2" |
| 25845 | 22 x 22mm x 1/2" |
| 25846 | 22 x 22mm x 3/4" |
| 25847 | 28 x 28mm x 1/2" |
| 25848 | 35 x 35mm x 1/2" |
| 25850 | 42 x 42mm x 1/2" |

TS61 Stop end

| Art. no. | Size |
|----------|------|
| 25866 | 15mm |
| 25870 | 18mm |
| 25874 | 22mm |
| 25876 | 28mm |
| 25878 | 35mm |
| 25880 | 42mm |
| 25882 | 54mm |

TS62 Tap connector

| Art. no. | Size |
|----------|-------------|
| 25902 | 15mm x 1/2" |
| 25903 | 22mm x 3/4" |

Tectite Push-fit fittings

TS1 Straight coupling

| Art. no. | Size |
|----------|------|
| 25114 | 15mm |
| 25118 | 18mm |
| 25121 | 22mm |
| 25123 | 28mm |
| 25126 | 35mm |
| 25128 | 42mm |
| 25130 | 54mm |

TS2 Straight female connector

| Art. no. | Size |
|----------|-------------|
| 25206 | 15mm x ½" |
| 25210 | 18mm x ½" |
| 25212 | 18mm x ¾" |
| 25220 | 22mm x ½" |
| 25222 | 22mm x ¾" |
| 25225 | 28mm x 1" |
| 25230 | 35mm x 1 ¼" |
| 25232 | 42mm x 1 ½" |
| 25234 | 54mm x 2" |

TS3 Tapered male connector

| Art. no. | Size |
|----------|-------------|
| 25267 | 15mm x ½" |
| 25286 | 18mm x ½" |
| 25288 | 18mm x ¾" |
| 25292 | 22mm x ¾" |
| 25296 | 28mm x 1" |
| 25310 | 35mm x 1 ¼" |
| 25312 | 42mm x 1 ½" |
| 25314 | 54mm x 2" |

TS6 Reducer

| Art. no. | Size |
|----------|-----------|
| 25424 | 18 x 15mm |
| 25426 | 22 x 15mm |
| 25430 | 22 x 18mm |
| 25435 | 28 x 15mm |
| 25437 | 28 x 18mm |
| 25438 | 28 x 22mm |
| 25452 | 35 x 22mm |
| 25454 | 35 x 28mm |
| 25458 | 42 x 22mm |
| 25460 | 42 x 28mm |
| 25462 | 42 x 35mm |
| 25470 | 54 x 35mm |
| 25472 | 54 x 42mm |

TS12 Elbow

| Art. no. | Size |
|----------|------|
| 25516 | 15mm |
| 25520 | 18mm |
| 25524 | 22mm |
| 25528 | 28mm |
| 25530 | 35mm |
| 25532 | 42mm |
| 25334 | 54mm |

TS12S Street elbow

| Art. no. | Size |
|----------|------|
| 25496 | 15mm |
| 25498 | 18mm |
| 25500 | 22mm |
| 25502 | 28mm |

TS13 Male elbow

| Art. no. | Size |
|----------|-----------|
| 25561 | 15mm x ½" |
| 25569 | 18mm x ½" |
| 25576 | 22mm x ¾" |
| 25578 | 28mm x 1" |

TS14 Female elbow

| Art. no. | Size |
|----------|-----------|
| 25606 | 15mm x ½" |
| 25614 | 18mm x ½" |
| 25615 | 18mm x ¾" |
| 25620 | 22mm x ¾" |
| 25622 | 28mm x 1" |

TS15 Back plate elbow

| Art. no. | Size |
|----------|-----------|
| 25646 | 15mm x ½" |
| 25650 | 18mm x ½" |
| 25654 | 22mm x ¾" |

TS21 Obtuse elbow

| Art. no. | Size |
|----------|------|
| 26043 | 15mm |
| 26045 | 18mm |
| 26047 | 22mm |
| 26048 | 28mm |
| 26049 | 35mm |
| 26050 | 42mm |
| 26051 | 54mm |

Tectite Push-fit fittings

Tectite 316 SS series (continued)

TS12S Obtuse street elbow

| Art. no. | Size |
|----------|------|
| 26063 | 15mm |
| 26065 | 18mm |
| 26067 | 22mm |
| 26068 | 28mm |
| 26069 | 35mm |
| 26010 | 42mm |
| 26071 | 54mm |

TS24 Equal tee

| Art. no. | Size |
|----------|------|
| 25666 | 15mm |
| 25670 | 18mm |
| 25676 | 22mm |
| 25678 | 28mm |
| 25680 | 35mm |
| 25682 | 42mm |
| 25684 | 54mm |

TS25 Tee, reduced branch

| Art. no. | Size |
|----------|----------------|
| 25725 | 18 x 18 x 15mm |
| 25737 | 22 x 22 x 15mm |
| 25742 | 22 x 22 x 18mm |
| 25744 | 28 x 28 x 15mm |
| 25745 | 28 x 28 x 18mm |
| 25746 | 28 x 28 x 22mm |
| 25750 | 35 x 35 x 15mm |
| 25752 | 35 x 35 x 22mm |
| 25753 | 35 x 35 x 28mm |
| 25756 | 42 x 42 x 22mm |
| 25758 | 42 x 42 x 28mm |
| 25762 | 54 x 54 x 22mm |
| 25764 | 54 x 54 x 28mm |
| 25765 | 54 x 54 x 35mm |
| 25766 | 54 x 54 x 42mm |

TS30 Female branch tee

| Art. no. | Size |
|----------|------------------|
| 25840 | 15 x 15mm x 1/2" |
| 25843 | 18 x 18mm x 1/2" |
| 25845 | 22 x 22mm x 1/2" |
| 25846 | 22 x 22mm x 3/4" |
| 25847 | 28 x 28mm x 1/2" |
| 25848 | 35 x 35mm x 1/2" |
| 25850 | 42 x 42mm x 1/2" |

TS61 Stop end

| Art. no. | Size |
|----------|------|
| 25866 | 15mm |
| 25870 | 18mm |
| 25874 | 22mm |
| 25876 | 28mm |
| 25878 | 35mm |
| 25880 | 42mm |
| 25882 | 54mm |

TS62 Tap connector

| Art. no. | Size |
|----------|-------------|
| 25902 | 15mm x 1/2" |
| 25903 | 22mm x 3/4" |

Tectite Push-fit fittings

Tectite 2013 series

T1/T270 Coupling

| Art. no. | Size |
|----------|-------|
| 45114 | 15 mm |
| 45121 | 22 mm |

T25/T130 Tee

| Art. no. | Size |
|----------|-----------------------------------|
| 45737 | 22 x 22 x 15 mm / 22 x 15 x 22 mm |

T3P Male Coupling

| Art. no. | Size |
|----------|-----------|
| 45358 | 15 mm x ½ |

T26/T130 Tee

| Art. no. | Size |
|----------|-----------------------------------|
| 45786 | 22 x 15 x 22 mm / 22 x 22 x 15 mm |

T6/T243 Reducer

| Art. no. | Size |
|----------|------------|
| 45426 | 22 x 15 mm |

T27/T130 Tee Reduced End Branch

| Art. no. | Size |
|----------|-----------------|
| 45820 | 22 x 15 x 15 mm |

T12/T090 Elbow

| Art. no. | Size |
|----------|-------|
| 45516 | 15 mm |
| 45524 | 22 mm |

T61/T301 Stop end

| Art. no. | Size |
|----------|-------|
| 45866 | 15 mm |
| 45874 | 22 mm |

T12S/T092 Street Elbow

| Art. no. | Size |
|----------|-------|
| 45496 | 15 mm |
| 45500 | 22 mm |

T62/T062 Tap Connector

| Art. no. | Size |
|----------|--------------|
| 45902 | 15 mm x ½ St |
| 45171 | 15 mm x ¾ St |
| 45903 | 22 mm x ¾ |

T24/T130 Equal Tee

| Art. no. | Size |
|----------|-------|
| 45666 | 15 mm |
| 45676 | 22 mm |

GODKENDELSESINDEHAVER:
Pegler Yorkshire Ltd.
St. Catherines Avenue
GB-DN4 8DF Doncaster
Telefon +44 113 2701104
Telefax: +44 113 2725291
Internet: pegleryorkshire.co.uk

Dokumentation af mekaniske/fysiske karakteristika for:
Stikfittings til kobberør og PEX-rør
TECTITE CLASSIC og TECTITE 316
dim. 10 – 28 mm

FABRIKAT:
Pegler Yorkshire Limited, England

MÆRKNING:

- Fabrikantmærke: TECTITE
- Dimension
- Godkendelsesnummer
- Godkendelsesmærke: 

KVALITETSKONTROL:

Godkendelsesindehaver opretholder
Obligatorisk kontrolaftale med
Teknologisk Institut, Aarhus.

Der er med denne godkendelse alene taget stilling til Bygningsreglementets krav om dokumentation af de mekaniske/fysiske karakteristika jf. § 8.4.1, stk. 5.

Godkendelsesindehaver er pligtig til, jf. Bygningsreglementets krav jf. § 8.2.4.2, stk. 2, at byggevaren er godkendt af Energistyrelsen, ifølge bekendtgørelse om udstedelse af godkendelser for byggevarer i kontakt med drikkevand.

BETINGELSER FOR MONTERING OG BRUG:

Højeste forekommende driftstryk i installationen må ikke overstige 1000 kPa.

For rør i bygning skal samlingerne være udskiftelige og anbragt, så de er fritliggende, eller monteret i udsparinger eller foringsrør på en måde, så eventuelle utætheder umiddelbart kan konstateres.

TECTITE stikfittings anvendes i brugsvandsinstallationer til samling af hårde og bløde kobberør i dimensionerne 10 – 28 mm samt PEX-rør i dimensionerne 12 – 28 mm.

Ved samling af bløde kobberør og PEX-rør skal den til koblingen hørende støttebøsning anvendes.

Samlingen udføres i øvrigt i overensstemmelse med godkendelsesindehaverens monteringsvejledning.

BESKRIVELSE OG TEKNISKE DATA:

| | |
|-----------|---|
| Udførelse | Koblingen består af 6 dele, koblingshus, tætningsring, støttering, låsering og udløserring. Låseringen er konisk og radielt opslidset, så der dannes tænder mod centrum. Efter indstikning af kobberøret fastholdes dette af låseringens tænder. Samlingen kan demonteres ved at presse udløserringen ind i koblingen, hvorved låseringens tænder frigøres. |
| Materiale | Koblings hus er af afzinkningsbestandigt messing, rustfrit stål (AISI 316) eller rødgoods, låsering er af stål, tætningsring er af EPDM-gummi, støttering og udløserring er af plast. |
| Dimension | Hårde og bløde kobberør: 10 – 28 mm Forkromede kobberør: 10 – 15 mm PEX-rør: 12 – 28 mm |

Thomas Bruun