

MINIM SHOCK ARRESTOR

Introduction

The inta minim shock arrestor kit is specifically designed to combat the problem of the expansion of water in the cold supply pipe in combi boiler installations that are fitted in close proximity to a water meter.

It is a widely acknowledged problem within the heating industry that in some installations where a water meter has been installed close to the boiler there have been reported instances of property damage and leaks caused from water expansion between the outlet of the water meter and the boiler.

The cause of this problem is due to the non return valves normally installed along with water meters not allowing for the expansion of water that would normally be taken up by longer pipe runs.

Inta have worked closely with the industry to develop the inta minim shock arrestor kit which provides a simple, in line solution to relieve problems associated with excess pressure by absorbing any potential increase in pressure within the pipework which helps prevent potentially costly leaks and repairs.



- Absorbs expansion between the water meter and boiler
- Protects system components from excess pressure
- Reduces the risk of property damage and leaks
- Suitable for both new and retro fit installations
- Available in both 15mm and 22mm
- WRAS approved
- Maximum working pressure - 15 Bar
- Factory pre-charge 3.5 Bar
- 2 year warranty

Product Range

Description	Code
inta mini shock arrestor kit - 15mm	MSAK15
inta mini shock arrestor kit - 22mm	MSAK22
0.16ltr Inox Pro shock arrestor vessel	Z1-300016SSD
15mm x 15mm x 1/2" tee	TP1023
22mm x 22mm x 1/2" tee	TP1014



MINIM SHOCK ARRESTOR

Unprotected installation

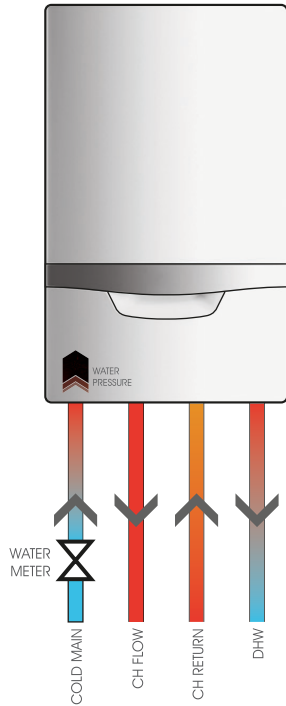

As the water in the cold main begins to warm, the expanding water volume begins to put increasing pressure on system components, increasing the chance of failure and leaks.

Installation protected with the inta MINIM shock arrester kit

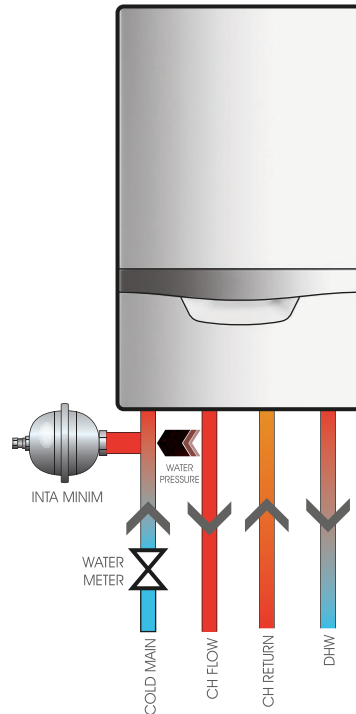

With the inta MINIM shock arrester kit installed between the water meter and boiler, system components are protected as the expanded water volume is harmlessly absorbed by the shock arrester.

Technical specification

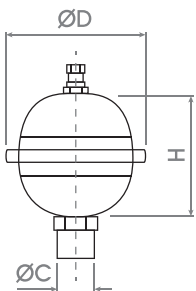

capacity	0.16 litre
Ø D	82
H	72
C	1/2"

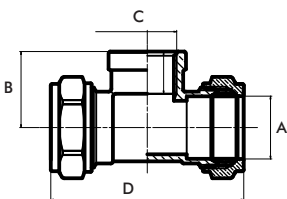

A	15mm	22mm
B	28mm	27mm
C	1/2"	1/2"
D	65mm	69mm

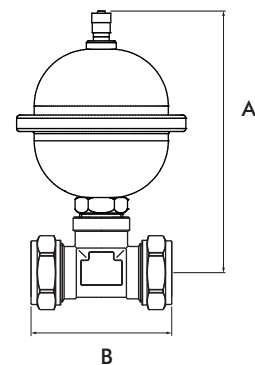

	A	B
15mm	129mm	65mm
22mm	130mm	69mm