



# Rainwater Systems



[marleypd.co.uk](http://marleypd.co.uk)

## Marley Rainwater Systems

The Marley Plumbing & Drainage rainwater range consists of five gutter profiles and three downpipe options. Advanced Life4 technology on four of the key profiles, coupled with the benefits of the easyclip and notching capability combine to make the Marley rainwater range the most comprehensive available.

### Production information

Information on the complete range of Marley Plumbing & Drainage system solutions is available to download from [marleypd.co.uk](http://marleypd.co.uk) or available via the literature hotline 01622 852585.



## Contents

4	The systems
6	Life4
8	Key components
10	Roof drainage design
12	Installation data
14	Gutter jointing
16	Downpipes
18	British & European Standards
19	Marley system solutions
20-35	Product specifications

# The systems



## Deepflow 110 x 75mm semi-elliptical system

Still the market leader, the Deepflow semi-elliptical profile produces self cleansing flow resulting in a very high capacity. Deepflow can be installed using a notched or notchless joint (see page 14-15 for details).

**Downpipe:**

68mm  65mm

**Colours available:**



## Clip-master 112 x 49mm nominal half round system

Clip-master is a practical, easy to install PVCu nominal half round gutter system which is compatible with most other manufacturers' half round systems. Clip-master can be installed using a notched or notchless joint. (see page 14-15 for full details).

**Downpipe:**

68mm  65mm

**Colours available:**



## Flowline 112 x 60mm rectilinear system

Flowline is an attractive rectilinear profile PVCu gutter system, capable of carrying capacities in excess of standard half round gutters. Flowline is the aesthetic choice for larger roof areas. Flowline can be installed using a notched or notchless joint (see page 14-15 for full details).

**Downpipe:**

68mm  65mm

**Colours available:**



## Deepflow150 155 x 98mm high capacity semi-elliptical system

Deepflow150 is a larger version of the Deepflow profile and is ideal for small to medium commercial projects, flats and industrial applications. Capable of carrying up to 6.0 litres a second. Deepflow150 can be installed using a notched or notchless joint (see page 14-15 for full details).

**Downpipe:**

82mm

**Colours available:**



## Classic 116 x 75mm ogee style system

Classic is a bold, highly decorative, Ogee style PVCu gutter system, featuring both internal and external fascia brackets. All Classic fittings are supplied complete with clips and seals. Outlets and unions incorporate screw fixing points to anchor fittings for the control of thermal movement.

**Downpipe:**

68mm  65mm

**Colours available:**



## Applications

The choice of size and profile means that the range includes a system for almost any building or application.



Rainwater system	Conservatories	Small to medium houses	Medium to large houses	Flats, small to medium commercial projects
Deepflow	●	●	●	●
Clip-master	●	●	●	●
Flowline	●	●	●	●
Deepflow150			●	●
Classic	●	●	●	●

● Ideal application ● Suitable



## Rainwater systems that stay looking better for longer

We're all affected by the steady advance of time, as years of exposure affects how everything looks. To combat this Marley Plumbing & Drainage have advanced their manufacturing process to create Life4.

### Looks better...

Life4 rainwater systems can withstand exposure for up to four times longer than standard PVCu rainwater gutters and downpipes and have high gloss levels that are consistent with the fittings, improving the overall aesthetic of the system.

### ...for longer

Not only do Life4 products look better, they last longer. Life4 products have been exposed to up to four times the European weathering test duration and performed admirably (see right).



### Life4 – the performance standard

The benchmark for weathering tests for rainwater systems is set out within the European standards\*. The weathering test essentially mimics actual conditions, but also accelerates them in order that long term performance may be assessed. Life4 products have been assessed and can perform up to four times longer than standard PVCu.

### Life4 – the science of production

Life4 uses a higher specification material to form a capping layer on the outside of the gutter or pipe. This material is by its very nature more durable and has a high gloss finish. The inside layer of the product is standard PVCu. The overall system contains a minimum 15% recycled material.

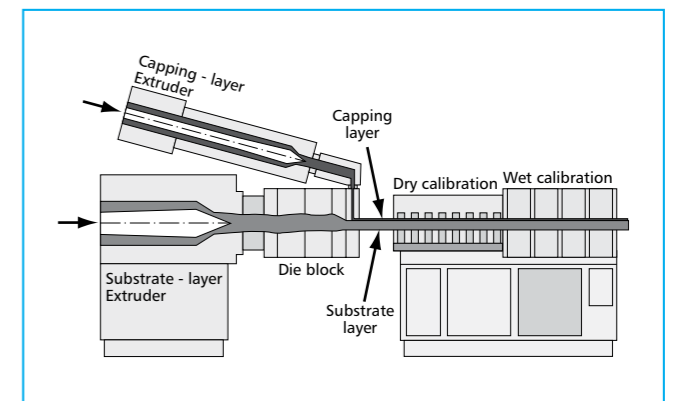

\*BS EN 607: Eaves gutters and fittings – PVCu and EN 12200-1: Plastics rainwater piping systems for above ground external use – PVCu. (These standards replace the previous British Standard, BS4576.)

# Key components

Marley rainwater systems offer complete roof drainage solutions for a variety of building sizes and styles. Pictured is a selection of key components within the range. For rainwater product specifications, see pages 20 – 35.



### Socket clip

The socket clip fits neatly around the iconic Marley socket, keeping the clip firmly in place.

### The iconic Marley socket

The origins of the iconic double 'bump' on our rainwater pipe socket stem from the fact that Marley was the first company in the UK to manufacture rainwater gutter. The design emulated the traditional material most often used for drain pipes, cast iron.



### Easyclip

Deepflow, Clip-master, Flowline and Deepflow150 rainwater systems benefit from the Marley easyclip, which makes jointing both easy and reliable. The easyclip has twin compression tabs, which apply downward pressure onto the gutter seal, to ensure a watertight joint. A positive 'click' is made when the gutter is in place. The easyclip also makes life easy if you need to dismantle the joint.



Easyclip

### Notch adaptor (RGNA1)

It is possible to adapt the easyclip to make fittings suitable for 'notch' jointing, by fitting a 'notch adaptor' into the centre of the easyclip. The adaptor will then fit into a notch cut into the back of the gutter.

This is an effective way of allowing gutter to expand and contract due to temperature change, without gutter and fitting pulling apart. There is also no need to anchor unions and outlets to the fascia, an ideal solution when using rafter arm brackets (see page 13).



Notch adaptor (RGNA1)

### Pipe clips

Two different pipe clip fixing methods are available. A one piece clip or a two piece clip to fit both the downpipe and pipe socket. These are used with backplate RCB300 and allow for adjustment.



One piece pipe clip



Two piece pipe clip

### Hopper head (RH252)

Designed with a curved front the RH252 hopper head is suitable for use with the 68mm circular or 65mm square downpipe.



With square downpipe



With circular downpipe

### Rain diverter (RD25R)

The need to reuse rainwater has become a way of life. The Marley rain diverter provides a simple solution for connecting downpipe to a water butt to capture this precious resource. Suitable for use with 68mm circular or 65mm square PVCu downpipes and available in black, brown, grey and white.



Rain diverter (RD25R)

### Side fixing points

Side fixing points on outlets allow fast fixing, whether power or hand tools are used.



Running outlet with side fixing points

### Fascia bracket roller bars

The fascia brackets on all rainwater systems feature roller bars to aid thermal movement.

Fascia bracket

### Gutter adaptors

Gutter adaptors to enable connection from Clip-master to Flowline, half round to cast iron or Clip-master to Ogee cast aluminium are all available as standard items.



Clip-master to Flowline adaptor (RGA2R)

Half round to cast iron adaptor (RGA1R). Also suitable for adapting 100mm to 112mm half round

Clip-master to Ogee cast aluminium adaptor (RGA4 [shown] & RGA5)

### Drain adaptors

Drain adaptors allow connection from 65mm square to 68mm circular plain and socketed pipe.



Flexible rubber adaptor (RA42)

65mm square socket to 68mm socketed pipe adaptor (RLE2)

65mm square socket to 68mm plain ended pipe adaptor (RLE4)

## Design basis

To assess the suitability of a gutter system to drain the roof of a building the following factors need to be taken into consideration:

1. The effective roof area to be drained.
2. Rainfall intensity.
3. The flow characteristics of the gutter system.
4. The number and position of downpipes.

### 1. Effective roof area

The effective roof area can be determined by calculation in accordance with the following:

- BS EN 12056-3: Roof drainage layout and calculations.
- The Building Regulations 2002 Approved Document H, Part H3.

The formula and example shown below reflects the method used in the above standard to calculate effective roof area.

#### Multiplication factors

An alternative approach to that described above is the use of multiplication factors to establish effective roof area. From plan area the appropriate factor for the roof slope can be applied to determine the effective area.

This method is similar to that shown in Approved Document H of the Building Regulations. The table below provides a wider range of factors to enable accurate assessment of effective roof area to be determined.

Roof pitch	Factor	Roof pitch	Factor
10°	1.088	30°	1.288
12.5°	1.111	32.5°	1.319
15°	1.134	35°	1.350
17.5°	1.158	37.5°	1.384
20°	1.182	40°	1.419
22.5°	1.207	42.5°	1.459
25°	1.233	45°	1.500
27°	1.260	47.5°	1.547

### Vertical surfaces

Where pitched roofs abut vertical walls the catchment area is likely to be increased as a result of wind driven rain. To allow for this half the vertical surface area of the wall should be added to the effective area of the sloping roof.

### Flat roofs

For roofs with a pitch of less than 10°, the effective area is taken as the plan area.

## 2. Rainfall intensity

The Building Regulations 2002 Approved Document H and BS EN 12056-3: 2000 provide detailed information on rainfall throughout the UK by geographical location and frequency of occurrence. The flow rates shown below for Marley PVCu gutter systems have been determined from tests carried out in accordance with the test procedure in BS EN 12056-3.

### Gutter selection

Although aesthetic appearance is an important aspect in the selection of a particular gutter system, the following factors also need to be taken into consideration as they could influence the final choice of system.

- The size of gutter and its flow capacity.
- Whether the gutter is fitted level or to a fall.
- If end or centre outlet position for downpipes are adopted.
- The length of gutter to an outlet/downpipe.

## 3. Flow capacity

The maximum flow capacity of different Marley gutter systems can be compared from the tables shown below. The capacity of each system varies depending on profile, size and whether the gutter is fitted level or to a fall. For design purposes eaves gutters are normally sized to ensure the calculated run-off does not exceed 90% of the gutter capacity. It is also recommended that gutters are fixed level as this enables the gutter to be fitted as high as possible to ensure the correct relationship is maintained at the roof edge.

### Gutter length

On long runs frictional resistance can reduce gutter capacity and efficiency. To allow for this, reduction factors can be applied or gutters sized to allow freeboard in accordance with BS EN 12056-3: recommendations.

### Effect of valleys

Where valleys occur it is good practice to position an outlet adjacent to the internal angle to deal with the concentrated discharge that is likely at such points during peak flow conditions. Depending on the size of roof it may also be beneficial to fit a corner hopper where the flow is considerable.

## Long roofs

The spread of water as it leaves the roof edge varies considerably depending on the roof surface and pitch. On long roofs it may be necessary to select a wider gutter than capacity calculations would normally dictate. This is particularly important with sheet metal or similar profiled roofs where there is a tendency for the discharge to follow the roof angle and overshoot the gutter.

## 4. Rainwater pipe sizes

With the exception of the Deepflow150 gutter system which has an 82mm diameter downpipe, all other Marley PVCu gutter systems incorporate outlets suitable for 68mm circular or 65mm square rainwater pipes. This size of downpipe has been selected as it has the necessary capacity to accommodate the maximum flow from any of the gutter systems.

## 5. Hopper Heads

The flow capacities of different size hopper heads are shown in the table below and are based on a rainfall intensity of 0.021 l/s per square metre of roof area.

Product Code	Pipe Size	Roof Area m <sup>2</sup>	Flow rate litres/second
RH252	68mm	247m <sup>2</sup>	5.14l/s
RH25	68mm	360m <sup>2</sup>	7.56l/s
SH30	82mm	196m <sup>2</sup>	4.11l/s
SH40	110mm	720m <sup>2</sup>	15.12l/s

### Effective roof area

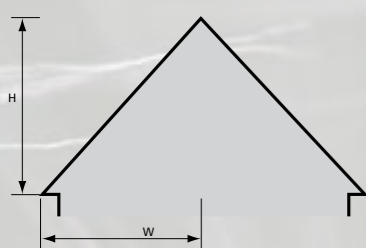

$(\frac{H}{2}) + W \times L = m^2$   
For example a roof 4m high x 4m wide x 10m long  
 $2 + 4 \times 10 = 60m^2$

### Multiplication factor method

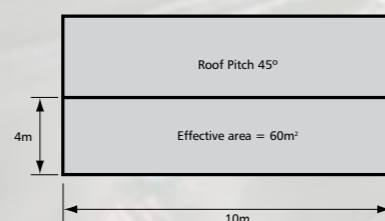

Using the same roof dimensions as the example above with a 45° roof pitch.  
 $4m \text{ wide} \times 10m \text{ long} \times 1.5 = 60m^2$

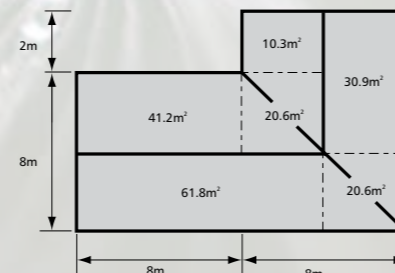

### Outlet at one end

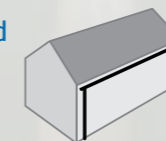

Gutter system	level		fall 1:600	
	m <sup>2</sup>	l/s	m <sup>2</sup>	l/s
Clip-master	43	0.90	48	1.00
Flowline	70	1.46	84	1.75
Deepflow	90	1.90	110	2.31
Classic	103	2.16	-	-
Deepflow150	133	2.80	-	-

### Outlet at one end with an angle within 2m of outlet

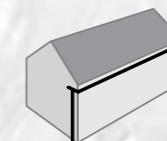

Gutter system	level		fall 1:600	
	m <sup>2</sup>	l/s	m <sup>2</sup>	l/s
Clip-master	39	0.81	43	0.95
Flowline	63	1.31	76	1.58
Deepflow	81	1.70	99	2.07
Classic	93	1.94	-	-

For gutters with angles further than 2m from the outlet increase the above figures by 5%

### Outlet in centre



Gutter system	level		fall 1:600	
	m <sup>2</sup>	l/s	m <sup>2</sup>	l/s
Clip-master	84	1.75	92	1.92
Flowline	135	2.84	170	3.40
Deepflow	185	3.90	226	4.75
Classic	216	4.55	-	-
Deepflow150	286	6.00	-	-

## Gutter position

The spread of water as it leaves the roof edge can vary considerably depending on the rainfall intensity, type of roof surface and the pitch of the roof. BS EN 12056-3: recommends that eaves gutters should be fitted in such a position that they intercept the flow at the roof edge and that gutters are fitted centrally under the roof tile and close beneath it.

Gutters can be installed level or with a nominated gradient of 1:600. If fitted to a fall, care should be taken to ensure the top of the gutter does not fall below the roof tile to such an extent that the water will pass over the front edge of the gutter. It is also important that the eaves course of the tile or slate should not project too far over the fascia board and a maximum of 50mm is recommended for 112-125mm nominal size gutters.

## Fascia brackets

All Marley PVCu gutter fascia brackets have been tested to the loading requirements as detailed in BS EN 1462 and perform in excess of the highest classification, Class H heavy duty, which requires brackets to support a dead weight load of 75kg, to simulate snow load.

However, in areas where particularly high snow falls and severe icing might be expected, it is recommended that snow boards be fitted to the eaves of the pitched roofs. This precaution should also be considered wherever sliding snow might cause damage or injury to structures or persons below.

It is recommended that brackets are fixed with the aid of a string line to maintain alignment and bracket centres must not exceed 1m maximum centres. When fixing to cellular fascia boards the two outer most

fixing holes must be used and 1 1/4" x 10g (32mmx5mm) pan or round head non-ferrous screws must be used. The use of countersunk screws is not recommended.

When fixing to cellular fascia boards of less than 16mm thick, a timber support batten should be fitted behind to ensure a secure fixing is obtained. To improve the loading characteristics of the gutter system, fascia bracket centres can be reduced but in areas of the country that experience frequent heavy snow fall, the use of snow boards is recommended as advised in BS EN 12056-3.

## Gutter brackets

Gutter unions, outlets and stopends must have a fascia bracket fitted within 150mm of one side of the fitting for support.

Internal and external angles require supporting brackets positioned on both sides within 150mm.

The use of the gutter bracket centre fixing hole is not recommended and is provided to facilitate the adjustable rafter arm brackets RSA1A and RTA1A.



## Rafter arm brackets

Rafter arm brackets can be used with all Marley gutter systems. Additional structural fixings should be provided when used with a clip-jointed gutter system, to enable key fittings to be anchored and supported for the control of thermal movement.

It is recommended that notched gutters are used on buildings without fascia boards as key fittings such as unions and outlets do not need to be secured and can be positioned adjacent to structural fixing points. Top rafter brackets, RTA1 or RTA1A, will need to be fitted before the roof is tiled. Side rafter brackets, RSA1 or RSTA1A, may be fitted afterwards and are easily adjusted to accommodate minor variations in line and level. Nuts and bolts are supplied to secure fascia brackets to the rafter arm. Although fixings are controlled by rafter centres it is important to meet gutter support recommendations previously described.

## Rise and fall brackets

Rise and fall brackets, RKF1, can be used with clip-jointed gutters although a notched system is recommended as described for rafter arm fixing above. Nuts and bolts are supplied to secure fascia brackets to the multi-fit face plate. It is recommended that pilot holes are drilled in mortar joints before the spike is driven in to avoid cracking the brickwork bond. Bracket centres should not exceed 600mm.

## Angle fascia bracket

Angle fascia bracket adaptors, RKA1, RKA2, are required when a sloping fascia board is employed at the eaves. The galvanised mild steel adaptor is fitted behind the fascia bracket with two 1 1/4" x 10g (45x5mm) non-ferrous round head screws passing through both bracket and adaptor.

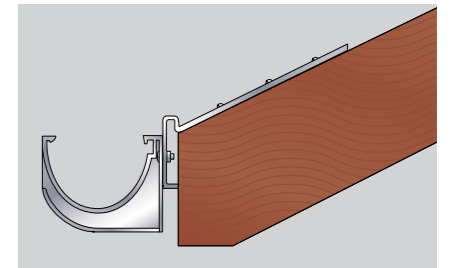

RTA1A adjustable top rafter arm, RTA1 also available

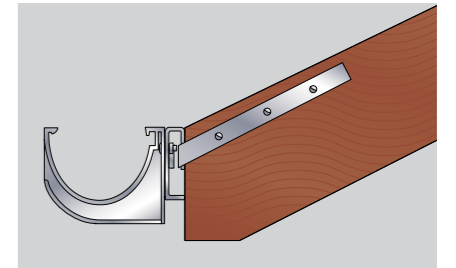

RSA1A adjustable side rafter arm, RSA1 also available

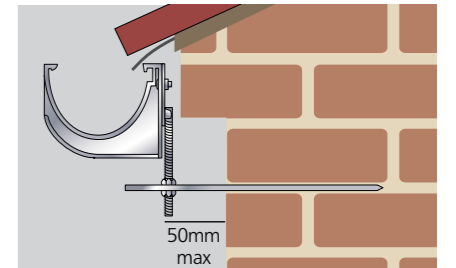

RKF1 rise and fall bracket

## Rainwater system installation



## Fixing to cellular fascia board

Use two round head parallel thread screws which are long enough to penetrate the rear face of the board.

If the cellular board is less than 16mm thick, fit timber support batten as shown.

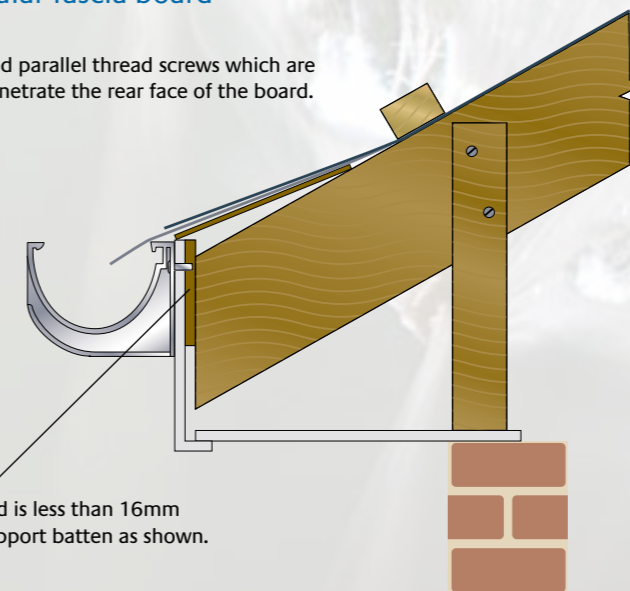

## Clip-jointed gutter systems

Each joint is made by inserting the plain edge of gutter into the fitting and locating under the rear clip. At the same time ease the front edge of fitting forward and up until the gutter clips under the front edge. Care must be taken to ensure that each length of gutter is fitted to the insertion mark on each fitting. This is particularly important and attention to this will ensure trouble free performance for many years.

Unions and outlets incorporate fixing holes in the rear edge which must be used to secure the fitting to the fascia board. This is essential for the control of thermal movement that occurs with temperature variations. The length of gutter to a stopend from a fitting must not exceed 300mm. Where this is exceeded a union must be fitted and secured as previously described with a short piece of gutter to the stopend. With Deepflow, Deepflow150, Clip-master and Flowline the length of gutter to a stopend can be retained using the notch technique and adaptor RGNA1 to eliminate this particular restriction (see opposite).



## Notched gutter systems

It is possible to adapt the easyclip to make fittings suitable for 'notch' jointing, by fitting a 'notch adaptor' into the centre of the easyclip. The adaptor will then fit into a notch cut into the back of the gutter.

This is an effective way of allowing gutter to expand and contract due to temperature change without gutter and fitting pulling apart. There is also no need to anchor fittings to the fascia. This method is ideal to anchor the last joint of a gutter run which ends with a stopend.

To watch a video demonstration of notch jointing, go to [www.marleypd.co.uk](http://www.marleypd.co.uk)



Deepflow, Deepflow150, Clip-master and Flowline can be installed as notched systems.

Deepflow, Deepflow150, Clip-master and Flowline systems are jointed via the innovative easyclip which makes it simple to joint the gutter and fitting, but it is also very easy to take apart if necessary.

The Classic system is jointed by means of pre-fitted clips on all fittings.

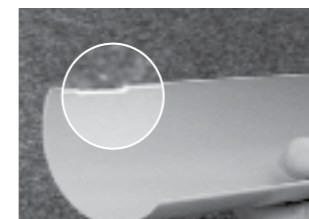
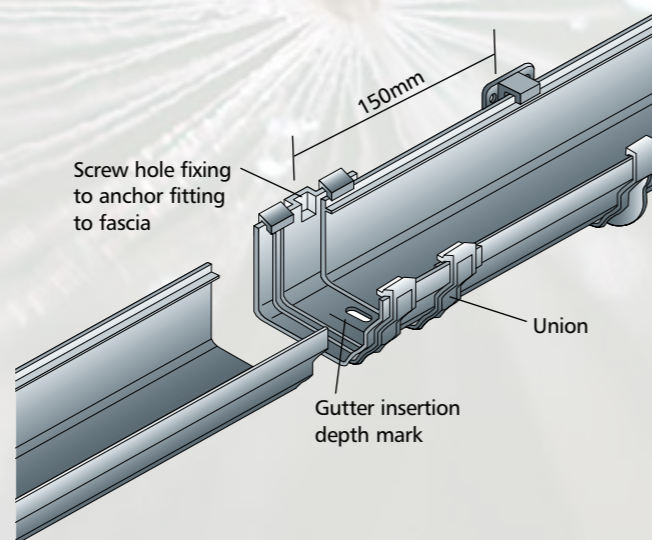
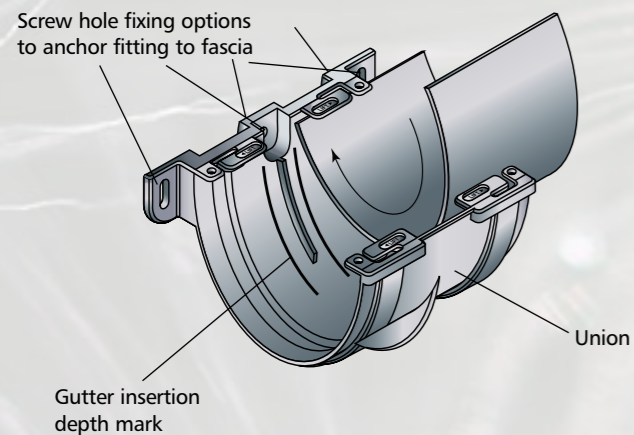

Using a notching tool, RGN1, notch the rear of the gutter. Notches must be made to both ends of a length of gutter.

A notch adaptor RGNA1 is then inserted into the easyclip from the underside, between the gap in the body of the fitting and the clip arm. Insert one end of the short side of the adaptor into the open end of the easyclip. Twist the other side of the adaptor into place. The adaptor is necessarily a tight fit to ensure it stays in place.



The notched gutter end is located under the notch adaptor and the joint completed by clipping the gutter under the easyclip on the front of the fitting.

When correctly assembled, a notched joint cannot pull apart and will absorb expansion and contraction associated with variations in temperature, while maintaining a watertight seal.



## General

As rainwater pipes are generally fitted externally, joints between each spigot and socket length do not need to be sealed. However offset fittings are sized to allow for push fit or solvent weld where suitable.

Gutter outlets are normally positioned directly above drain connections but on occasions it may be necessary to rotate the offset to avoid obstructions below. However when using the square downpipe system, the gutter outlet should be positioned directly above the rainwater drain connection, as square offsets cannot be rotated.

Where a RH25 hopper head is used, the RLE3 outlet adaptor with a pipe socket are required to provide the necessary transition from circular to square.

### Offset assembly

Offsets can be easily constructed on site from a range of bends depending on the roof overhang at the eaves.

Where offsets exceed 600mm it is recommended that bends are solvent welded to gutter outlet spigots to ensure a positive connection. When two 87½° bends are used to construct an offset the horizontal section of pipe should be supported with a pipe clip from the soffit.

Small offsets can be achieved using offset bends RNE252 and RNE253 where a minimum projection of 25mm is obtainable.

### Location of pipe clips

Every rainwater pipe should have a clip located round the top socket to support the downpipe system. Intermediate clips should then be located at a maximum of 2m centres or in the middle of each length to maintain alignment. A gap of 10mm should be left between the end of each pipe and the bottom of the socket to allow for thermal movement.

Two different pipe clip fixing methods are available. A one piece clip for flush fixing or a two piece clip to fit both the downpipe and pipe socket. These are used with backplate RCB300 and allow for adjustment.

Each should be secured with two 32 x 6.5mm non-ferrous round head screws. An extension backplate RT200 can also be used for greater adjustment of the downpipe from the wall.

### Drain connections

External rainwater pipes usually connect direct to the surface water drain. Where a direct connection is made a reducer and a short section of pipe is used to provide the transition between different pipe sizes. A gully trap will be required to both arrangements where the drain connects to a combined foul and surface water drainage system.

### Roof and balcony outlets

Marley provide a range of roof outlets, sized to suit various applications shown on page 35. Aluminium outlets, sized 50-150mm are shown in the Alutec Roof and Shower Drainage Guide.

## Circular downpipe systems

Marley **Deepflow**, **Classic**, **Flowline** and **Clip-master** gutters all have outlets designed to suit 68mm circular downpipe, which has sufficient capacity to accommodate the maximum flow from the above gutter systems.



## Square downpipe systems

Marley **Flowline** and **Classic** gutter systems are available with outlets suitable for 65mm square and 68mm circular rainwater pipes. For aesthetic reasons, the 65mm square system is normally preferred but both have sufficient capacity to accommodate the maximum flow from either system.



Location of pipe clips

Offset assembly

Socket clip

Pipe clip

# Standards & General Information

## British & European Standards

### BS EN 12056-3: 2000

Gravity drainage inside buildings: Roof drainage, layout and calculation.

### BS EN 607

Eaves gutters & fittings - PVCu. Definitions, requirements and testing.

### BS EN 12200-1

Plastics rainwater piping systems for above ground external use - PVCu.

### BS EN 1462

Gutter brackets. Classification, requirements & testing.

### BS EN 681-1

Elastomeric seals. Material requirements for pipe joint seals used in water and drainage applications. Part 1 vulcanised rubber.

### BS 4255-1

Specification for non-cellular gaskets for buildings.

### BS EN ISO 9001 2008

Quality management system. Model for Quality Assurance in Design, Development, Production, Installation and Servicing.

### BS EN ISO 14001 2004

Environmental management systems. Requirements with guidance for use.

## General Information

### Inspection and testing

All newly installed gutters and pipework should be tested in accordance with the appropriate standards. These requirements may vary according to locality of installation and, for guidance, attention is drawn to BS EN 12056-3: 2000, Gravity drainage inside buildings.

### Handling

PVCu gutters and pipes are strong, though lightweight, and are therefore easily handled. However reasonable care should be exercised whilst handling in extremely cold conditions.

To protect the high gloss level of Life4 gutter and downpipes, they are packed into plastic sleeving to prevent accidental damage. When removing from sleeving, ensure that the external face is uppermost and handle with care to ensure that the profiles do not rub against each other.

To preserve the appearance of the self-coloured material, when products are delivered to site, they should preferably be placed inside a storage building.

### Storage

Gutters and pipes should be well supported on suitable racks. Dividing the framework or shelves into sections helps to segregate different products and prevents overloading and possible distortion of bottom layers.

Pipes and gutter bundles should be stacked no more than seven high. If it is necessary to store in the open for long periods, or if products are to be exposed to strong sunlight, they should be covered with an opaque sheet. Fittings supplied in cardboard boxes or polythene bags should be stored under cover and kept packed until required.

Solvent cement must be securely stored in a cool place out of direct sunlight and away from any heat source.

### Safety

The relevant regulations are outlined in the Health and Safety at Work Act 1974 and should be followed. Hazard sheets, dealing with the potential hazards of working with solvent cement and silicone lubricant are available from Marley Plumbing & Drainage.

Refer to C.D.M. regulations (Code of Practice and Designing for Health and Safety in Construction 1995).

### Maintenance

Marley PVCu Rainwater systems are corrosion resistant and self coloured, the material therefore does not require painting. If, however, at any time painting is required, a paint specific for use with PVC is recommended.

Timber fascias that have been treated with timber preservatives.

# Marley system solutions



### Marley PVCu Soil

Standard PVCu soil systems to BS EN 1329. Ideal for domestic and commercial applications, including branch connections to other materials. Available in 82mm, 110mm and 160mm, ring seal and solvent weld jointing variants.



### Marley HDPE

Marley Akatherm HDPE is a drainage system which offers an alternative solution to cast iron. It is particularly suited for commercial applications or where a product with high impact or abrasion resistance is required, such as hospitals, hotels, schools, as well as residential buildings. HDPE will also cope with temperature variations of -40°C to 100°C making it ideal for external as well as internal installations.



### Marley acoustic

An acoustic soil and waste range with a layered pipe providing quick, hygienic removal of sanitary waste water. The noise generated by the flow of water is dramatically reduced – making it perfect for multi-occupancy apartment blocks and high specification developments.



### Marley waste systems

A wide range of PVC-C, ABS and polypropylene waste ranges from 32mm to 50mm and in a variety of colours. Available with solvent weld compression and push fit jointing.



### Marley underground systems

The Marley Plumbing & Drainage range of underground systems include the solid wall range, predominately for round the house drainage and Quantum structured wall range for sewer and highway drainage applications.



### Alutec

Alutec offer modern and traditional aluminium rainwater profiles, providing solutions for any type of building. Aluminium has high visual appeal and durability, lasting for 50 years or more. The product portfolio includes Evolve; easy to install, low cost gutter systems in four profiles. The rainwater ranges are complemented by aluminium soffit and fascia systems and roof & floor outlets.

## Accreditations



# Product specifications

## Deepflow 110 x 75mm semi-elliptical system

### GUTTER

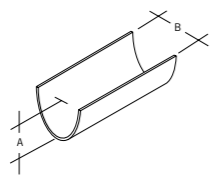

Size	Code	CSA mm <sup>2</sup>	A	B	Colour	Qty
3m	<b>RGD3</b>	6043	75	110	W B G BR	5
4m	<b>RGD4</b>	6043	75	110	W B G BR	5

### UNION BRACKET

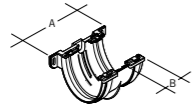

Code	A	B	Colour	Qty
<b>RUD10</b>	155	40	W B G BR	20

Adaptors to join different gutter profiles are available to order

### FASCIA BRACKET

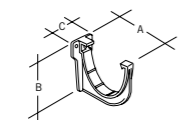

Code	A	B	C	Colour	Qty
<b>RKD1</b>	131	100	50	W B G BR	80

When used with 2 hole screw fixings, brackets meet the heavy class of BS EN 1462

### ANGLES



Angle	Code	A	B	Colour	Qty
90°	<b>RAD10</b>	176	40	W B G BR	20

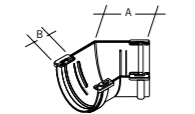

Angle	Code	A	B	Colour	Qty
45°	<b>RAD20</b>	108	80	W B G BR	15

Special gutter angles are available to order. Please state angle required.

Code	Colour	Qty
<b>RFB21</b>	W B G BR	1

### RUNNING OUTLET

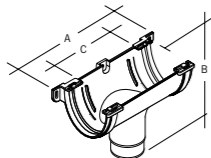

Code	A	B	C	Colour	Qty
<b>ROD10</b>	275	164	153	W B G BR	12

68mm circular spigot

### STOPEND OUTLET

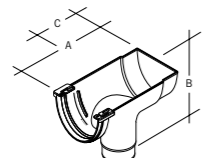

Code	A	B	C	Colour	Qty
<b>ROD20</b>	227	164	107	W B G BR	15

68mm circular spigot

### EXTERNAL STOPEND

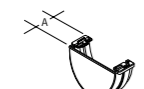

Code	A	Colour	Qty
<b>RED10</b>	44	W B G BR	40

### NOTCH ADAPTOR

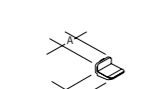

Code	A	B	Colour	Qty
<b>RGNA1</b>	16	18	B	20

To adapt fitting for notch jointing

## Clip-master 112 x 49mm nominal half round system

### GUTTER

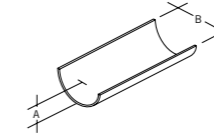

Size	Code	CSA mm <sup>2</sup>	A	B	Colour	Qty
3m	<b>RGC3</b>	3997	49	112	B G BR	5
4m	<b>RGC4</b>	3997	49	112	W B G BR	5

### UNION BRACKET

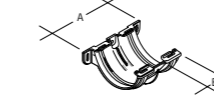

Code	A	B	Colour	Qty
<b>RUC1</b>	155	40	W B G BR	15

### FASCIA BRACKET

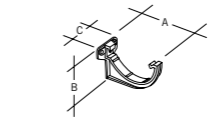

Code	A	B	C	Colour	Qty
<b>RKC1</b>	132	72	48	W B G BR	50

When used with 2 hole screw fixings, brackets meet the heavy class of BS EN 1462

### ANGLES

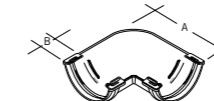

Angle	Code	A	B	Colour	Qty
90°	<b>RAC1</b>	170	40	W B G BR	15

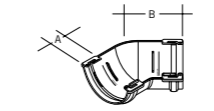

Angle	Code	A	B	Colour	Qty
45°	<b>RAC2</b>	110	80	W B G BR	10

Special gutter angles are available to order. Please state angle required.

Code	Colour	Qty
<b>RFB104</b>	W B G BR	1

### RUNNING OUTLET

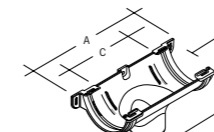

Code	A	B	C	Colour	Qty
<b>ROC1</b>	275	138	155	W B G BR	15

68mm circular spigot

### STOPEND OUTLET

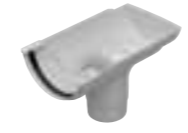

Code	A	B	C	Colour	Qty
<b>ROC2</b>	228	138	105	W B G BR	15

68mm circular spigot

### EXTERNAL STOPEND

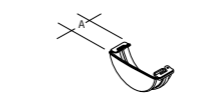

Code	A	Colour	Qty
<b>REC1</b>	40	W B G BR	20

### SPARE CLIP

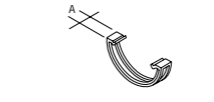

Code	A	Colour	Qty
<b>RCC1</b>	24	W B G BR	30

For use with old strapped system only

### CLIP-MASTER TO FLOWLINE ADAPTOR

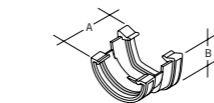

Code	A	B	Colour	Qty
<b>RGAR2R</b>	87	72	W B G BR	1

Other gutter adaptors are available to order

### NOTCH ADAPTOR



Code	A	B	Colour	Qty
<b>RGNA1</b>	16	18	B	20

To adapt fitting for notch jointing

# Product specifications

## Circular downpipe 68mm system

### PIPES

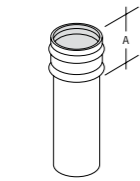

Size	Code	A	Colour	Qty
2.5m	<b>RPH2525</b>	52	B G BR	4
3m	<b>RPH253</b>	52	W B G BR	4
5.5m	<b>RPH2555</b>	52	W B G BR	4

### SOCKETS

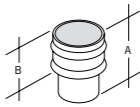

**Loose pipe socket**

Code	A	B	Colour	Qty
<b>RL25</b>	100	50	W B G BR	10

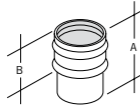

**Solvent weld pipe socket with push-fit seal**

Code	A	B	Colour	Qty
<b>RLR25</b>	92	50	W B	10

### CLIPS

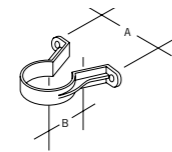

**One piece 8mm screw fixing holes**

Code	A	B	Colour	Qty
<b>RCZ253</b>	94	72	W B G BR	30

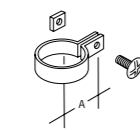

**Socket clip including nut and bolt for use with RCB300 backplate**

Code	A	Colour	Qty
<b>RC251</b>	64	W B G BR	20

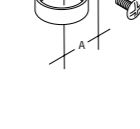

**Pipe clip including nut and bolt for use with RCB300 backplate**

Code	A	Colour	Qty
<b>RC252</b>	64	W B G BR	20

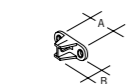

**Backplate for use with RC251/RC252 clips**

Code	A	B	Colour	Qty
<b>RCB300</b>	48	30	W B G BR	20

**Nuts and bolts 20mm x 6mm**

Code	Qty
<b>RNB11</b>	20

### BENDS

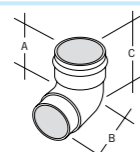

Angle	Code	A	B	C	Colour	Qty
87½°	<b>RB251</b>	48	75	81	W B G BR	25

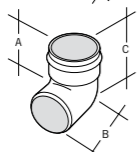

Angle	Code	A	B	C	Colour	Qty
67½°	<b>RB252</b>	38	60	66	W B G BR	25

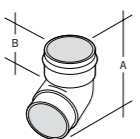

Angle	Code	A	B	C	Colour	Qty
45°	<b>RB253</b>	48	53	63	W B G BR	25

Socket/spigot

## Circular downpipe 68mm system

### OFFSET BENDS

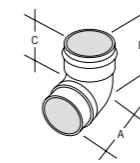

Angle	Code	A	B	C	Colour	Qty
67½°	<b>RNE255</b>	66	66	37	W B G BR	25

Socket/push-fit spigot

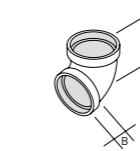

Angle	Code	A	B	Colour	Qty
67½°	<b>RNA250</b>	41	15	W B G BR	10

Socket/socket. For deep fascias

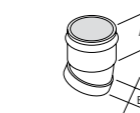

Angle	Code	A	B	Colour	Qty
20°	<b>RNE252</b>	51	15	W B G BR	10

Socket/socket. For 25mm offset construction

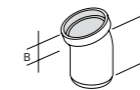

Angle	Code	A	B	Colour	Qty
20°	<b>RNE253</b>	56	15	W B G BR	10

Socket/spigot. For 25mm offset construction

### BRANCH



Angle	Code	A	B	Colour	Qty
67½°	<b>RY252</b>	196	90	W B G BR	10

Socket/spigot

### ACCESS PIPE

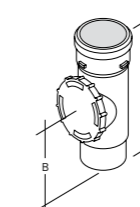

Code	A	B	Colour	Qty
<b>RF25</b>	185	96	W B G BR	15

Socket/spigot

### SHOE

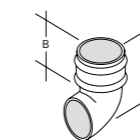

Code	A	B	Colour	Qty
<b>RS25</b>	137	48	W B G BR	15

### LEAF GUARD

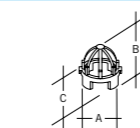

Code	A	B	C	Colour	Qty
<b>RV225</b>	64	55	18	W B G BR	30

### HOPPER HEAD

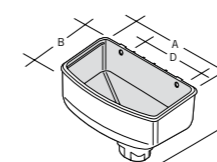

Code	A	B	C	D	Colour	Qty
<b>RH252</b>	308	174	220	200	W B G BR	6
<b>RH25</b>	425	298	238	190	B	1

Suitable for use with 68mm circular and 65mm square downpipe, using appropriate socket

For further hopper heads please see page 34.

# Product specifications

## Flowline 112 x 60mm rectilinear system

### GUTTER

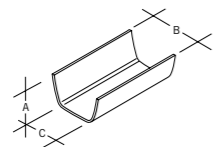
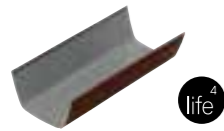

Size	Code	CSA mm <sup>2</sup>	A	B	C	Colour	Qty
4m	<b>RGF4</b>	5412	60	112	80	W B BR	5

### UNION BRACKET

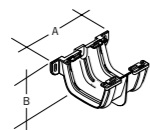

Code	A	B	Colour	Qty
<b>RUF1</b>	155	84	W B BR	12

### FASCIA BRACKET

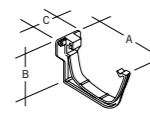

Size mm	Code	A	B	C	Colour	Qty
	<b>RKF2</b>	132	85	48	W B BR	40

When used with 2 hole screw fixings, brackets meet the heavy class of BS EN 1462

### ANGLE

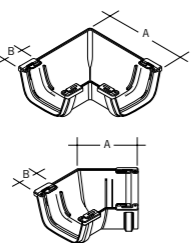
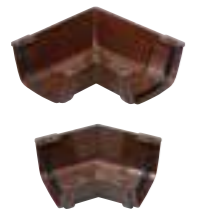

Angle	Code	A	B	Colour	Qty
90°	<b>RAF1</b>	188	40	W B BR	20

Angle	Code	A	B	Colour	Qty
45°	<b>RAF2</b>	110	40	W B BR	15

Special gutter angles are available to order. Please state angle required.

Code	Colour	Qty
<b>RFB102</b>	W B BR	1

### RUNNING OUTLET

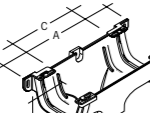

Code	A	B	C	Colour	Qty
<b>ROF1</b>	275	134	155	W B BR	12

Suitable for both 68mm circular or 65mm square downpipe

### STOPEND OUTLET

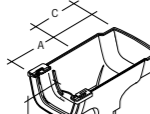

Code	A	B	C	Colour	Qty
<b>ROF11</b>	225	134	110	W B BR	15

Suitable for both 68mm circular or 65mm square downpipe

### EXTERNAL STOPEND

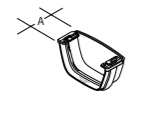

Code	A	Colour	Qty
<b>REF2</b>	53	W B BR	20

### SPARE CLIP

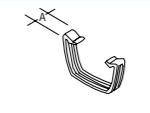

Code	A	Colour	Qty
<b>RCF1</b>	24	W B GR	30

For use with old strapped system only

### CLIP-MASTER TO FLOWLINE ADAPTOR

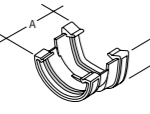

Code	A	B	Colour	Qty
<b>RGA2R</b>	87	72	W B BR	1

Other gutter adaptors are available to order

### NOTCH ADAPTOR

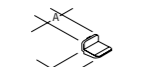

Code	A	B	Colour	Qty
<b>RGNA1</b>	16	18	B	20

To adapt fitting for notch jointing

## Classic 116 x 75mm ogee style system

### GUTTER

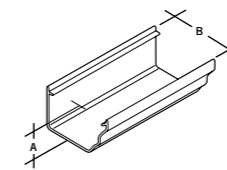

Size	Code	CSA mm <sup>2</sup>	A	B	Colour	Qty
4m	<b>RCG54</b>	7377	75	116	W B BR	4
6m	<b>RCG56</b>	7377	75	116	W BR	4

### UNION BRACKET

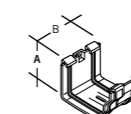

Code	A	B	Colour	Qty
<b>RCU51</b>	88	100	W B BR	15

Adaptors to join different gutter profiles are available to order

### EXTERNAL FASCIA BRACKET

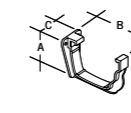

Code	A	B	C	Colour	Qty
<b>RCK51</b>	98	136	54	W B BR	40

When used with 2 hole screw fixings, brackets meet the heavy class of BS EN 1462

### INTERNAL FASCIA BRACKET

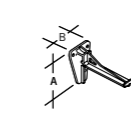

Code	A	B	Colour	Qty
<b>RCK52</b>	84	54	W B BR	40

### EXTERNAL ANGLES

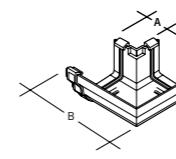

Angle	Code	A	B	Colour	Qty
90°	<b>RCA51</b>	52	189	W B BR	10

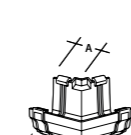

Angle	Code	A	B	Colour	Qty
45°	<b>RCA511</b>	52	109	W B BR	15

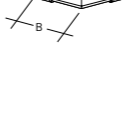

Angle	Code	A	B	Colour	Qty
30°	<b>RCA510</b>	59	95	W BR	10

### INTERNAL ANGLES

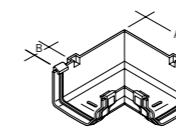
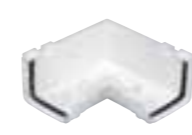

Angle	Code	A	B	Colour	Qty
90°	<b>RCA52</b>	189	50	W B BR	10

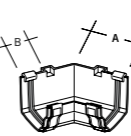

Angle	Code	A	B	Colour	Qty
45°	<b>RCA522</b>	109	50	W B BR	15

Special gutter angles are available to order. Please state angle required.

#### External

Code	Colour	Qty
<b>RFB401</b>	W B BR	1

#### Internal

Code	Colour	Qty
<b>RFB501</b>	W B BR	1

# Product specifications

## Classic 116 x 75mm ogee style system

### RUNNING OUTLET

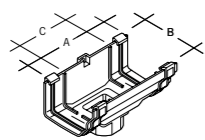

Code	A	B	C	Colour	Qty
<b>RCO50</b>	222	135	125	W B BR	15

Suitable for both 68mm circular or 65mm square downpipe

### STOPEND OUTLET

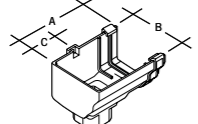

#### Left hand

Code	A	B	C	Colour	Qty
<b>RCO51</b>	177	135	66	W B BR	15

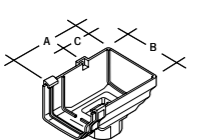

#### Right hand

Code	A	B	C	Colour	Qty
<b>RCO52</b>	177	135	66	W B BR	15

Suitable for both 68mm circular or 65mm square downpipe

### EXTERNAL STOPEND

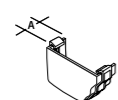

#### Left hand

Code	A	Colour	Qty
<b>RCE51</b>	41	W B BR	15

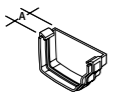

#### Right hand

Code	A	Colour	Qty
<b>RCE52</b>	41	W B BR	15

### SPARE CLIP

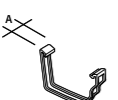

Code	A	Colour	Qty
<b>RCC51</b>	24	W B BR	30

### SPARE GUTTER SEAL



Code	Colour	Qty
<b>RNG80</b>	B	1

## Square downpipe 65mm system

### PIPES



Size	Code	Colour	Qty
3m	<b>RPE3</b>	W B BR	6
5.5m	<b>RPE2555</b>	W B BR	2

### SOCKETS

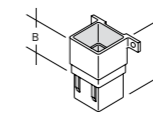

#### With fixing lugs

Code	A	B	Colour	Qty
<b>RLE1</b>	82	42	W B BR	10

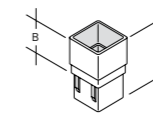

#### Plain

Code	A	B	Colour	Qty
<b>RLE1</b>	82	42	W B BR	10

### CLIPS

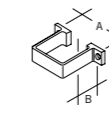

#### One piece 8mm screw fixing holes

Code	A	B	Colour	Qty
<b>RCE1</b>	88	40	W B BR	30

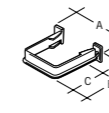

#### One piece stand off

Code	A	B	C	Colour	Qty
<b>RCE3</b>	107	96	65	W B BR	5

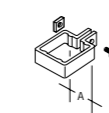

#### Pipe clip including nut and bolt for use with RCB300 backplate

Code	A	Colour	Qty
<b>RCE2</b>	56	W B BR	10

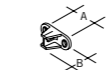

#### Backplate for use with RCE2 clip

Code	A	B	Colour	Qty
<b>RCB300</b>	48	30	W B G BR	20

#### Nuts and bolts 20mm x 6mm

Code	Qty
<b>RNB11</b>	20

### OFFSET BENDS

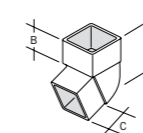

Angle	Code	A	B	C	Colour	Qty
67½°	<b>RBE1</b>	75	42	40	W B BR	15

Socket/spigot

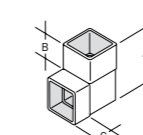

Angle	Code	A	B	C	Colour	Qty
87½°	<b>RBE3</b>	104	40	28	W B BR	15

Socket/socket

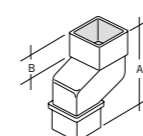

Code	A	B	Colour	Qty
<b>RNE1</b>	142	42	W B BR	10

Socket/spigot  
50mm projection

# Product specifications

## Square downpipe 65mm system

### BRANCH

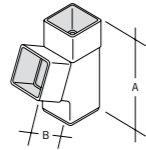

Angle	Code	A	B	Colour	Qty
67½°	<b>RYE1</b>	158	75	W B BR	15

Socket/spigot

### ACCESS PIPE

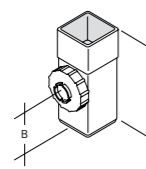

Code	A	B	Colour	Qty
<b>RFB91</b>	222	95	W B BR	30

Socket/spigot

### SHOES

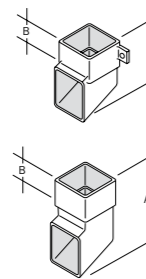

#### With fixing lugs

Code	A	B	Colour	Qty
<b>RSE1</b>	115	40	W B BR	15

#### Plain

Code	A	B	Colour	Qty
<b>RSE2</b>	140	40	W B BR	15

### OUTLET ADAPTOR

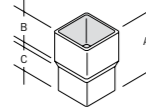

Code	A	B	C	Colour	Qty
<b>RLE3</b>	96	51	41	W B BR	30

68mm circular spigot to 65mm square socket

### DRAIN ADAPTORS

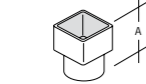

Code	A	Colour	Qty
<b>RLE2</b>	77	W B BR	1

Adapts 65mm square socket to 68mm socketed pipe

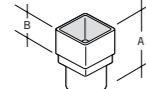

Code	A	B	Colour	Qty
<b>RLE4</b>	98	40	W B BR	1

Adapts 65mm square socket to 68mm plain ended pipe

## Deepflow150 155 x 98mm high capacity system

### GUTTER

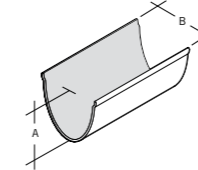
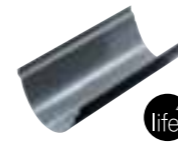

Size	Code	CSA mm <sup>2</sup>	A	B	Colour	Qty
4m	<b>RGJ4</b>	10,060	98	155	W B BR	4

### UNION BRACKET

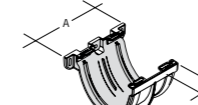

Code	A	B	Colour	Qty
<b>RUJ1</b>	166	40	W B BR	8

Adaptors to join different gutter profiles are available to order

### FASCIA BRACKET

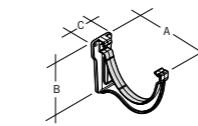

Code	A	B	C	Colour	Qty
<b>RKJ1</b>	174	125	49	W B BR	20

When used with 2 hole screw fixings, brackets meet the heavy class of BS EN 1462

### ANGLES

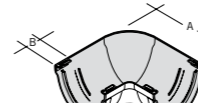

Angle	Code	A	B	Colour	Qty
90°	<b>RAJ1</b>	241	40	W B BR	4

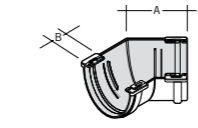

Angle	Code	A	B	Colour	Qty
45°	<b>RAJ2</b>	140	40	W B BR	1

Special gutter angles are available to order. Please state angle required

Code	Colour	Qty
<b>RFB150</b>	W B BR	1

### RUNNING OUTLET

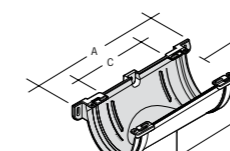

Code	A	B	C	Colour	Qty
<b>ROJ1</b>	281	192	160	W B BR	20

82mm circular outlet

### STOPENDS

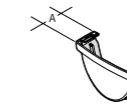

#### External

Code	A	Colour	Qty
<b>REJ1</b>	55	W B BR	4



#### Internal

Code	A	Colour	Qty
<b>REJ2</b>	44	W B BR	4

### NOTCH ADAPTOR



Code	A	B	Colour	Qty
<b>RGNA1</b>	16	18	B	20

To adapt fitting for notch jointing

# Product specifications

## Circular downpipe 82mm system

### DOWNPIPE

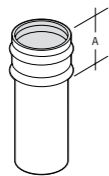

Size	Code	A	Colour	Qty
3m	<b>RPH33</b>	61	W B BR	4
5.5m	<b>RPH355</b>	61	W B BR	4

5.5m length available to order

### SOCKET

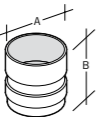

Size mm	Code	A	B	Colour	Qty
	<b>RL3</b>	87	103	W B BR	4

### CLIPS

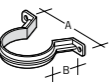

#### One piece

Code	A	B	Colour	Qty
<b>RC3</b>	125	93	W B BR	10

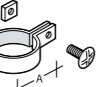

#### Pipe clip including nut and bolt

Code	A	Colour	Qty
<b>RC32</b>	70	W B BR	20

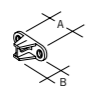

#### Backplate for use with RC32 clip

Code	A	B	Colour	Qty
<b>RCB300</b>	48	30	W B BR	20

#### Nuts and bolts 20mm x 6mm

Code	Qty
<b>RNB11</b>	20

### OFFSET BEND

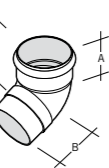

Angle	Code	A	B	C	Colour	Qty
67°	<b>RLE3</b>	43	78	76	W B BR	4

### BENDS



Angle	Code	A	B	C	Colour	Qty
87½°	<b>RB31*</b>	49	115	138	W B BR	4



Angle	Code	A	B	C	Colour	Qty
45°	<b>RB33*</b>	49	78	70	W B BR	4

## Circular downpipe 82mm system

### BRANCH

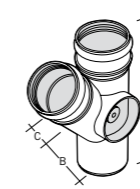

Angle	Code	A	B	C	Colour	Qty
45°	<b>RY3*</b>	229	130	55	W B BR	24

### ACCESS PIPE

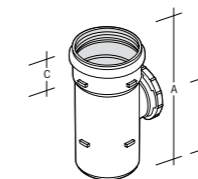

Code	A	B	C	Colour	Qty
<b>RF3*</b>	205	101	52	W B BR	54

### SHOE

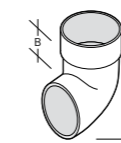

Code	A	B	Colour	Qty
<b>RS3</b>	118	22	W B BR	4



# Product specifications

## Ancillary items

### RAIN DIVERTER



Code	A	B	Colour	Qty
<b>RD25R</b>	105	500	W B G BR	20

Suitable for use with 68mm circular or 65mm square PVCu downpipes

### WATER BUTT CONNECTOR



Code	A	Colour	Qty
<b>RDC26R</b>	500	B	10

### FASCIA BRACKET SPACER/HEIGHT ADJUSTER



Code	A	B	C	D	Colour	Qty
<b>RGS1</b>	94	48	17	17	W B	45

Includes nut and bolt.  
Suitable for use with Deepflow, Clip-master, Flowline and Classic fascia brackets.  
25mm height adjustment

### ANGLED FASCIA BRACKET ADAPTOR



Angle	Code	Qty
22½°	<b>RKA1</b>	50
30°	<b>RKA2</b>	100

Galvanised mild steel

### EXTENSION BACKPLATE



Code	A	B	Colour	Qty
<b>RT200</b>	104	45	W B G BR	50

PVCu  
For use with RC251/2, RCE2 and RC32 pipe clips

### EXTENSION BRACKET



Code	A	B	Colour	Qty
<b>RT250</b>	243	114	B G	20

### FIXED RAFTER ARMS

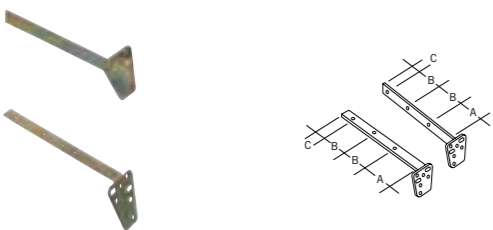

Side	Angle	Code	A	B	C	Qty
	22½°	<b>RSA1</b>	50	75	25	50

Top	Angle	Code	A	B	C	Qty
	22½°	<b>RTA1</b>	100	75	25	50

Electroplated mild steel  
Includes 2 cadmium plated nuts and bolts

### ADJUSTABLE RAFTER ARMS

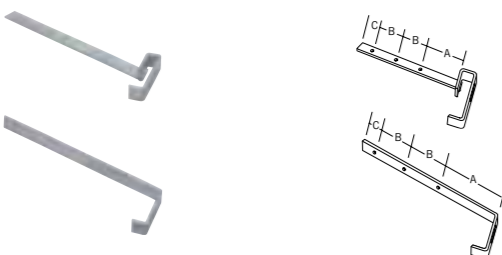

Side	Code	A	B	C	Qty
	<b>RSA1A</b>	123	75	25	1

Top	Code	A	B	C	Qty
	<b>RTA1A</b>	65	75	25	1

Galvanised steel  
Including nut, bolt and antislip washer.

## Ancillary items

### SPARE NUTS AND BOLTS

Size mm	Code	Qty
12x5	<b>RNB21</b>	10

### RISE AND FALL EXTENSION ARM

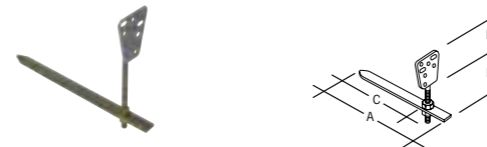

Code	A	B	C	Qty
<b>RKF1</b>	290	100	235	50

Electroplated mild steel  
Including 2 cadmium plated nuts and bolts

### DRIVE-IN SPIKE

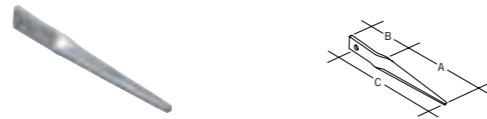

Size mm	Code	A	B	C	Qty
	<b>RSS1°</b>	115	58	154	50

Galvanised mild steel

### CLIP-MASTER TO OGEE GUTTER ADAPTORS



Right hand				
Code	A	B	Qty	
<b>RGA4</b>	94	66	50	

Left hand				
Code	A	B	Qty	
<b>RGA5</b>	94	66	50	

Cast aluminium

### HALF ROUND TO CAST IRON GUTTER ADAPTOR



Code	A	Colour	Qty
<b>RGA1R</b>	29	B	25

Suitable for adapting 100mm to 112mm half round

Other gutter adaptors are available to order

### UNIVERSAL GUTTER NOTCHING TOOL



Code	Qty
<b>RGN1</b>	1

Suitable for use with Deepflow, Clip-master, Flowline, and Deepflow150 gutter systems

### DRAIN ADAPTORS



Code	A	B	Colour	Qty
<b>RA42</b>	31	104	B	100

Can be cut to fit all shapes and sizes of downpipe

Code	A	B	Colour	Qty
<b>RRM425</b>	40	25	W B G BR	10

110mm socket to 68mm socket

### GUTTER SEAL



Code	Qty
<b>RNG50</b>	1

Suitable for use with Deepflow, Clip-master, Flowline, and Deepflow150 gutter systems.  
Cut to required length

# Product specifications

## Ancillary items

### FLAT RAINWATER SEALS



Code	Colour	Qty
<b>RNG60</b>	B	5

Suitable for use with RGA1R and old (pre-1985) rainwater systems which used flat seals. Cut to required length

### SPARE RING SEALS



#### 'T' ring

Code	Colour	Qty
<b>SR82T</b>	B	5

To BS EN 681/1  
82mm seal for use with RB31, RB33, RY3 and RF3 fittings

## Hopper heads

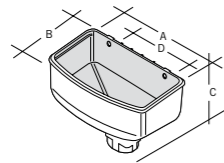

Size mm	Code	A	B	C	D	Colour	Qty
68/65	<b>RH252</b>	308	174	220	200	W B G BR	6

Dual spigot outlet

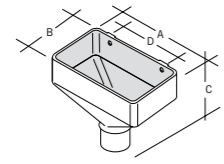

Size mm	Code	A	B	C	D	Colour	Qty
82	<b>SH30</b>	280	155	230	177	W B G BR	6

Circular spigot outlet

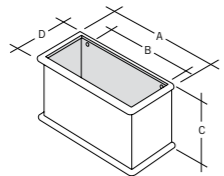

Size mm	Code	A	B	C	D	Colour	Qty
68	<b>RH25</b>	425	298	238	190	B	1
110	<b>SH40</b>	425	298	238	150	B G	1

Circular spigot outlet

## PVCu Flat roof outlets

### FLAT ROOF OUTLET

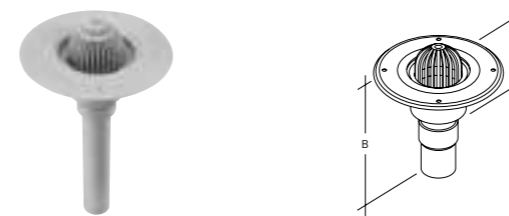

Size mm	Code	A	B	Colour	Qty
68	<b>ROF25</b>	343	506	G	3

Items are supplied bagged loose for site assembly

### BALCONY OUTLET

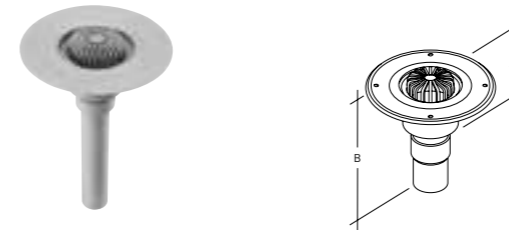

Size mm	Code	A	B	Colour	Qty
68	<b>ROB25</b>	343	506	G	3

Items are supplied bagged loose for site assembly

### UNIVERSAL FLANGE

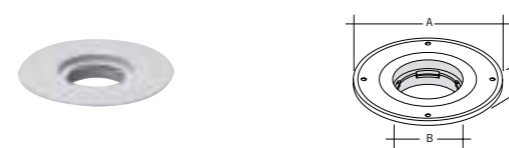

Code	A	B	C	Colour	Qty
<b>SOF1</b>	343	180	55	G	5

Flange is 3mm thick

### FLAT ROOF OUTLET GRATING



Code	Colour	Qty
<b>SOF12</b>	G	25

For use with SOF1

### BALCONY OUTLET GRATING



Code	Colour	Qty
<b>SOB1</b>	G	35

For use with SOF1

### STRAIGHT FLANGE CONNECTOR



Size mm	Code	A	B	Colour	Qty
82	<b>SGS31G</b>	133	137	G	20
110	<b>SGS41W</b>	139	134	W	20

### BENT FLANGE CONNECTOR



Size mm	Code	A	B	Colour	Qty
110	<b>STS41W</b>	104	156	W	45

Socket/socket



[marleypd.co.uk](http://marleypd.co.uk)

For general enquiries and details of your nearest stockist please call the customer services department:

**Tel: 01622 852585**

email: [marketing@marleypd.co.uk](mailto:marketing@marleypd.co.uk)

For Technical advice please call  
**01622 852695**

**Head Office**

Lenham, Maidstone  
Kent ME17 2DE  
Tel: 01622 858888  
Fax: 01622 858725

**Scotland**

Birkenshaw Industrial Estate  
Uddingston, Glasgow G71 5PA  
Tel: 01698 815231  
Fax: 01698 810307

**Export Division**

Lenham, Maidstone  
Kent ME17 2DE England  
Tel: +44 (0)1622 858888  
Fax: +44 (0)1622 850778

an *OAliaxis* company

June 2015