

SALUS[®]

CONTROLS PLC

iT500 Internet Thermostat



USER MANUAL

Product compliance & safety information

These instructions are applicable to the SALUS Controls model stated on the front cover of this manual only, and must not be used with any other make or model.

This accessory must be fitted by a competent person, and installation must comply with the guidance provided in the current IEE Wiring Regulations and current Building Regulations. Failure to comply with the requirements of these publications could lead to prosecution.



Always isolate the AC Mains supply before installing or working on any components that require 230 VAC 50Hz supply.

**When fitting batteries, do not mix old and new batteries together.
Do not use rechargeable batteries.**

Please leave these instructions with the end user where they should be kept in a safe place for future reference.

Contents of the box



iT500TR Thermostat



iT500RX Receiver



iTG500 Gateway



Optional Stand



ADSL Cable



iT500 Power adaptor



Fixing screws & plugs

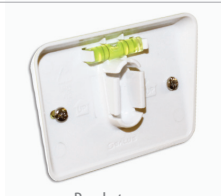

Bracket



Wall mount

Installation

Please refer to the installation guide.
The installation guide also shows how to connect your iT500 thermostat to the internet.



Connection & Control









Google play

www.salus-controls.com

For details please refer to page 18 in the installation manual.

LCD Overview

| LCD ICONS | DESCRIPTION | FUNCTION |
|---|--------------------------|--|
| 1234567 | Day of the week | Displays the number of the day of the week. 1 being Monday |
| 88 ^{°C} _B | Temperature indicator | Displays set or measured temperature |
| 88:88 | Clock display | Displays time |
| 123456 | Program number indicator | Displays the number of the active (selected) program |
|  | Heat mode indicator | Indicates heating output is turned on* |
|  | Heat zone indicator | Indicates heating zone* |
|  | Hot water indicator | Indicates hot water control* |
|  | Hot water mode indicator | Indicates hot water output is turned on* |
|  | RF signal indicator | Indicates the unit is transmitting a wireless signal to the iT500RX or is receiving the signal from the iT300* |
|  | Touch lock indicator | Indicates touch lock is activated |
|  | Battery status | Indicates battery is low |
|  | Holiday indicator | Indicates holiday operation mode is selected |
|  | Internet indicator | Indicates connection to iTG500 and SALUS server |
|  | Cooling indicator | Indicates cooling output is on* |
| ON | ON indicator | Hot water continuously on* |
| 1 | Once indicator | Hot water is on once* |
| AUTO | AUTO indicator | Automatic program mode |
| OFF | OFF indicator | Off mode |
|  | Setting indicator | Manual override or settings mode |

* System configuration specific.

Controls



Identify your system type

The system type is unique to your system configuration.
The system will be set by your installer and should only be changed by your installer.



1 One central heating zone only.



IT500 Display

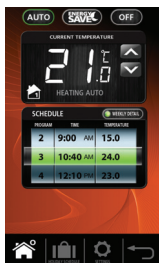

Smartphone Display



PC Display



2 Two central heating zones.



IT500 Display

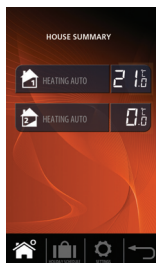

Smartphone Display

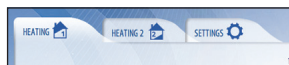

PC Display



3 One central heating zone plus hot water.



IT500 Display



Smartphone Display



PC Display

One Central Heating Zone System PC & Smartphone Control

Now that you have identified your system type, you can use your PC or smartphone to fully control your iT500.



Energy save will use the lowest set temperature on your daily schedule.



Will be displayed when the current program has been manually overridden

AUTO

*Press AUTO to cancel temporary override of program temperature.



1

One central heating zone only.

Follows weekly schedule

Energy save mode

Heating continuously off

HEATING 1 SETTINGS

Thursday | 15/08/2013 | 11:49 10 am

AUTO **ENERGY SAVE** **OFF**

ALL S/2 INDIVIDUAL

MON - FRI SAT - SUN

| Program | Time | Temp |
|---------|----------|---------|
| 1 | 7:10 am | 21.0 °C |
| 2 | 9:00 am | 15.0 °C |
| 3 | 10:40 am | 24.0 °C |
| 4 | 12:10 pm | 23.0 °C |
| 5 | 2:50 pm | 17.5 °C |
| 6 | 9:20 pm | 15.0 °C |

Holiday not set

Holiday Start: 14-08-2013 1:38 pm

Holiday End: 14-08-2013 1:38 pm

AUTO **ENERGY SAVE** **OFF**

CURRENT TEMPERATURE

24.0 °C

HEATING AUTO

SCHEDULE WEEKLY DETAIL

| PROGRAM | TIME | TEMPERATURE |
|---------|----------|-------------|
| 3 | 11:00 AM | 21.0 |
| 4 | 1:00 PM | 14.0 |
| 5 | 4:00 PM | 21.0 |

Home Holiday Settings Back

Override program temperature*

Change/view weekly heating schedule

Current program

One Central Heating Zone System Local Control

Control available on your Smartphone or PC is also available locally on the iT500.

Temporary override of your temperature

Press the power button to start and use the buttons indicated to change the SET temperature. Then press the tick to accept.

  Press to cancel temporary override.

 The unit will return to the home screen with the symbol showing.

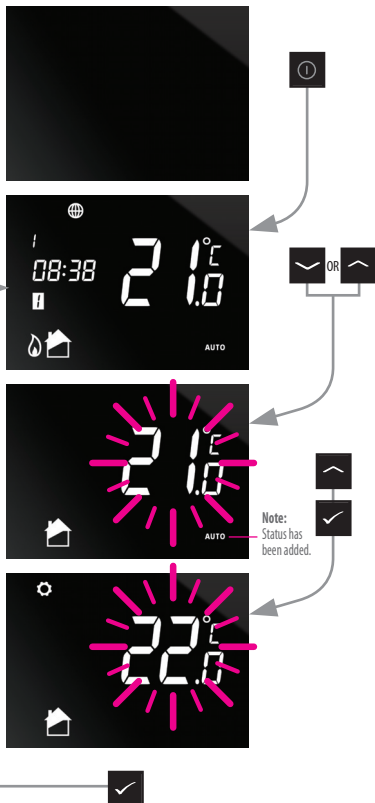

 The operations described in the next few pages can be controlled via your Smartphone or PC.

 All changes made locally on the iT500 will automatically update PC and Smartphone.

One Central Heating Zone System Local Control

Switching your heating from AUTO to OFF.

Press the power button to start and use the buttons indicated to switch from AUTO to OFF.

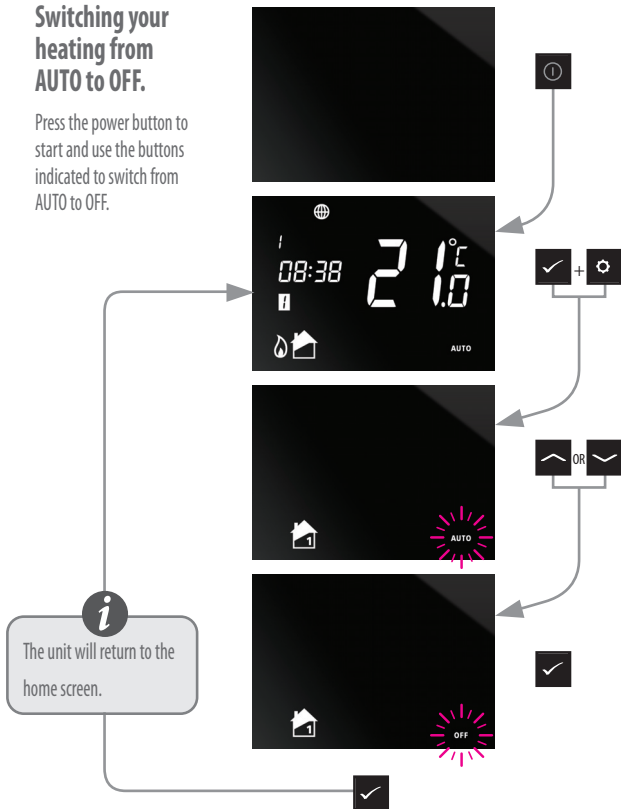

Two Central Heating Zones System PC & Smartphone Control



2 Two central heating zones.

Now that you have identified your system type, you can use your PC or smartphone to fully control your iT500.



For information regarding the control of an individual zone via Smartphone or PC, please refer to page 8.

| MON - FRI | SAT - SUN | |
|-----------|-----------|---------|
| Program | Time | Temp |
| 1 | 7:10 am | 21.0 °C |
| 2 | 9:00 am | 15.0 °C |
| 3 | 10:40 am | 24.0 °C |
| 4 | 12:10 pm | 23.0 °C |
| 5 | 2:50 pm | 17.5 °C |
| 6 | 9:20 pm | 15.0 °C |

Holiday not set
Holiday Start: 14-08-2013 1:38 pm
Holiday End: 14-08-2013 1:38 pm

HOUSE SUMMARY

HEATING AUTO 24.0°C Enter Zone 1

HEATING AUTO 18.0°C Enter Zone 2

Home Holiday Settings Back

Two Central Heating Zones System Local Control

Temporary override of your temperature Zones 1 & 2.

Press the power button to start and use the buttons indicated to change the SET temperature. Then press the tick to accept.

 Press to cancel temporary override.

Note:
Gear wheel is now illuminated indicating manual override of set temperature.

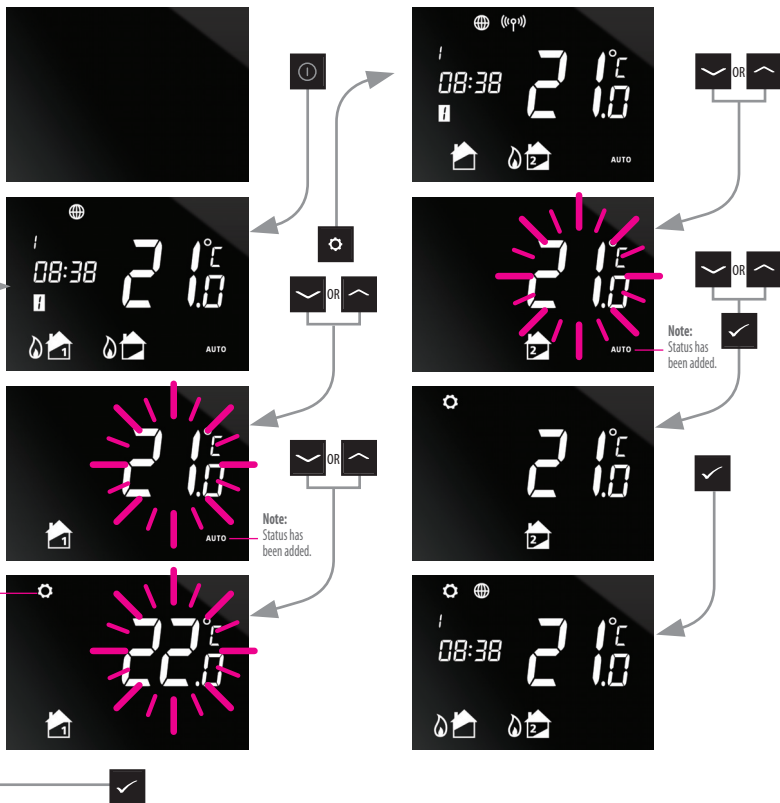

Two Central Heating Zones System Local Control

Switching your heating from AUTO to OFF. Zones 1 and 2.

Press the power button to start and use the buttons indicated to switch from AUTO to OFF.



To go straight to zone two, short press



One Central Heating Zone + Hot Water System PC & Smartphone Control

Now that you have identified your system type, you can use your PC or smartphone to fully control your iT500.



Energy save will use the lowest set temperature on your daily schedule.



Will be displayed when the current program has been manually overridden

AUTO

*Press AUTO to cancel temporary override of program temperature.



3

One central heating zone plus hot water.

HEATING HOT WATER SETTINGS

Thursday | 15/08/2013 | 11:52:00 am

AUTO **ENERGY SAVE** **OFF** **ALL** **S/Z** **INDIVIDUAL**

MON-FRI SAT-SUN

| Program | Time | Temp |
|---------|----------|---------|
| 1 | 7:10 am | 21.0 °C |
| 2 | 9:00 am | 15.0 °C |
| 3 | 10:40 am | 24.0 °C |
| 4 | 12:10 pm | 23.0 °C |
| 5 | 2:50 pm | 17.5 °C |
| 6 | 9:20 pm | 15.0 °C |

CURRENT TEMPERATURE
24.5 °C
HEATING AUTO

Holiday not set
Holiday Start: 14-08-2013 1:38 pm
Holiday End: 14-08-2013 1:38 pm

HOUSE SUMMARY

HEATING AUTO **24.5 °C** Enter Heating

HOT WATER AUTO Enter Hot Water

Home Holiday Settings Back

One Central Heating Zone + Hot Water System PC & Smartphone Control

Follows weekly schedule

Energy save mode

Heating continuously off

AUTO **ENERGY SAVE** **OFF**

CURRENT TEMPERATURE

24.0 °C

HEATING AUTO

Override program temperature*

Change/view weekly heating schedule

Current program

SCHEDULE **WEEKLY DETAIL**

| PROGRAM | TIME | TEMPERATURE |
|---------|----------|-------------|
| 3 | 11:00 AM | 21.0 |
| 4 | 1:00 PM | 14.0 |
| 5 | 4:00 PM | 21.0 |

Home Holiday Settings Back

Follows weekly schedule

Hot water on once

Hot water continuously on

Hot water continuously off

AUTO **ONCE** **CONTINUOUS** **OFF**

HOT WATER OFF

Change/view weekly hot water schedule

Current program

Hot water boost

SCHEDULE **WEEKLY DETAIL**

| PROGRAM | TIME | ON / OFF |
|---------|---------|----------|
| 1 | 7:40 AM | OFF |
| 2 | 9:30 AM | ON |
| 2 | 5:00 PM | OFF |

BOOST 0 Hrs

Home Holiday Settings Back

One Central Heating Zone + Hot Water System Local Control

Temporary override of your temperature and boosting your hot water.

Press the power button to start and use the buttons indicated to change the SET temperature. Then press the tick to accept.



To go straight to hot water, short press



Press to cancel temporary override.

Note:
Gear wheel is now illuminated indicating manual override of set temperature.

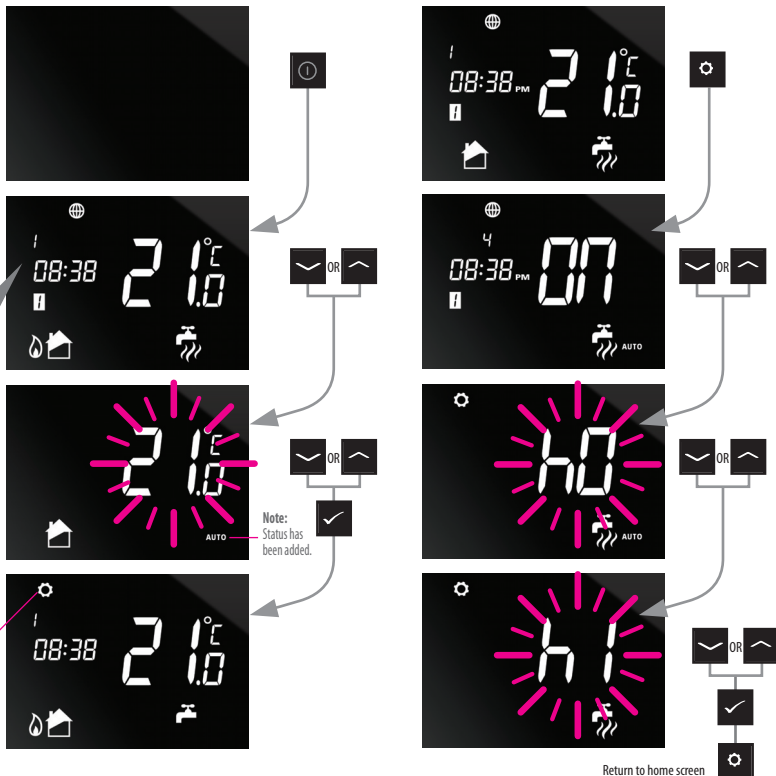

Return to home screen

One Central Heating Zone + Hot Water System Local Control

Switching your heating from AUTO to OFF and overriding hot water AUTO mode.

i
To go straight to hot water, short press

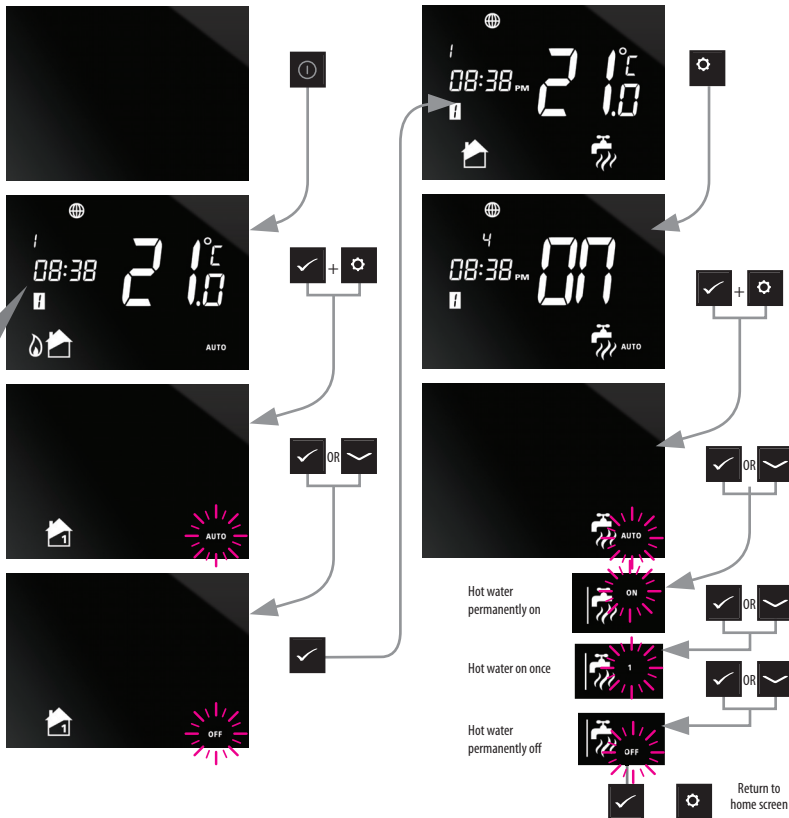

Default Program Schedules

Central Heating

| PROGRAM | WEEKDAY (1 to 5) | WEEKDAY (6 to 7) |
|---------|------------------------------------|------------------------------------|
| 1 | Time 6:00am Setpoint Temp 21°C | Time 6:00am Setpoint Temp 21°C |
| 2 | Time 8:00am Setpoint Temp 14°C | Time 8:00am Setpoint Temp 14°C |
| 3 | Time 11:00am Setpoint Temp 21°C | Time 11:00am Setpoint Temp 21°C |
| 4 | Time 1:00pm Setpoint Temp 14°C | Time 1:00pm Setpoint Temp 14°C |
| 5 | Time 4:00pm Setpoint Temp 21°C | Time 4:00pm Setpoint Temp 21°C |
| 6 | Time 9:00pm Setpoint Temp 14°C | Time 9:00pm Setpoint Temp 14°C |



Your iT500 comes pre-set with these default program schedules. These can be easily changed via the PC or Smartphone App.

Hot Water

| PROGRAM | OP | WEEKDAY (1 to 5) | WEEKDAY (6 to 7) |
|---------|-----------|--------------------|--------------------|
| 1 | ON OFF | 6:00am 8:00am | 6:00am 8:00am |
| 2 | ON OFF | 10:00am 12:00pm | 10:00am 12:00pm |
| 3 | ON OFF | 6:00pm 10:00pm | 6:00pm 10:00pm |

Viewing or changing your program schedule



1

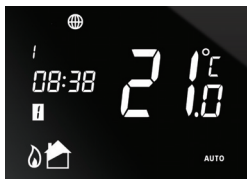

2

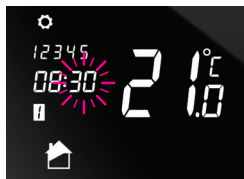

i

At any time press and hold  for 5 seconds to return to the home screen.

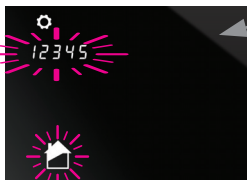

3

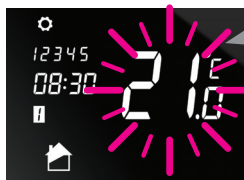

- A 1 2 3 4 5 6 7
- B 1 2 3 4 5 6 7
- C 1-2-3-4-5-6-7

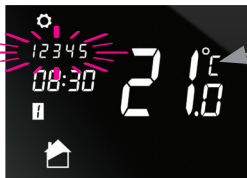

Program for Monday to Friday

1

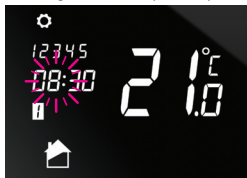

i

Program time and temperature now set for program 1 Monday to Friday. Please continue to program 2 on the next page.

i

Continually pressing  will keep the screen on continually.

- A Program for Monday to Friday and program for Sat/Sun
- B All week programmer
- C Individual day programming

Viewing or changing your program schedule

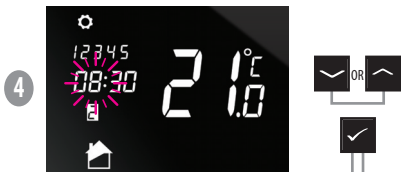

You are now ready to set program 2
Repeat steps 1 2 and 3 for program



Program for Saturday and Sunday

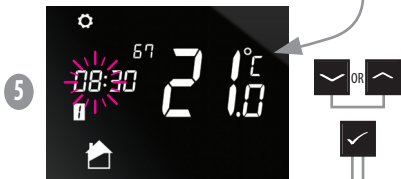

Repeat steps 1 2 and 3 for program

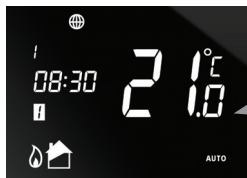

All programs now set



Two zone configuration

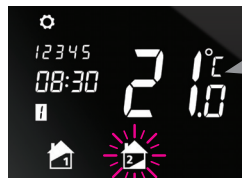
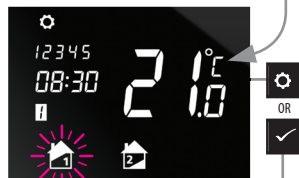
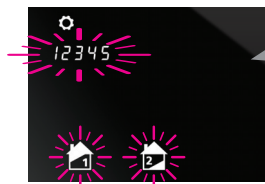
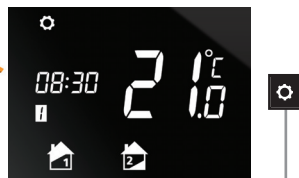

Please follow steps 1 to 5
starting on previous page

Viewing or changing your program schedule



Central heating and hot water

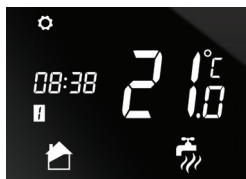

Long press

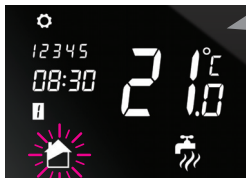

To enter Central Heating program

OR



To select Hot Water program

Follow steps 1 to 5 on previous two pages

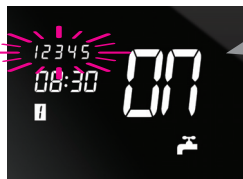

Please follow steps 1 to 5 starting on previous two pages

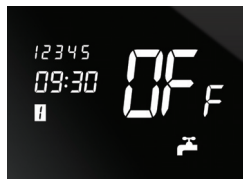

Note: Hot Water has ON and OFF for specific program times rather than temperatures

Program Menu: Setting Time and Date



When connected to the internet, the iT500 will set the time and date automatically. However this can also be set manually.



Long press to enter user settings.



At any time press and hold  for 5 seconds to return to the home screen.

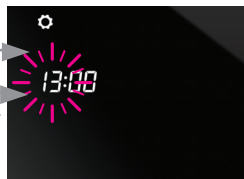
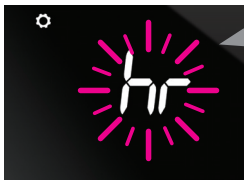
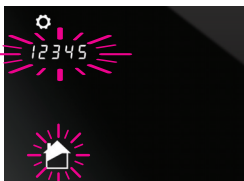
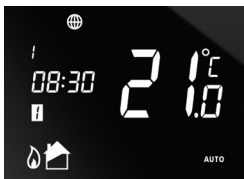

Hour

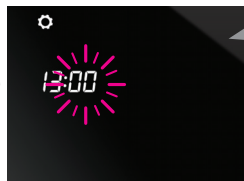

Minute

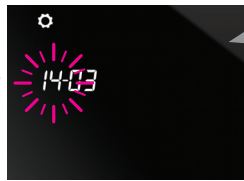

Day



Month

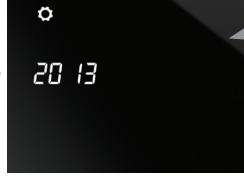

Year

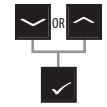
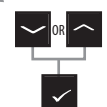
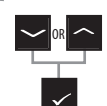
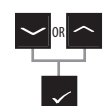
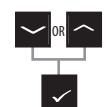

Useful information



You can only activate holiday function via the Web App and Smartphone App.

Exiting Holiday Mode

To exit holiday mode, press and hold the  button.



Cancel Temporary Override

To cancel temporary override of set temperature press and hold 



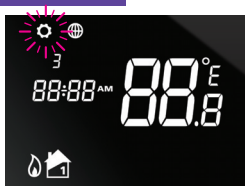

Exiting Energy Mode

To enter or exit energy mode, press and hold the  button.



Lock Function

To enable or disable lock function press  and  together.



SALUS Controls plc

SALUS House

Dodworth Business Park South,

Whinby Road,

Dodworth, Barnsley S75 3SP

UK.

SALES: T: +44 (0) 1226 323961
E: sales@salus-tech.com

TECHNICAL: T: +44 (0) 1226 323961
E: tech@salus-tech.com

www.salus-controls.com



SALUS Controls is a member of the Computime Group

Maintaining a policy of continuous product development SALUS Controls plc reserve the right to change specification, design and materials of products listed in this brochure without prior notice.

Issue Date: Sept 2013