



## Sandringham 21 Countertop Washbasin, 50cm 1 Taphole

### Illustrated

- E8952** Sandringham 21 countertop washbasin 50cm, 1 taphole with overflow, no chainstay hole
- B9868** Sandringham 21 washbasin mixer 1 taphole with pop-up waste
- S8920** Trap 1 1/4" plastic resealing bottle, 75mm seal

### Configuration options

- B9867** Sandringham 21 washbasin mixer 1 taphole
- B9869** Sandringham 21 washbasin mixer 1 taphole with weighted chain & plug waste
- S8722** Waste 1 1/4" brass strainer waste, 80mm slotted tail
- S8737** Waste 1 1/4" brass anti theft waste with captive plug, no chain, 80mm slotted tail
- A5900** TMV Thermostatic mixing valve 15mm
- S8910** Trap 1 1/4" plastic bottle, 75mm seal

### Material

Vitreous China

### Weights

- E8952 7.00KG  
B9868 1.45KG  
S8920 2.00KG

### Colours

White (01)

### Standards

Vitreous china to BS 3402.  
Washbasin to BS EN 14688

### Special Notes

Self-rimming for drop-in installation as per template supplied and joint sealed with waterproof sealant (not supplied).

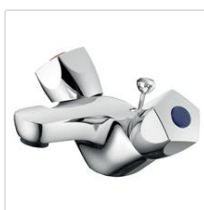
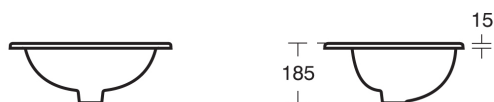
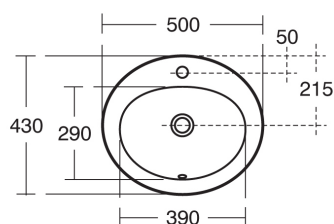

### Frequently used applications

- |                    |                |
|--------------------|----------------|
| Education          | Factory        |
| Hotels             | Office         |
| Public Building    | Pubs and Clubs |
| Residential        | Retail         |
| Sports and Leisure |                |

*Armitage  
Shanks*

Tel: 0870 122 8822  
Fax: 0870 122 8282  
Email: [info@idealspec.co.uk](mailto:info@idealspec.co.uk)  
Web: [www.idealspec.co.uk](http://www.idealspec.co.uk)

Ideal Standard (UK) Ltd. makes every effort to ensure that the information provided on its website is accurate. However, we cannot guarantee this, and accept no liability for any information or advice given via its website.

Powered by  
**Ideal Spec**

Date created: 07/08/2013