

Terrain Waste System

500 Overflow system - for cold, non-pressure water.
Sockets are for solvent-weld jointing

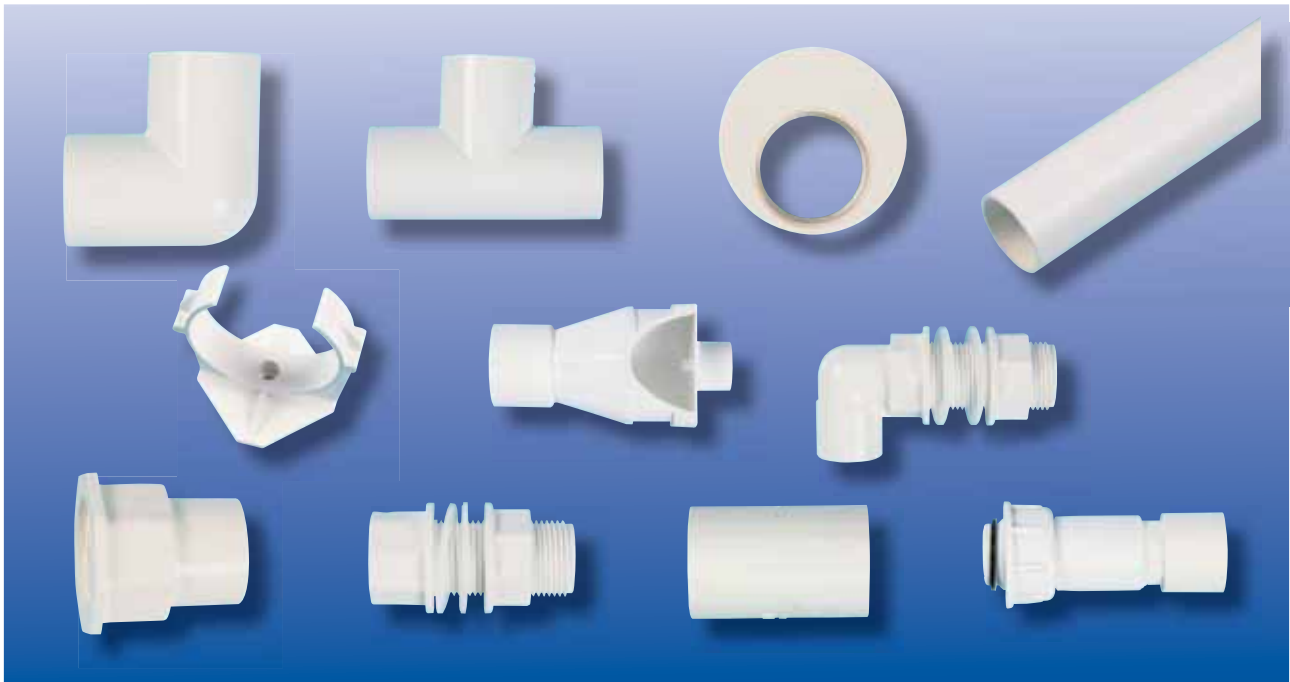

Solvent-weld PVC-u system for cold, non-pressure water:

- 19mm PVC-u pipe and fittings
- Range of tank connectors

19mm pipe and fittings (Fig.5)			
A	B	T1 (min)	T2 (min)
21	19	1.1	2.0

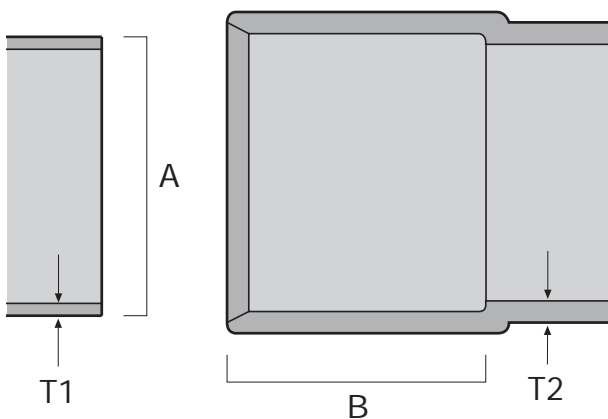
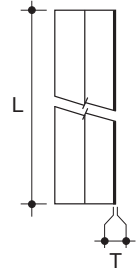

Fig. 6

500 Overflow

Terrain waste system - 500 overflow

Size (mm)	L	T (min)	Colour	Code
OVERFLOW PIPE - plain-ended				
19	4m	1.1	GBW	500.75.40



Size (mm)	L	Z	Colour	Code
STRAIGHT COUPLER DOUBLE SOCKET				
19	40	2	W	510.75

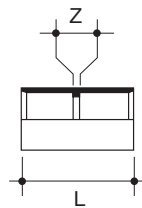

Size (mm)	Angle°	Z1	Z2	Colour	Code
BEND DOUBLE SOCKET - 91¼° and 135° as standard					
19	91¼	12	12	W	501.75.91
19	135	6	6	W	501.75.135

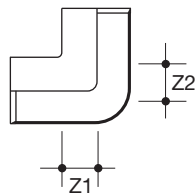

Size (mm)	Angle°	Z1	Z2	Z3	Colour	Code
BRANCH - 91¼° as standard						
19	91¼	13	13	13	W	504.75.91

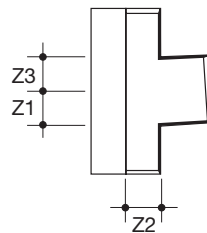

Size (mm)	A	Z	Colour	Code
SOCKET REDUCER				
19/32	5	5	W	524.75

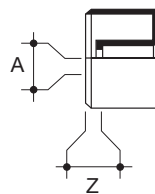

Size (mm)	A	Colour	Code
PIPE FIXING CLIP (PLASTIC)			
19/32	20	W	540.75

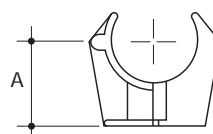

500 Overflow

Terrain waste system - 500 overflow

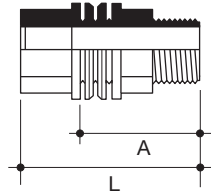

Size (mm)	A	L	Colour	Code
STRAIGHT TANK CONNECTOR - to connect cistern/tank to overflow pipe				
19	48	69	W	511.75

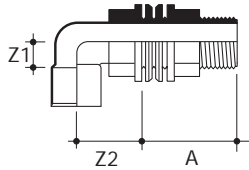
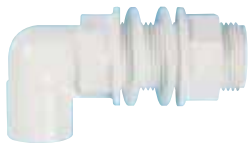

Size (mm)	Angle°	A	Z1	Z2	Colour	Code
BENT TANK CONNECTOR 90°						
19	90	48	13	32	W	502.75.90

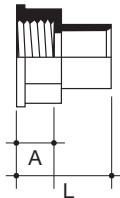

Size (mm)	A	L	Colour	Code
BSP ADAPTOR SOLVENT-WELD SOCKET AND 3/4" BSP SOCKET - to connect PVC-u overflow pipe to threaded components				
19	14	39	W	512.75

Solvent-weld socket to receive overflow pipe. Threaded socket to receive 3/4" BSP male threaded pipe end.

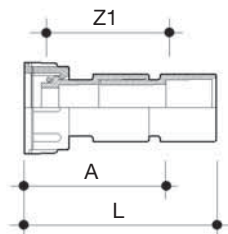

Size (mm)	A	L	Z1	Colour	Code
REVERSE NUT CONNECTOR - to connect PVC-u overflow pipe to threaded components					
19	35	54	25	W	519.75

Threaded loose nut to receive 3/4" BSP male threaded pipe end.

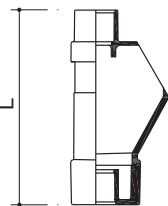

Size (mm)	L	Colour	Code
TUNDISH			
19	117	W	590.75