

20010CP Surface Mounted Bracket for Bar Showers

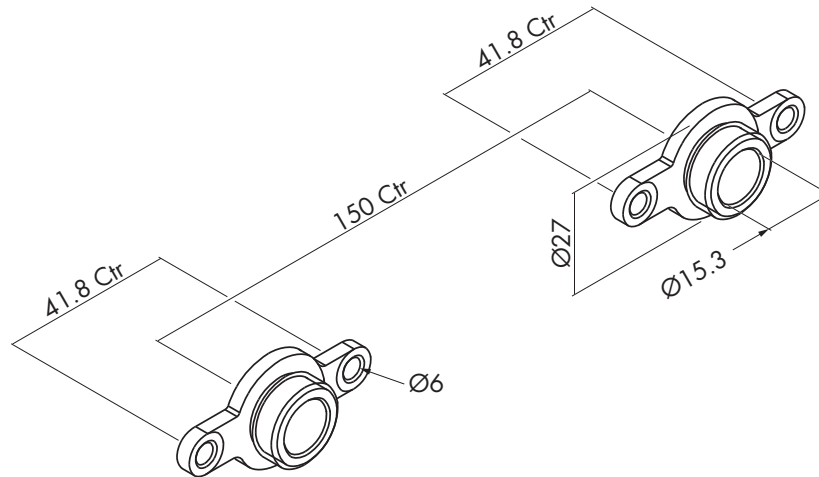

Planning

The brackets are designed for surface mounting on a tiled wall or water resistant surface as part of a cavity or solid wall.

The method of concealing the hot and cold supply pipes and how the mounting brackets are to be mounted should be planned carefully before installation commences.

The installations shown are typical for an interior cavity wall using plaster board mounted on wooden studding and for a chased solid wall.

The bar shower is normally mounted 1.1 to 1.2m above the floor of the shower area but can be mounted higher if required.

Installation - General

Check that all the components are available before commencing installation.

Note: the compression olives are supplied in a separate polythene bag within the package. Ensure they are fitted correctly when making the compression joints.

The brackets should ideally be mounted utilising any support structure in the intended installation area or if unavailable it is recommended that a plywood pad is incorporated into the structure to support the shower valve.

Use plastic wall plugs suitable for securing the brackets to plaster board, these are supplied with the brackets.

We recommend securing the bracket to the wall using counter sunk screws of an appropriate length, which are supplied.

The supply pipes to the brackets can be from below or above to suit site conditions.

Check which is the hot supply to the bar shower when facing the shower, normally hot is on the left hand side.

Finally fit the bar shower to the brackets using the basket filter washers provided with the shower and tighten the retaining nuts to make a water tight joint.

Installation - Existing Cavity Wall

First check that there is no studding to obstruct the installation of the supply pipes from above or below. If there is the only solution is to remove the existing plaster board and replace during the installation.

Unobstructed Cavity

Cut 2 holes in the plaster board 18mm in diameter at 150mm centres at the desired height. Using the wall bracket as a template mark the position of the 2 fixing holes, ensuring the bracket is level.

Drill 2 holes for the fixing screws and fit 2 plastic plugs.

Repeat for the second bracket.

Finish tiling the wall noting the position of the 4 holes and 4 fixing plugs.

Make up 2 supply pipes using a solder elbow as shown and feed them down or up the cavity and guide the ends of the pipes through the 2 holes.

Intatec Limited, Airfield Industrial Estate, Hixon, Staffordshire, ST18 0PF

Tel: 01889 272 180 Fax: 01889 272 181 email: sales@intatec.co.uk web: www.intatec.co.uk

20010CP Surface Mounted Bracket for Bar Showers

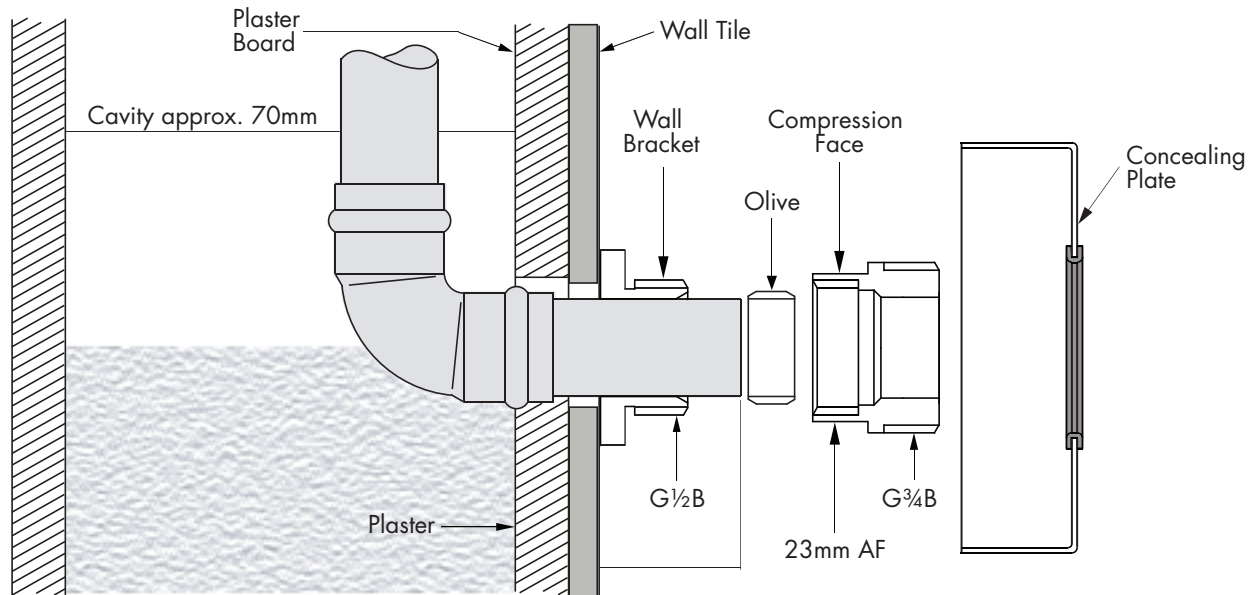

Obstructed Cavity

Remove a section of plaster board and remove the studding or cut holes into it to allow access for the 2 supply pipes. If cutting holes do so above where the shower will be installed allowing for 150mm pipe centres.

Make up 2 supply pipes using a solder elbow as shown.

Cut 2 holes in the plaster board 18mm in diameter at 150mm centres, mark the position and drill the 4 fixing holes.

Fix the new plaster board to the studding then finish and tile the wall noting the position of the 4 fixing plugs.

Fitting the Brackets

Apply silicone sealer to the back of both wall brackets, fit to the 2 protruding copper pipes, press to the wall and secure both brackets with 2 counter sunk screws.

Add the olives and then the compression faces and tighten until the seals are made.

Apply a bead of silicone sealer around the inside edge of the concealing plates, position over the compression faces and press firmly to the wall.

Fit the bar shower using the basket filter washers, turn on the water supplies and check that all joints are water tight.

Installation - Solid wall

Chase two channels into the wall for the two supply pipes at 150mm centres, ensuring that the pipes and bends are fully embedded.

Using the wall bracket as a template mark the position of the 2 fixing holes as shown, ensuring the bracket is level.

Drill 2 holes for the fixing screws and fit 2 plastic plugs.

Repeat for the second bracket.

Fill the pipe channels and finish plastering the wall, the copper pipe must protrude from the finished tiled wall by between 22 to 27mm.

Finish tiling the wall noting the position of the 4 fixing plugs.

Follow Fitting the Brackets procedure detailed previously.

Aftercare

To maintain the appearance of the bracket periodically it should be cleaned with a soft damp cloth and a mild detergent before rinsing.