

Mild Steel and Stainless Steel Backrest Rails



Projection Shower Seat

The 150mm backrest rail is designed to be used with the 650mm projection shower seat.

[Turn to page 68](#)

35mm Mild Steel Stainless Steel

- Stainless Steel for use in wet or damp areas. Mild Steel for use in dry areas.
- 35mm tube diameter for superior strength and confidence.
- Strong tubular construction with robust welded flanges for lasting strength and performance.
- Available in polyester coated, chrome plated, mirror polished and sateen polished finishes. Please specify the RAL colour you require when ordering colours.
- Fixing holes to fit size 8 screws. (Fixings not supplied)

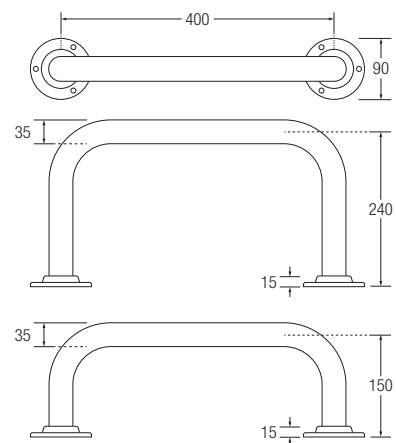

Concealed Fixings

Backrests with concealed fixings are available as part of our Professional range.

[Turn to page 44](#)

35mm Backrest Rail

			White	Blue RAL 5011	RAL Colour	Chrome Plate	Mirror Polish	Sateen Polish
35mm	MS	400mm x 150mm	48755	48760	48765	48750	NA	NA
35mm	MS	400mm x 240mm	48605	48606	48609	48505	NA	NA
35mm	SS	400mm x 150mm	49060	49065	49070	NA	49050	49055
35mm	SS	400mm x 240mm	49200	49210	49220	NA	49100	49110

Backrest Cushion



White



Blue RAL 5011

FOAM CUSHION	49702	49703
--------------	-------	-------

- Water resistant foam.
- 365mm x 160mm x 50mm.
- Available in White or Blue RAL 5011.



Cushions are fixed onto the backrest rail using two bolt on brackets supplied.