

Geberit Type 290 flush valve d40, dual flush

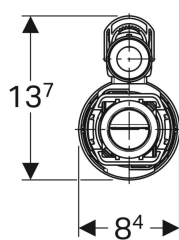

Example image

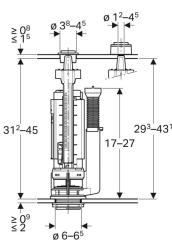

Application purposes

- For ceramic cisterns with drilling \varnothing 40 mm
- For potable water
- For greywater (rainwater) with pH value 6.0–9.5, if a filter system is used

Characteristics

- Dual flush
- Height-adjustable

- Small and large flush volume can be set depending on the amount of water in the cistern
- Overflow pipe height-adjustable
- With lid attachment
- Suitable for basket, for Type 280 flush valve
- Suitable for basket, for Type 250 flush valve (Twico 1)

Technical data

Maximum storage temperature	40 °C
Maximum operating temperature, water	25 °C
Actuation force	18 N

Scope of delivery

- Fastening material

Art. no.	Colour / surface	H
282.350.21.2	gloss chrome-plated	32 cm